

MASS I VOID

LIMES celebrates spaces which are carved and embedded. The act of doing so provides a much stronger connection of building and landscape. An initial large mass of stone has transformed into a landscape with punctures and voids.

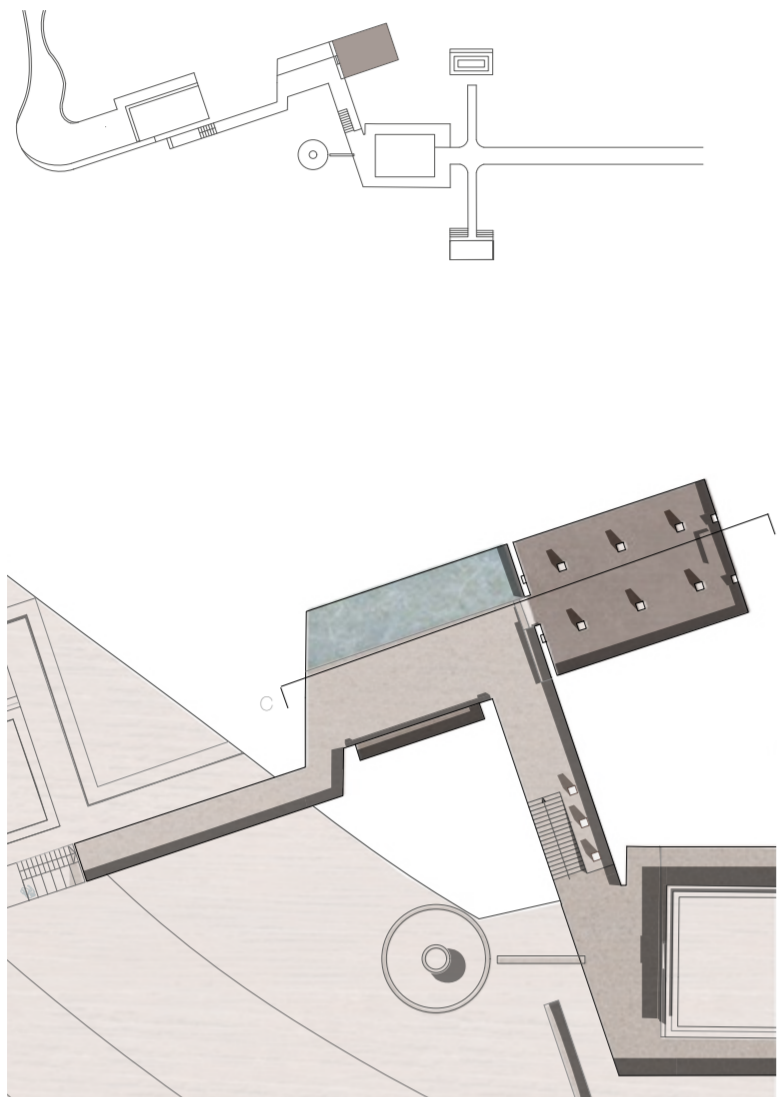

B2 Long Section
1:500

COMMUNAL SPACE

Areas where worshippers and travellers can collectively meet are just as essential as the intimate and more isolated moments. LIMES depicts a series of these in the form of courtyards as the larger open spaces frame the interior rooms.



B2 perspective Section C-C
1:100



A large body of water welcomes visitors from the narrow passage into a communal rest area. This is where b2, a semi-interior exhibition space is located. The cross formation of the openings is once again a celebration of the cross motif. It also enhances the lighting conditions on the interior. The podiums are intentionally places where columns would be found in a 'more traditional' design. The typology of this room is similar to Abba Libanos where the front façade is exposed.

