

# URBAN POLICY IN URBAN COURTYARD

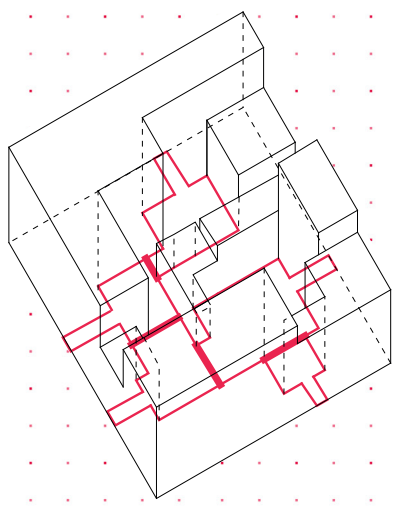

1. STATE OF ART

Urban courtyards divided by property walls

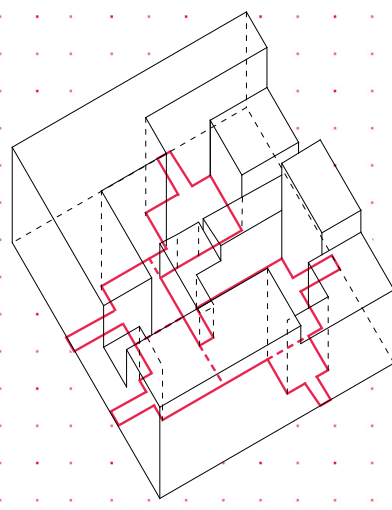

2. LINK THE COURTYARDS

Rethink the dividing walls between the courtyards to create possible paths and connections

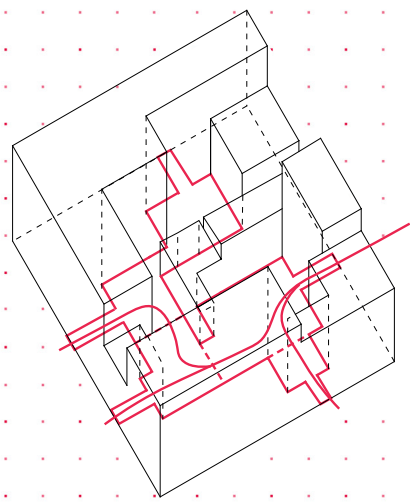

3. DEFINITION OF FLOWS

Connect courtyards through paths generate different flows inside the block

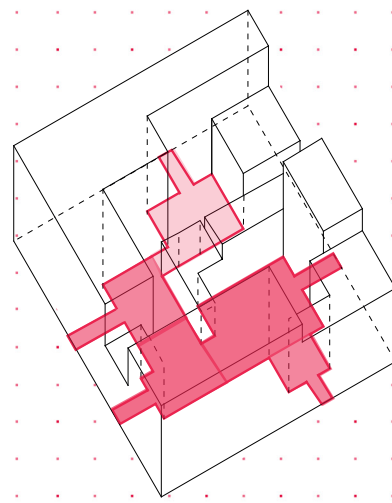

4. GRADIENDT OF PUBLICNESS

The pedestrian flows determine gradient of publicness in the system of urban courtyards.

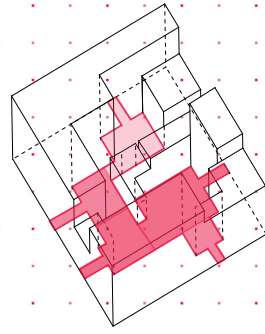

GRADIENT



PUBLIC



SEMI-PUBLIC



PUBLIC/COLLECTIVE

WALL

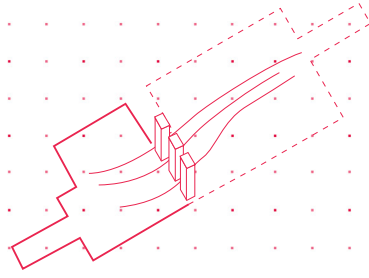

> PHYSICALLY PERMEABLE  
> VISUALLY PERMEABLE

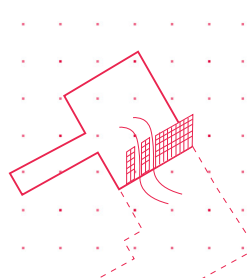

< PHYSICALLY PERMEABLE  
> VISUALLY PERMEABLE

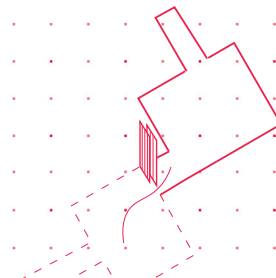

< PHYSICALLY PERMEABLE  
> VISUALLY PERMEABLE

SURFACE

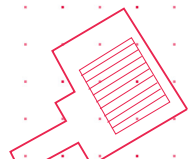

> IMPERMEABLE SURFACE  
< PERMEABLE SURFACE

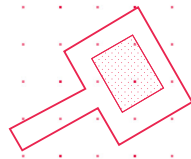

< IMPERMEABLE SURFACE  
> PERMEABLE SURFACE

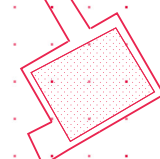

> PERMEABLE SURFACE

GROUND FLOOR

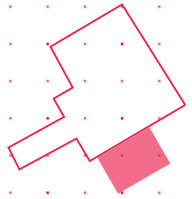

PRODUCTIVE SERVICES ( shops, bar and restaurant, galleries)  
SOCIAL SERVICES ( clinics, study and co-working spaces)

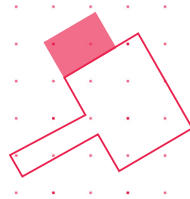

SOCIAL SERVICES ( laundry, sharing kitchen)  
RECREATIONAL SERVICES ( children and elderly center)

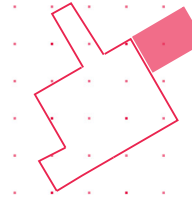

SOCIAL SERVICES ( laundry sharing kitchen)  
RECREATIONAL SERVICES ( children and elderly center)