

RED FRAGMENTS: A new dialogue between interiors and exteriors of Santi Cosma and Damiano former convent

Artist-in-residence at Bevilacqua La Masa Foundation in Giudecca island, Venice

Location of Giudecca

Giudecca, as the largest and closest island to Venice, lies immediately south of the central islands of Venice, stretching out to the east and west. It was originally called "Spina Longa", due to its narrow and wide shape, similar with a fishbone. Giudecca consists of a complex of 10 smaller interconnected islands and 9 canals, connected to the historic center of Venice by the San Marco basin, separated by the broad and deep Giudecca Canal.

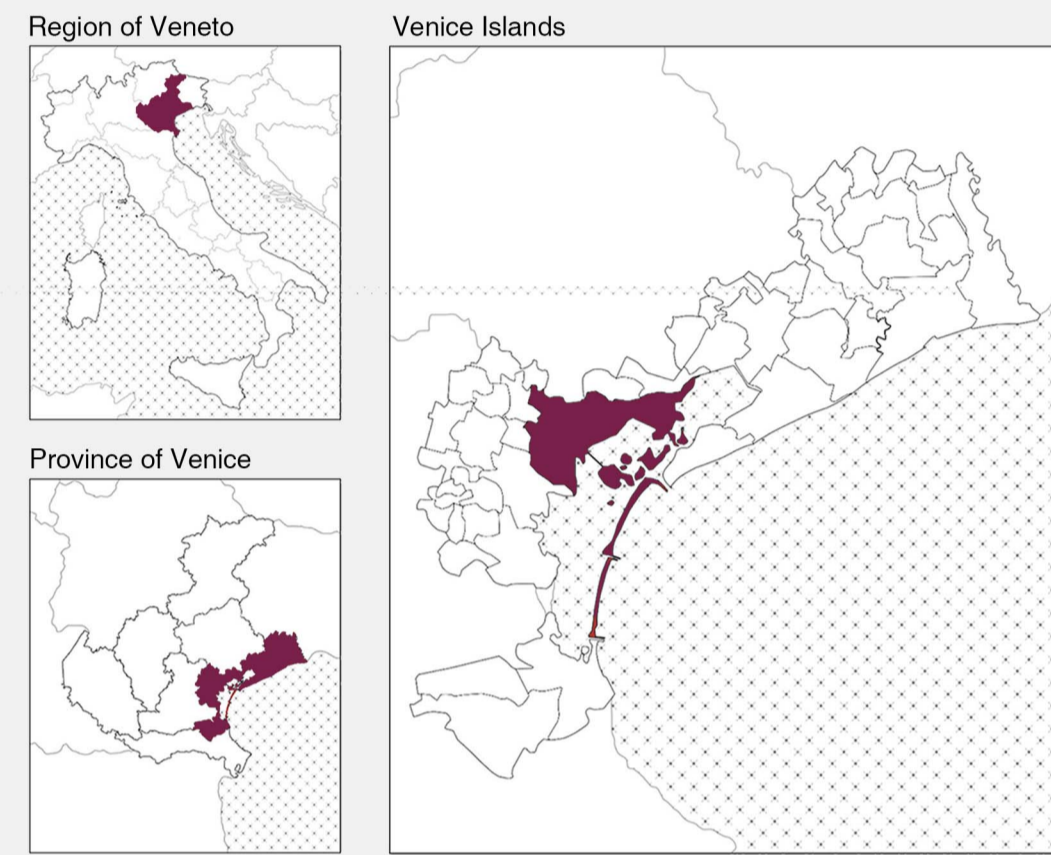

Accessibility of Giudecca

Giudecca is connected with city center of Venice with the public transport system Vaporetto, translated as the water bus. Five water bus stops are located on Giudecca uniformly from the west to the east, with multiple routes and frequent schedules, making it quite easy to reach from the city center.

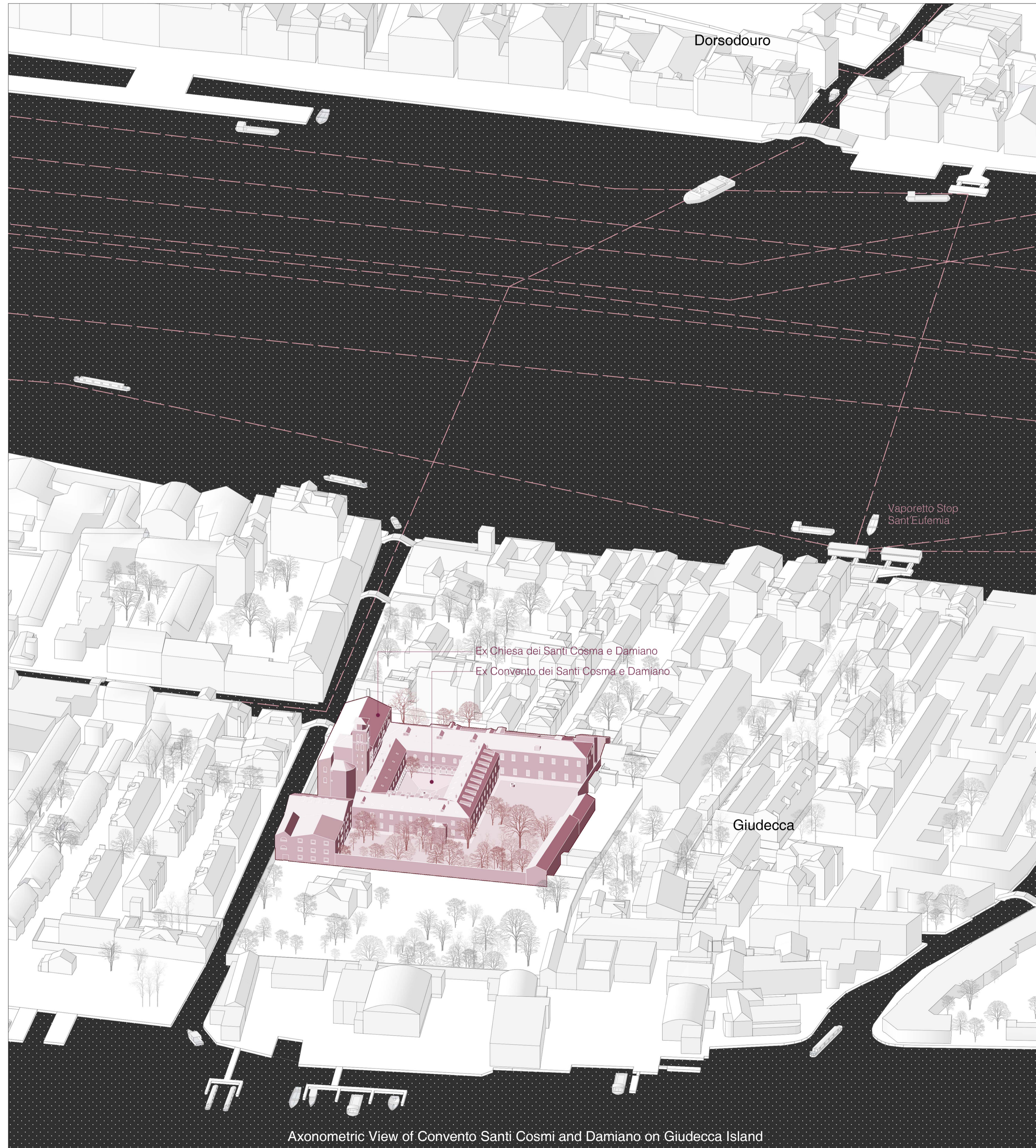
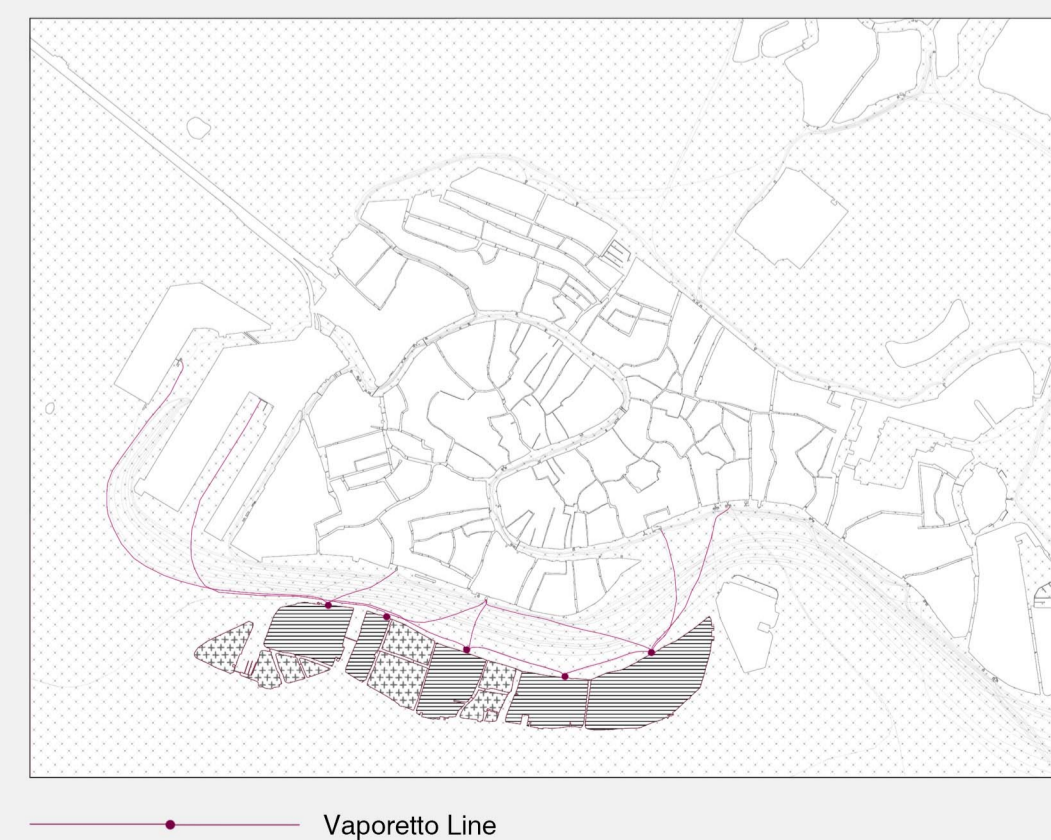

Morphological Patterns

The morphological patterns of Giudecca, at first glance, reveals two recognizable heterogeneous scales from the north to the south—a compact linear structure mainly composed of residential areas to the north, a sparse, fragile and inconsistent structure of disused industrial districts as well as gardens to the south.

Figure and Ground



Three types of morphological pattern may be distinguished.

- Pattern 1 : Linear, "Comb-form"
 - a) a compact, linear development along the Fondamenta in the north.
 - b) a less dense fabric to the south.
- Pattern 2 : Less dense, green space, enclosed units
 - a) consists of a less dense structure.
 - b) loose and shaped by both built and unbuilt landscapes.
 - h) Enclaves, enclosed units like former monasteries or industrial estates.
- Pattern 3 : Deserted
 - a) remains undeveloped and vacant.
 - b) This green strip is only partly cultivated and makes up the only 'natural' terrain along the lagoon.

Pattern 1

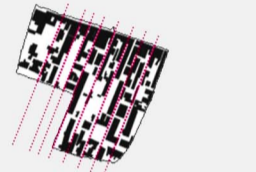

Pattern 2

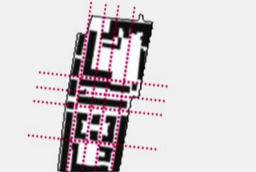

Pattern 3



Density Level



Types of morphological patterns

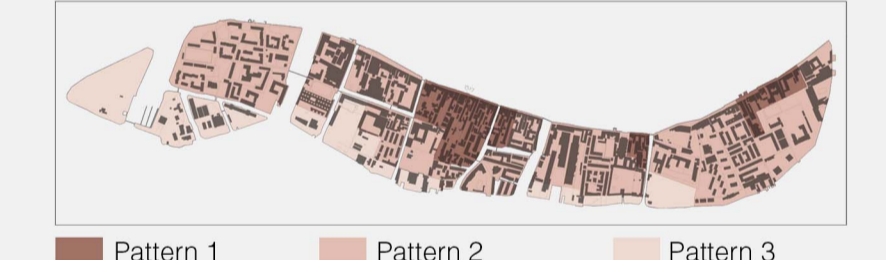

Site Analysis of Giudecca

Transportation Structure



Land Use



General Access to Green Spaces

