

Stair (with middle stringer)

- 7mm Interface Carpet Tile installed on treads;
- Tackifier Adhesive sprayed on treads;
- 20mm thick treads welded to the risers;
- 20mm thick aluminium industrial treads welded to the risers;
- 10mm thick aluminium risers welded to the stringer;
- 50mm thick stringer (middle support) welded to secondary beam.

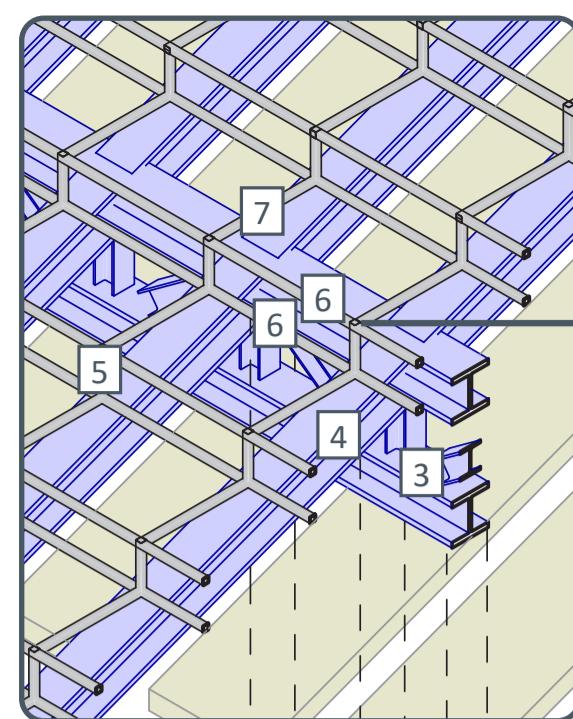

Sub-Structure for Audience Seating

- 40x40mm hollow box horizontal bars welded to join rows;
- 40x40mm hollow box horizontal bars welded to verticals;
- 40x40mm hollow box vertical bars welded to secondary beams. (secondary beams are 1000mm apart)

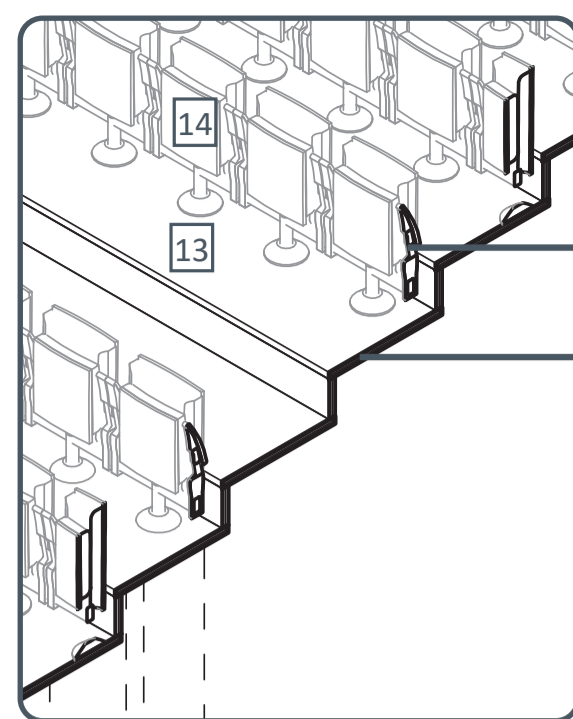

Minispace 5071 by Figueras Seating

- Carpeted Audience Floor (cut-outs for air diffusers grills and lighting fixtures to be added)
- 7mm Interface Carpet Tile monolithic installation excess cut;
- CQuest™Bio backing with 3mm closed-cell polymerised foam;
- Tackifier Adhesive sprayed on backingboard;
- 20mm Plywood as backingboard screwed on plywood;
- 20mm Plywood screwed to the sub-structure for seating.

SPECIAL ZONE:
THE AUDITORIUM

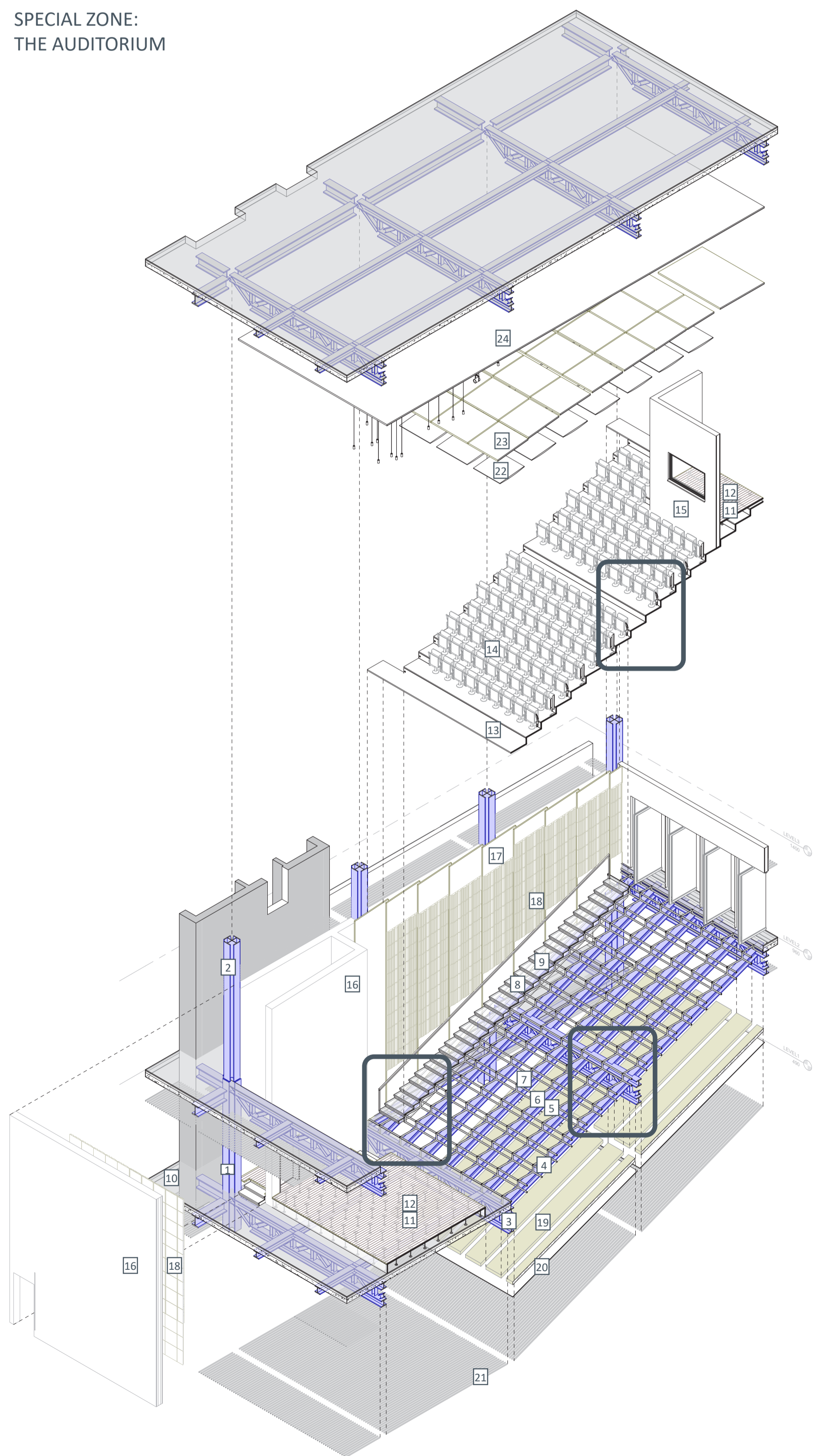

CONNECTION between the truss top chord & the angled secondary beams

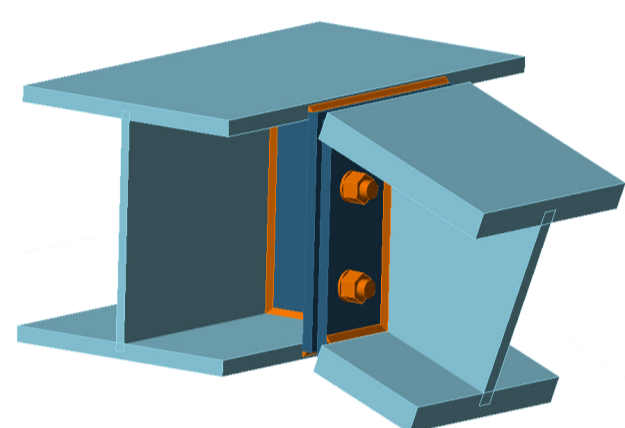

- 24 Gypsum Panel (ceiling)
- 23 Suspended Plywood Panel
- 22 Acoustic Panel
- 21 Suspended Batten Ceiling
- 20 Gypsum Panel (ceiling)
- 19 Fiberglass Insulation
- 18 Sound Diffuser Panels
- 17 Angled Plywood Panels
- 16 Auditorium Wall
- 15 2hr-Rated GWB Partition Wall
- 14 Audience Seating
- 13 Carpeted Audience Floor
- 12 Raised Floor
- 11 Adjustable Floor Pedestal
- 10 Typical Floor Slab
- 9 Stair Tread and Risers
- 8 Stair Stringer (mid-support)
- 7 4x4 Hollow Box Horizontal Bar
- 6 4x4 Hollow Box Horizontal Bar
- 5 4x4 Hollow Box Vertical Bar
- 4 HEM240 Secondary Beam
- 3 Truss Beam (HEB240 chords, HEB140 webs)
- 2 King Cross HEB500 Column
- 1 King Cross HEB600 Column

DISPLACEMENT - RESULTANT (SLS)
under only Dead Load (DL)

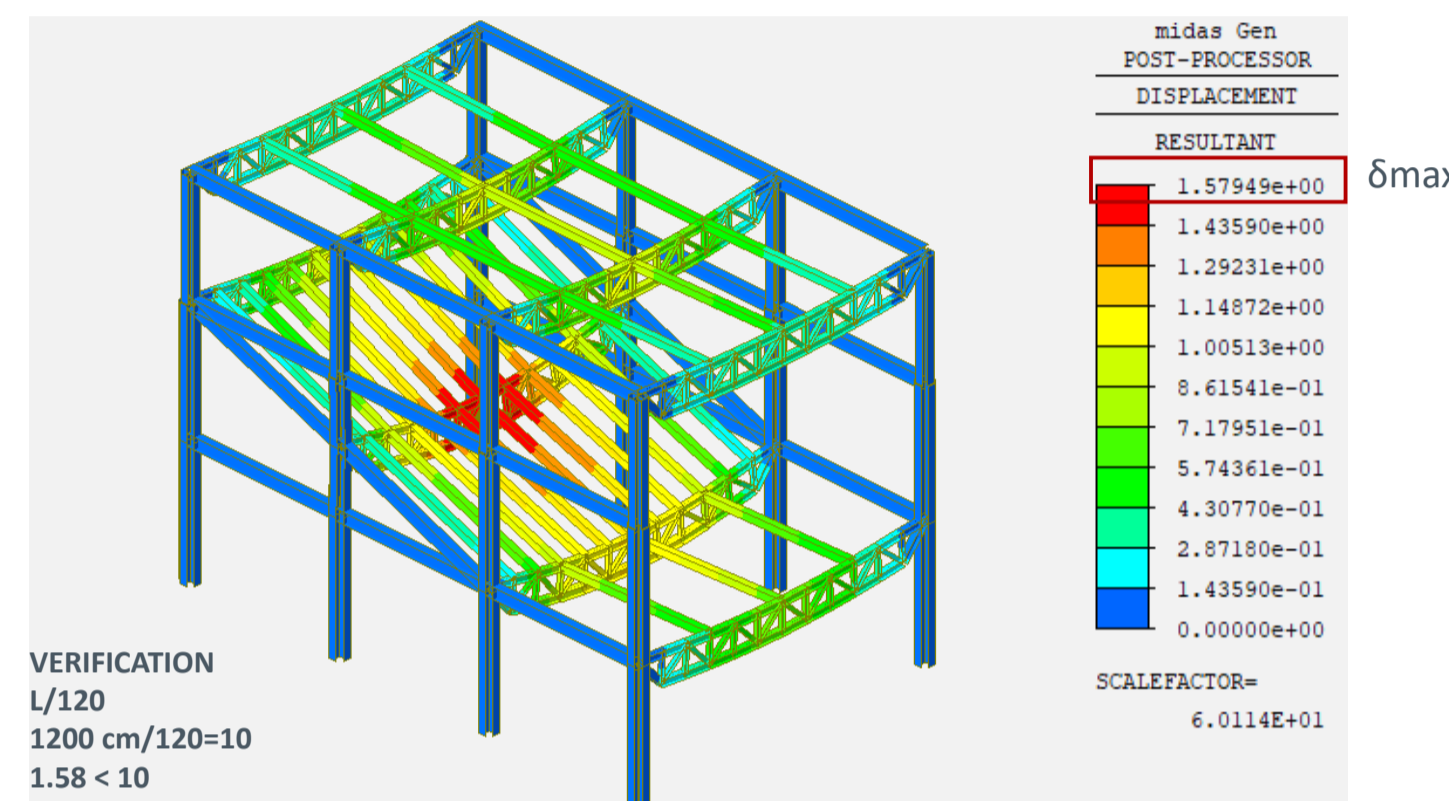

DISPLACEMENT - RESULTANT (SLS)
under only Live Load (LL)

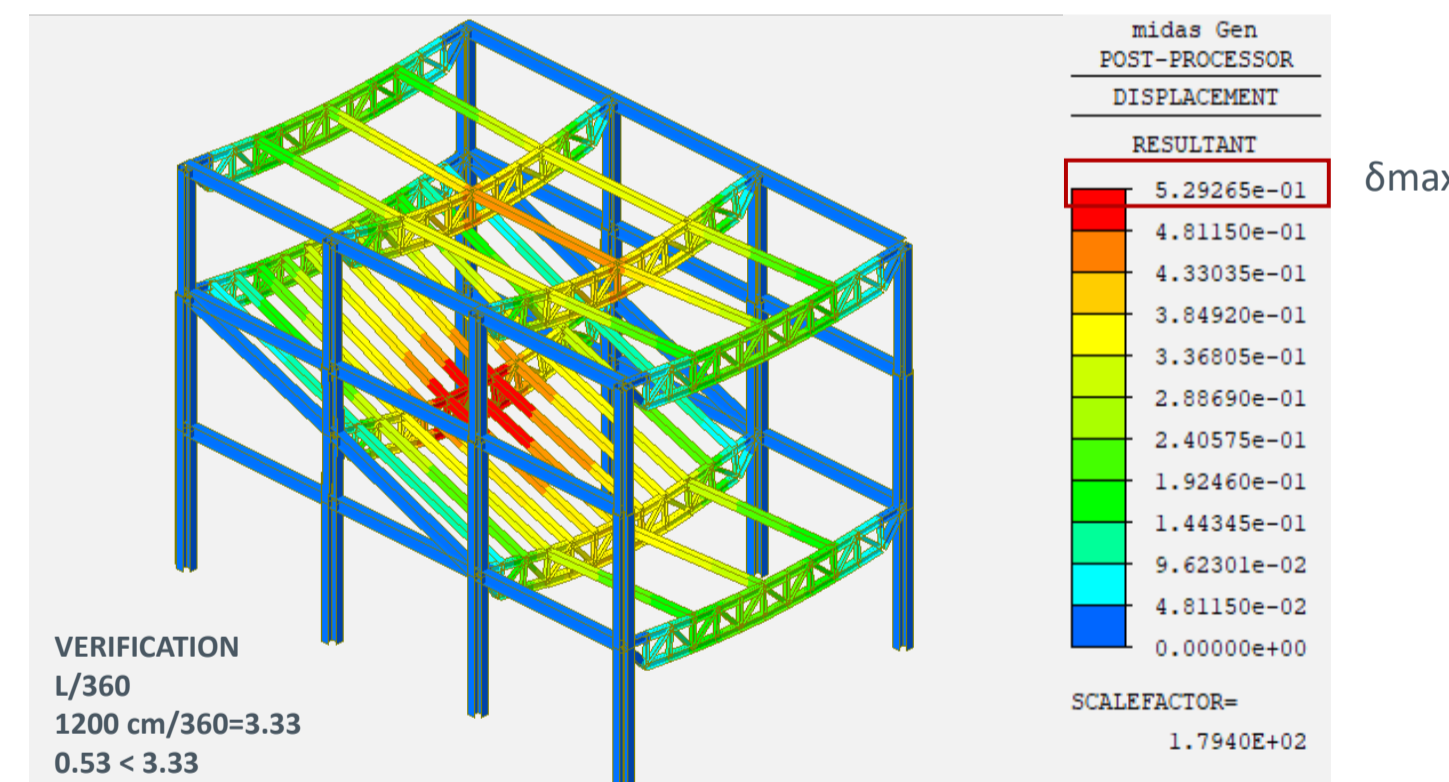

DISPLACEMENT - RESULTANT (SLS)
under Dead Load (DL) and Live Load (LL)

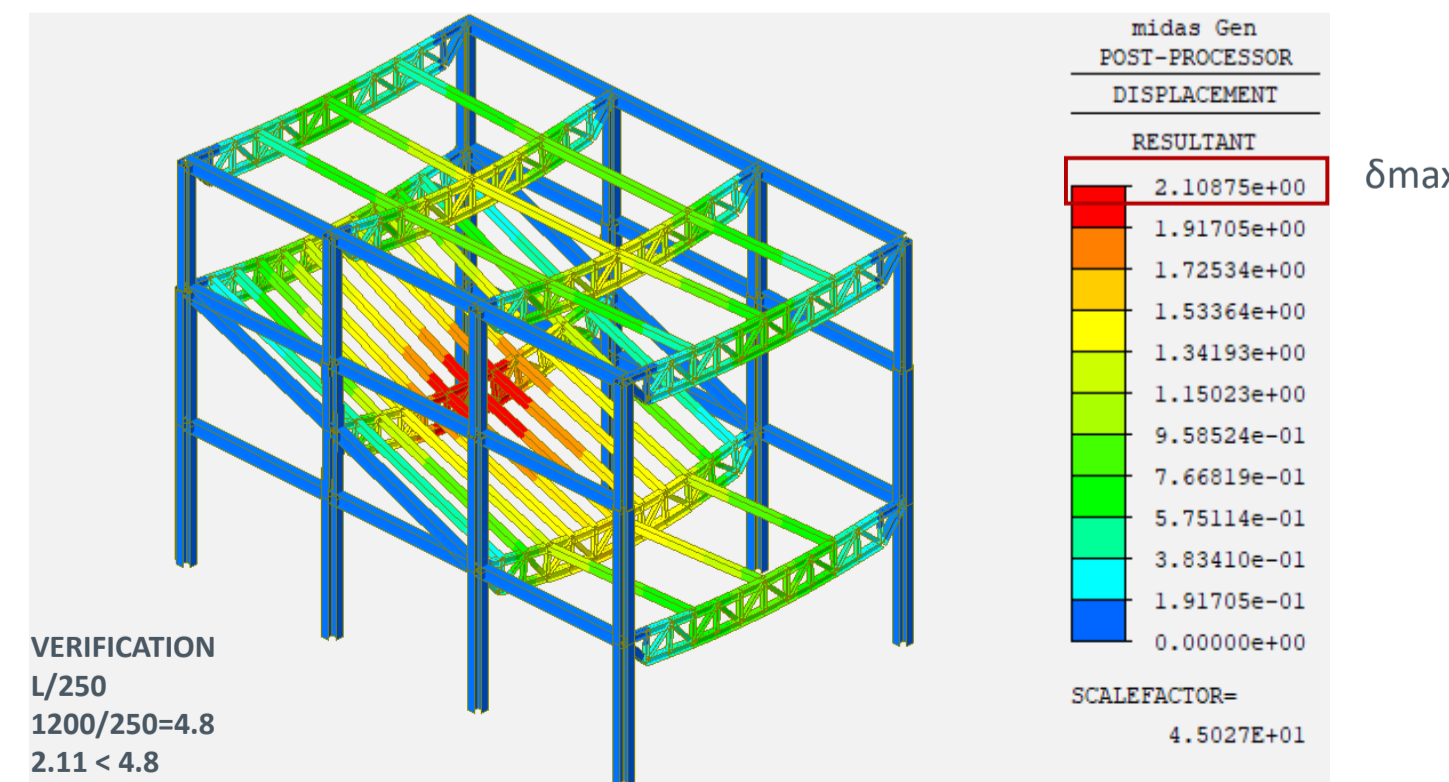

DEFINITION OF LOAD CASES

- SLS: 1.00*DL+1.00*LL
- ULS: 1.35*DL+1.50*LL

Steel Code Checking Result Ratio. (Combined)

HEB140

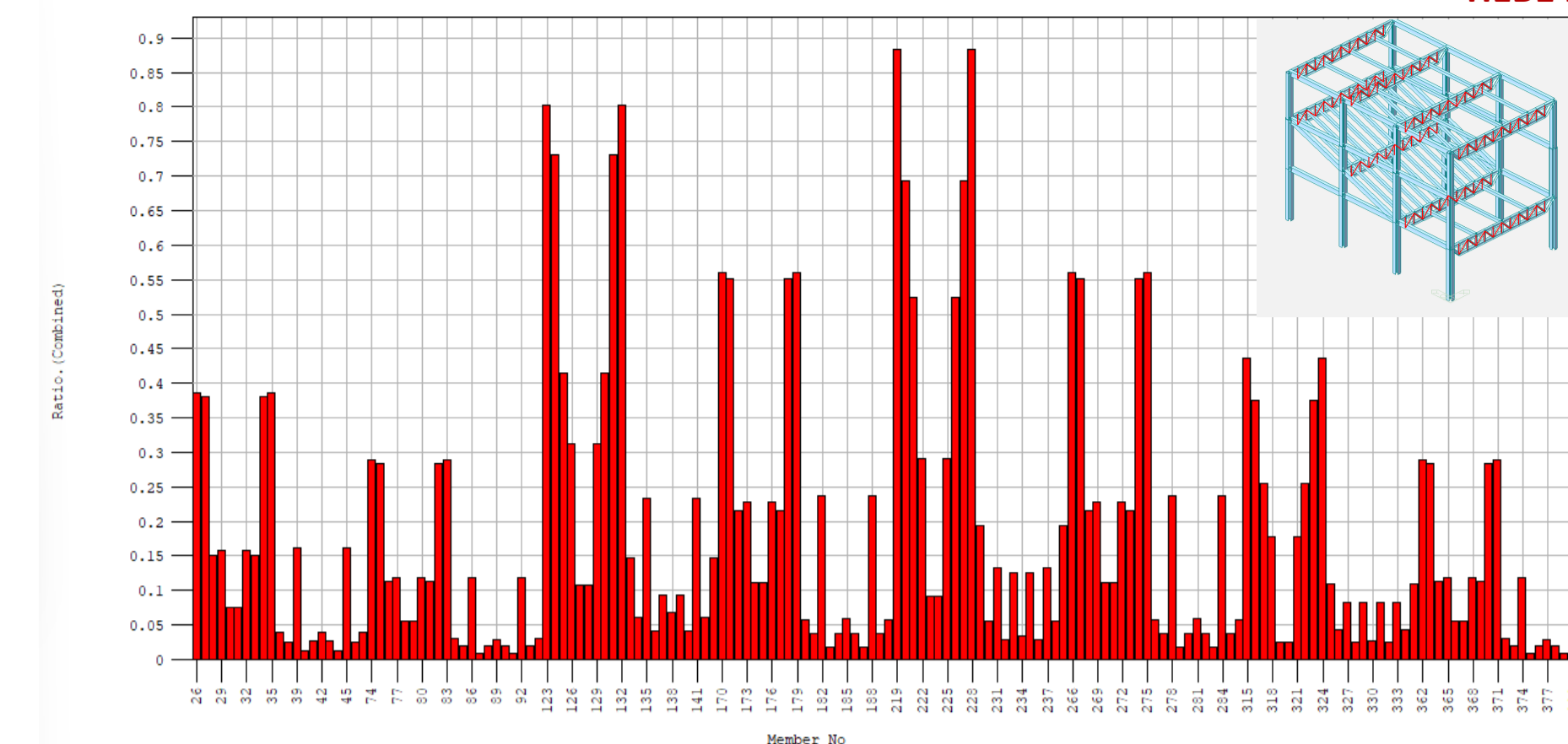

Steel Code Checking Result Ratio. (Combined)

HEB240

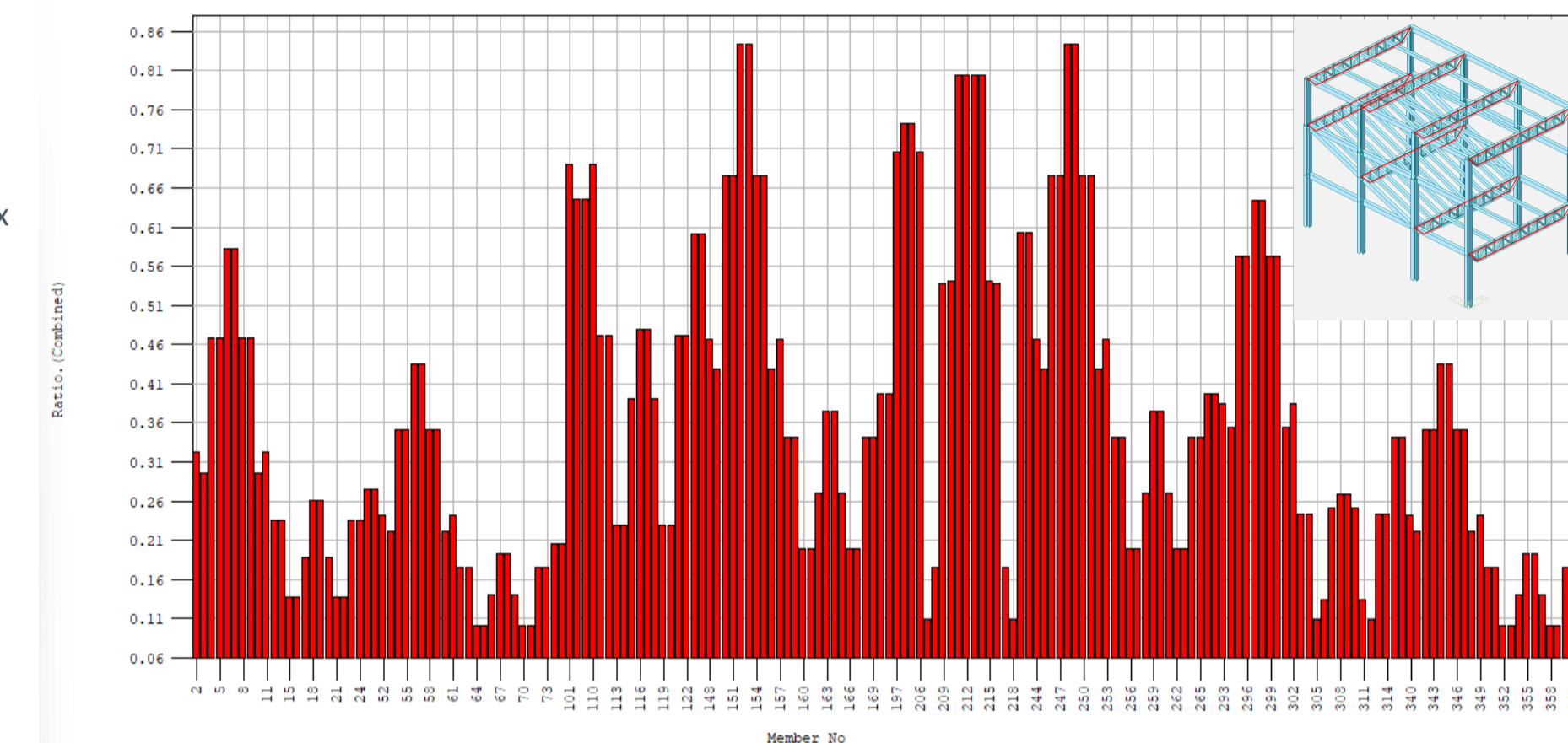

Steel Code Checking Result Ratio. (Combined)

HEB280

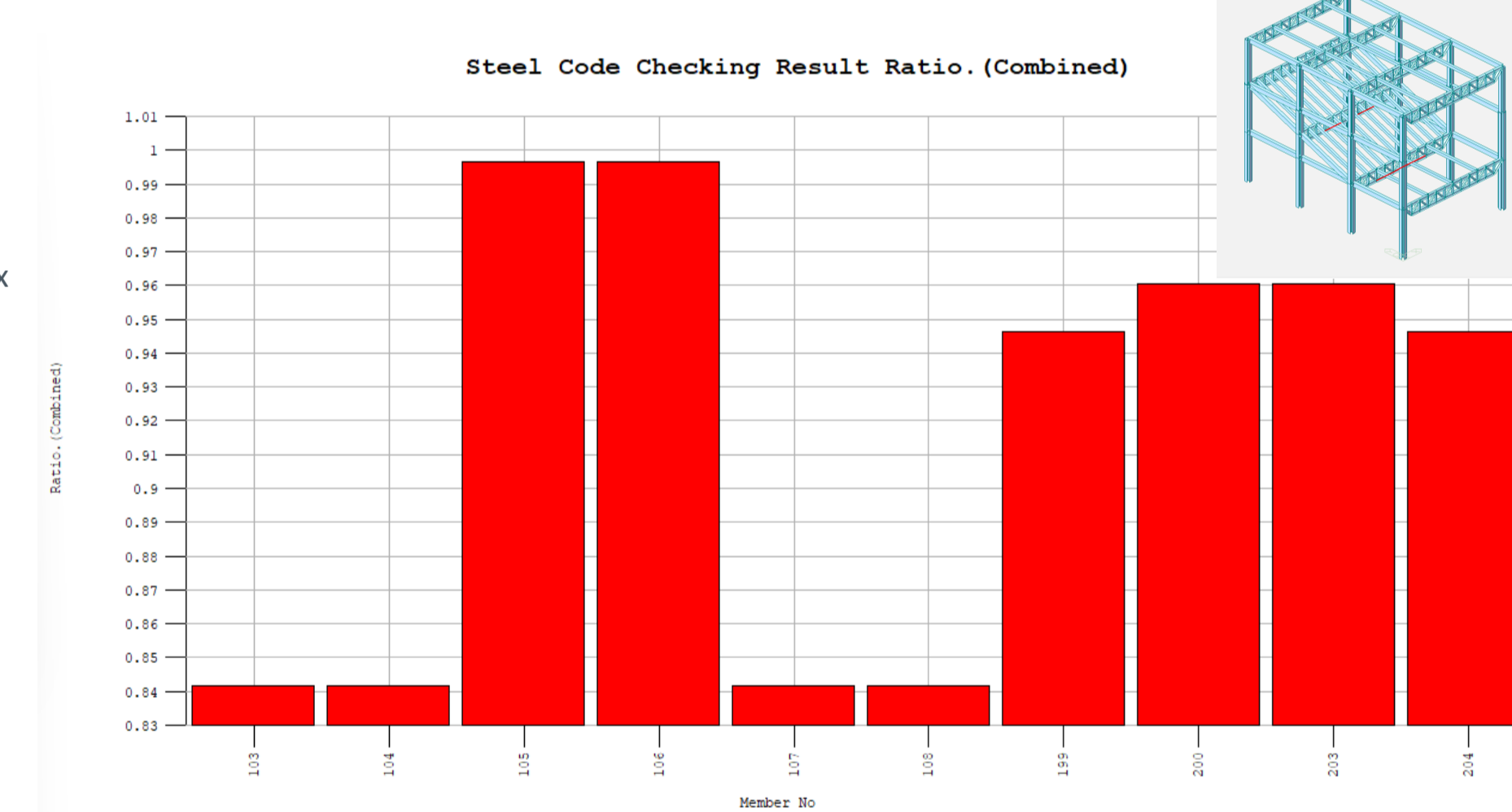

Steel Code Checking Result Ratio. (Combined)

ALL ELEMENTS

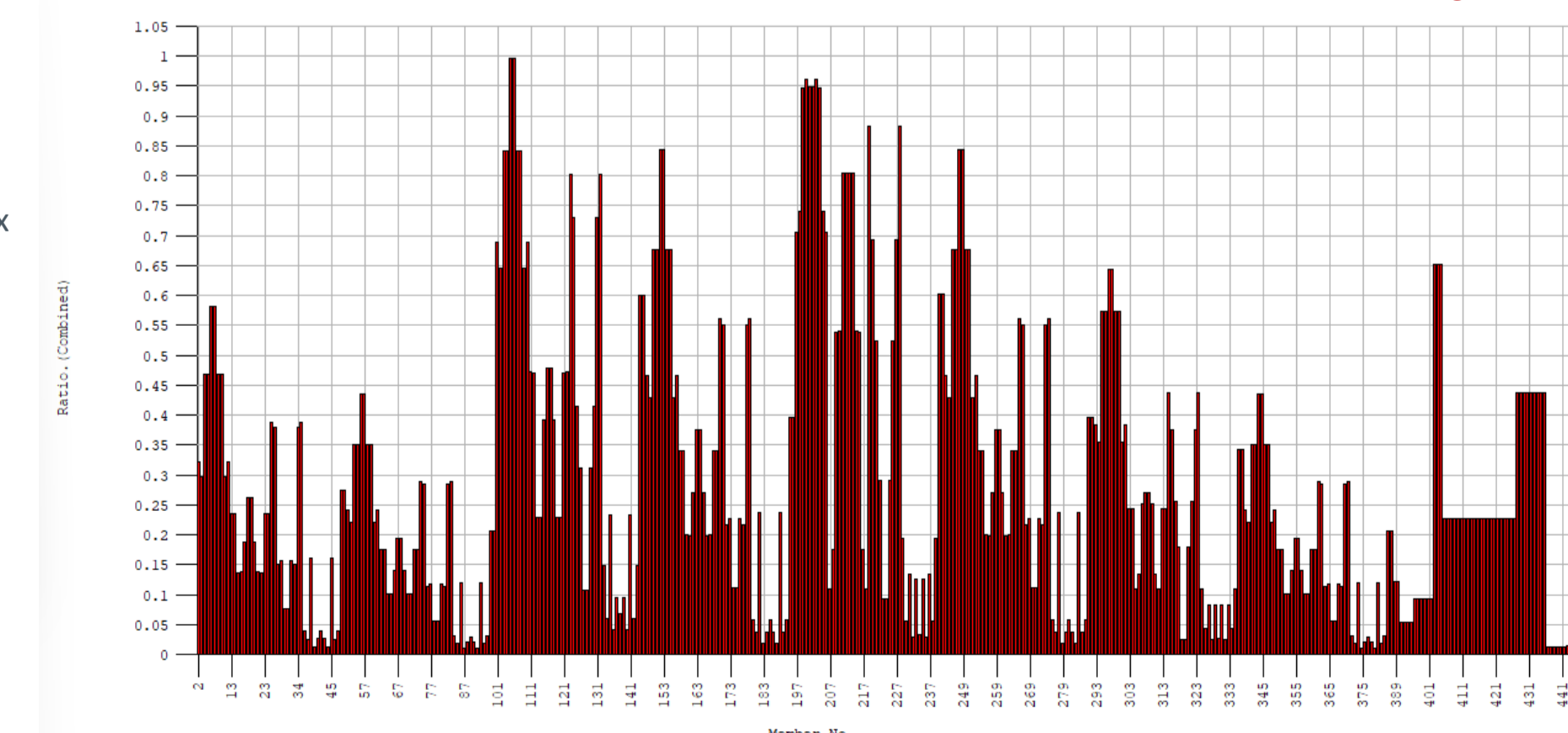

21

Drawing 21
STRUCTURAL DESIGN
Scale: n/a

TOWER OF BOOKS:
The New European Library of Information and Culture

Authors: Sude Rencber, Altyn Yermukhanova, Nikola Krsmanovic
Supervisor: Maria Grazia Folli
Academic Year: 2022-2023