

## POPULATION DISTRIBUTION

## INTERPRETATION OF OFFICIAL DOCUMENTS OF THE MINISTRY OF HEALTH

- Primary care services provided through multi-professional teams (GPs, PLS, SAI, IFeC, etc.)
- Single point of access
- Basic home care service
- Outpatient specialist services for high prevalence diseases
- Nursing services
- Integrated booking system connected to the company CUP
- Integration with Social Services
- Community participation and enhancement of co-production
- Connection with the Community House of reference hub
- Medical presence
- Nursing presence
- Basic diagnostic services
- Continuity of care
- Withdrawal point
- Services for mental health, pathological addictions and child and adolescent neuropsychiatry
- Sports medicine
- Consultation Activities
- Screening programs
- Vaccinations

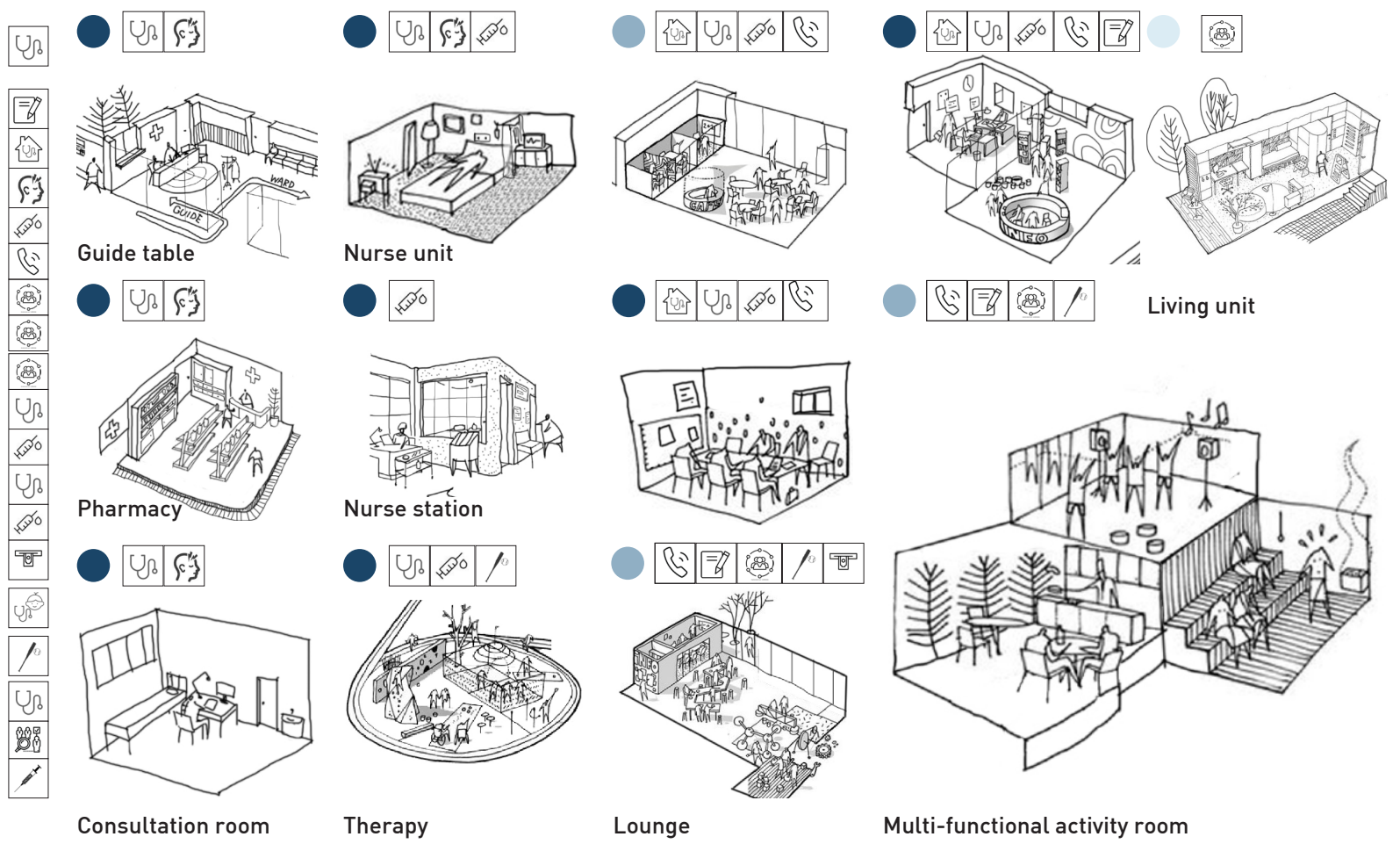

## MEDICAL SPACE ANALYSIS

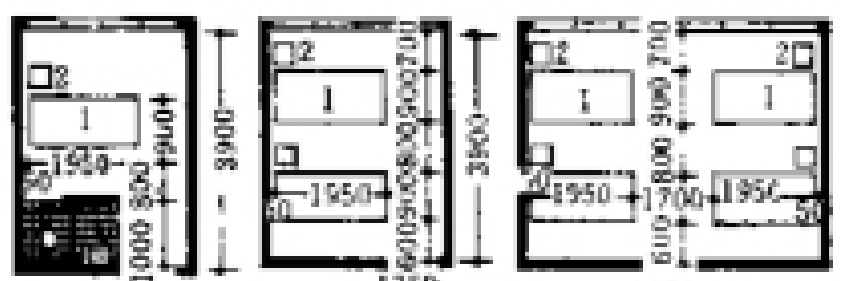

Wards



Therapy space



Service space



Pharmacy: Avoid direct sunlight and keep it dry and ventilated.

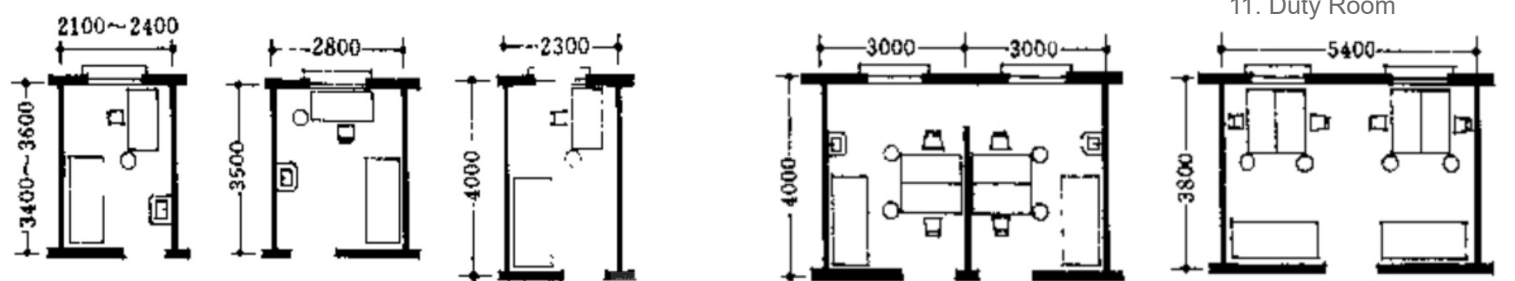

Consultation Room: Used by doctors when consulting a patient.

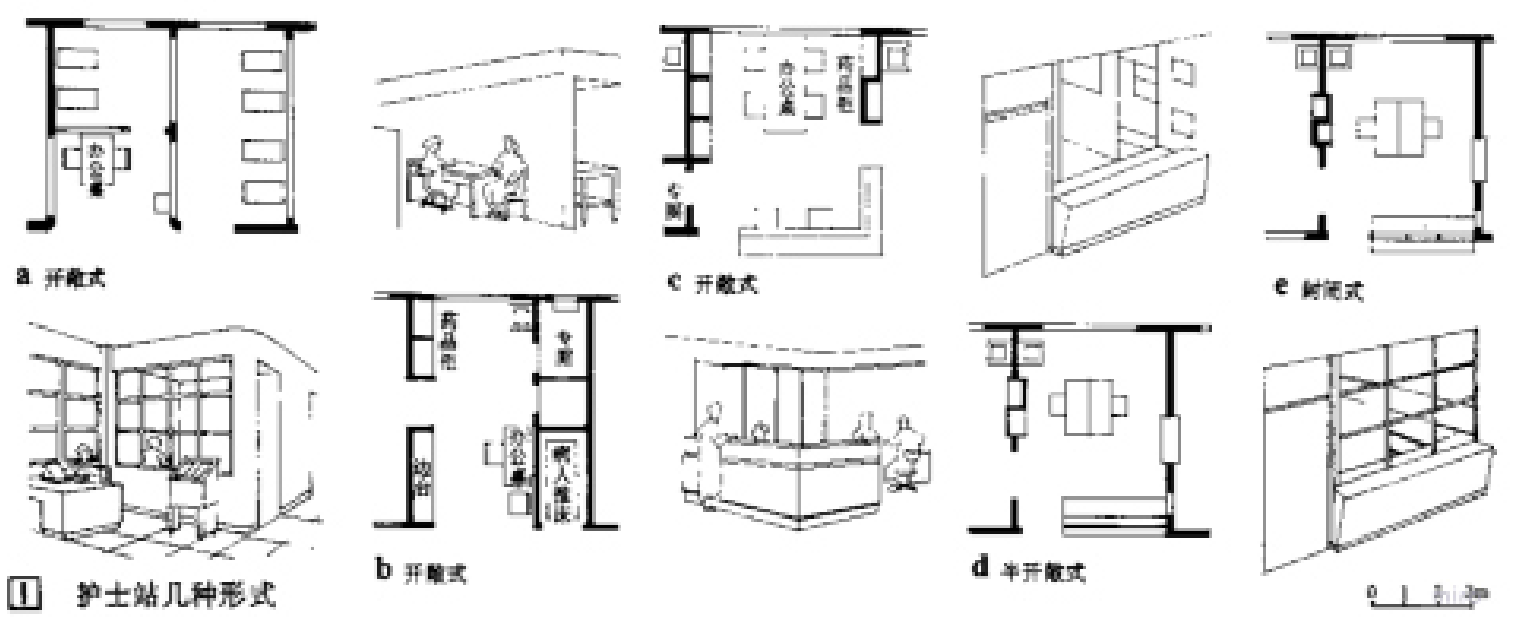

Nurse station

## CASE STUDY

The interior space is divided into three areas by these 15 brick pavilions: entrance and service, rest and coffee area, large activity space and its auxiliary activity space, and other spaces are arranged around the central activity space.

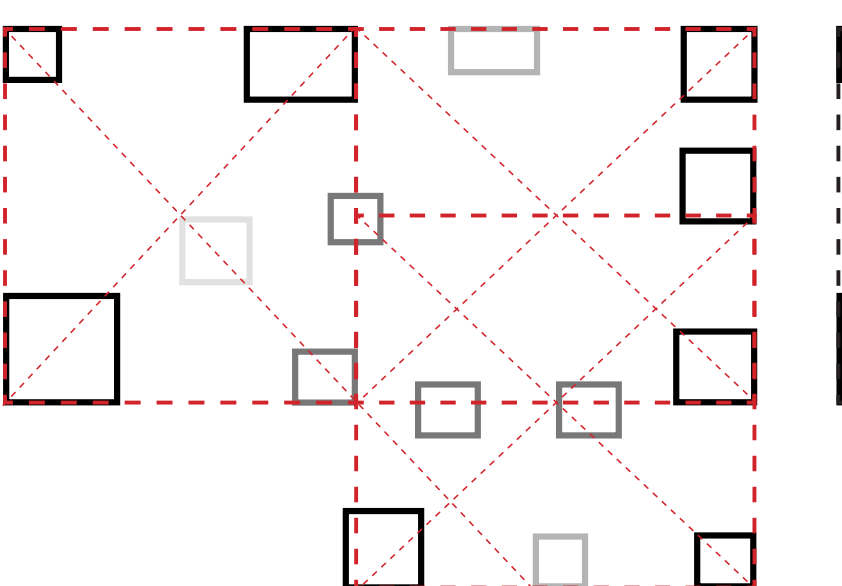
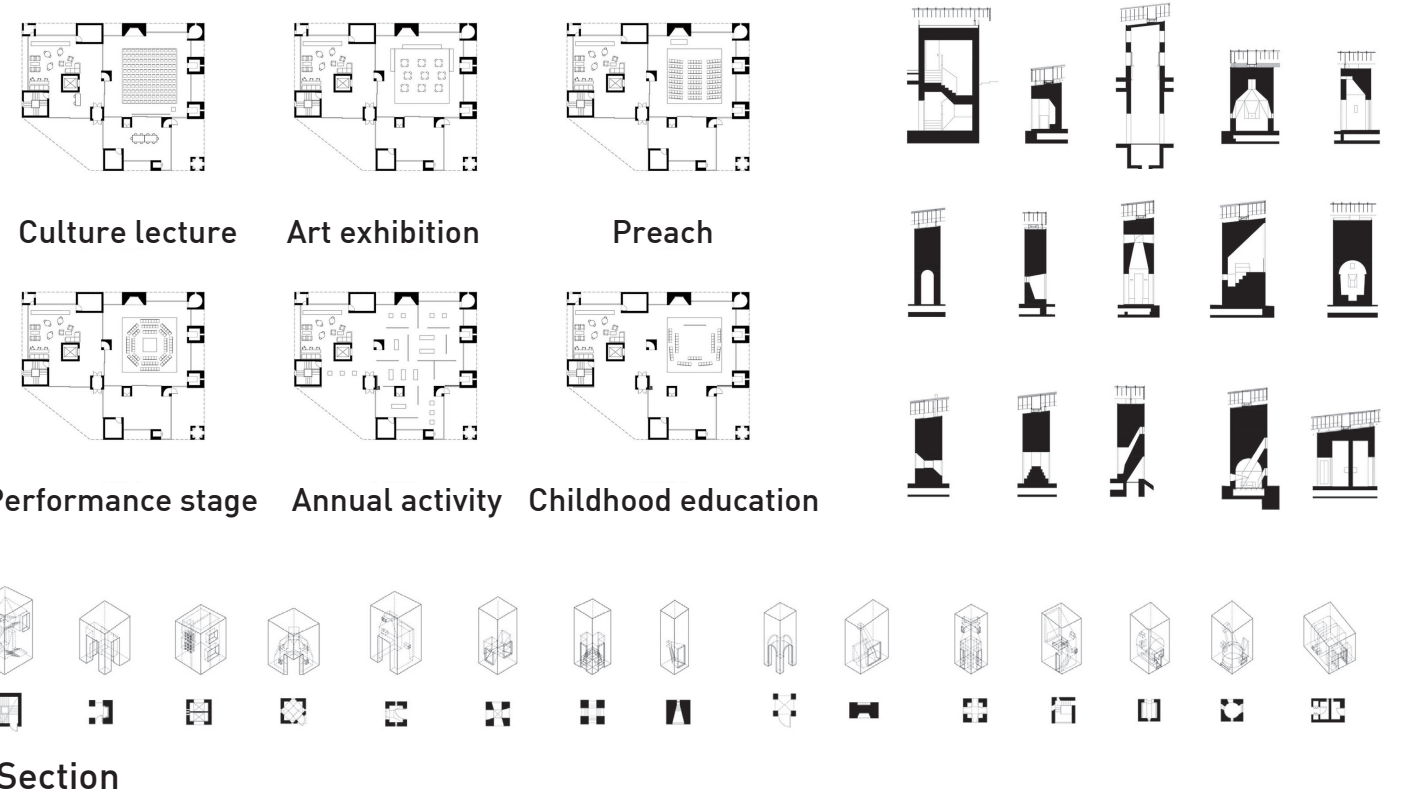
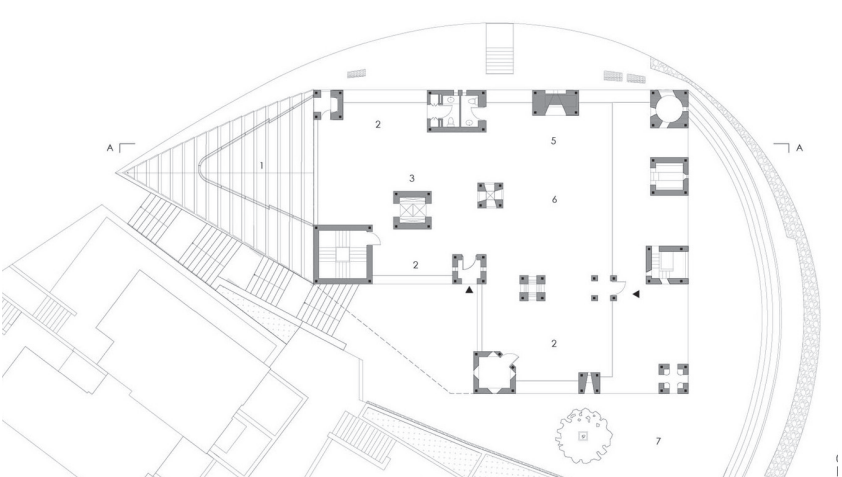

Arrangement and sliding of three square spaces

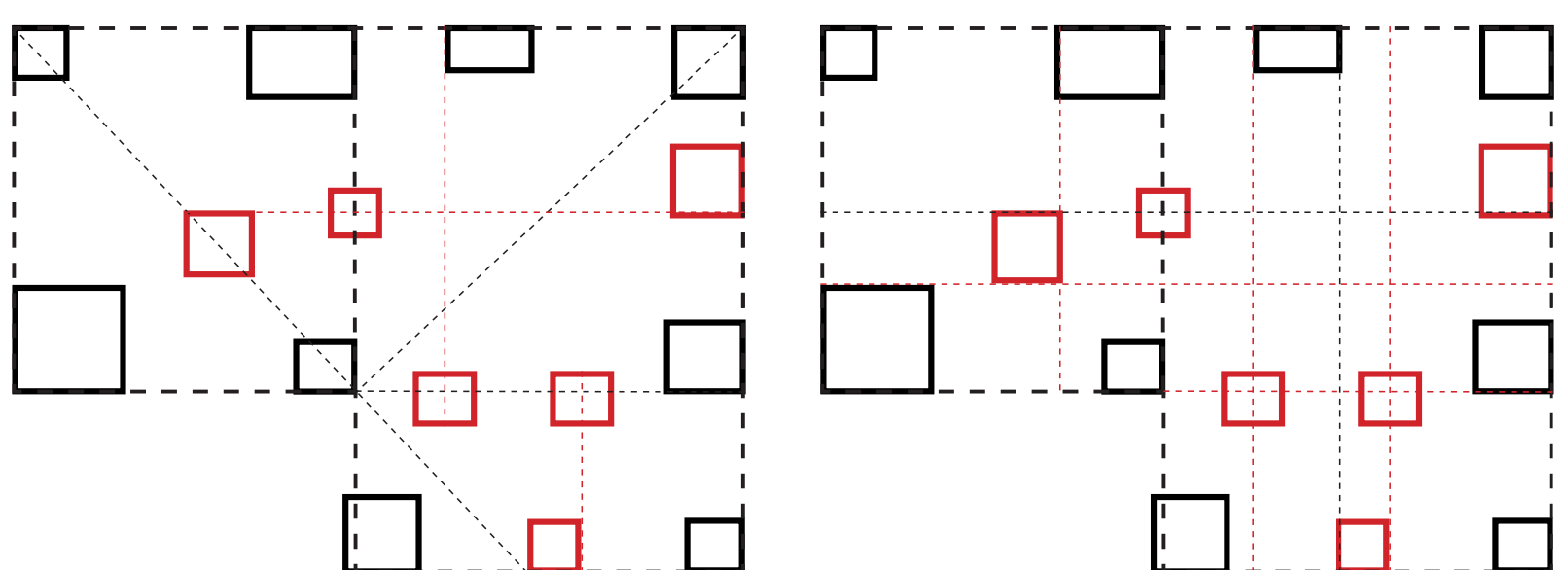

The change of the inner (non-edge) core space.

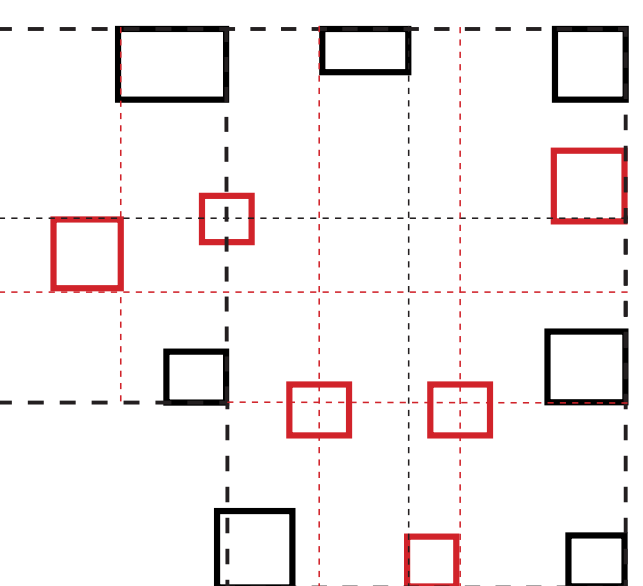

The positional relationship between all core spaces