

RELATIONS, CONNECTIONS and CRITERIA in DETAILS

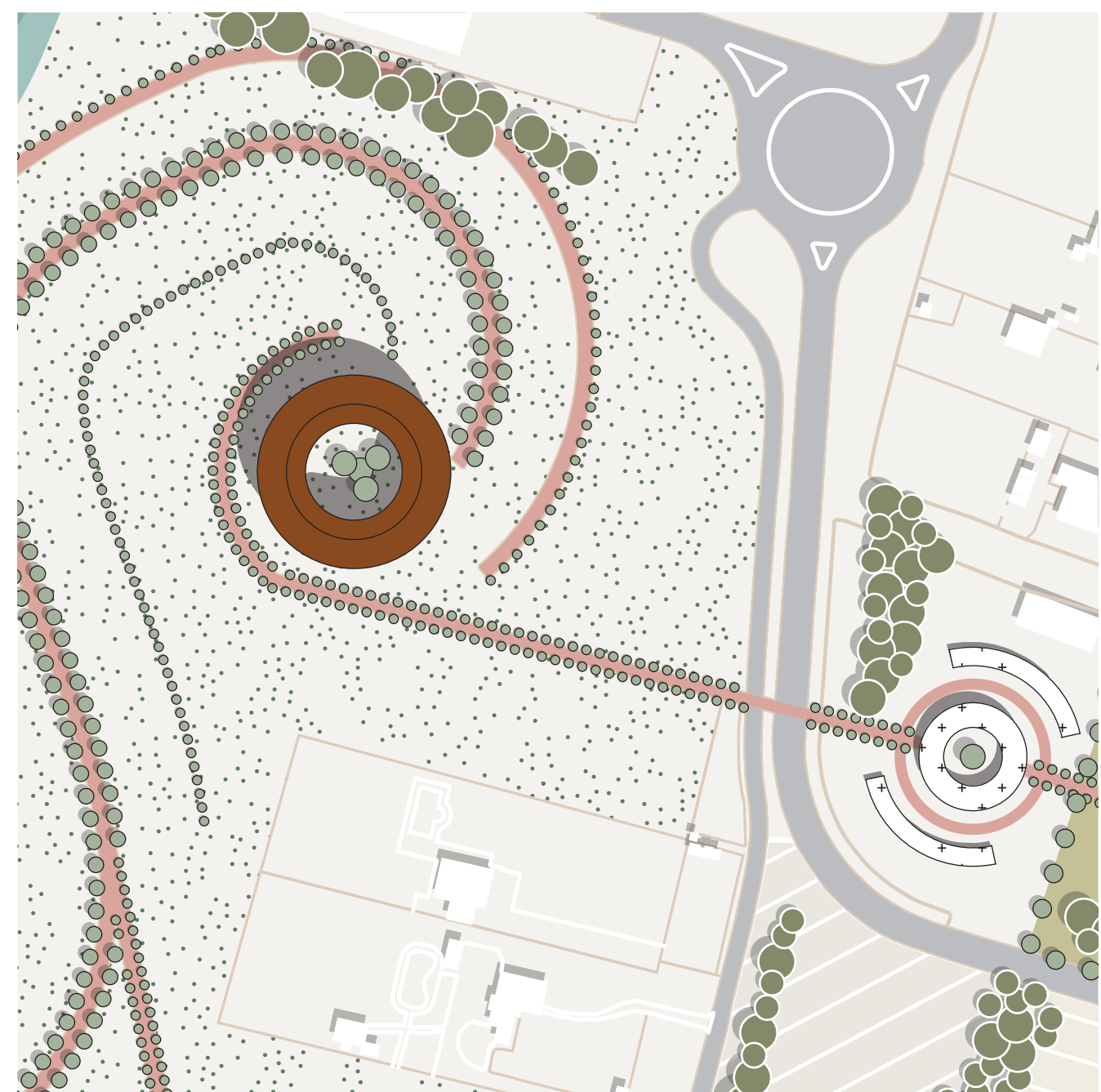

1 URBAN EXTENSION: COMPOSITION of TE BRUNETTI

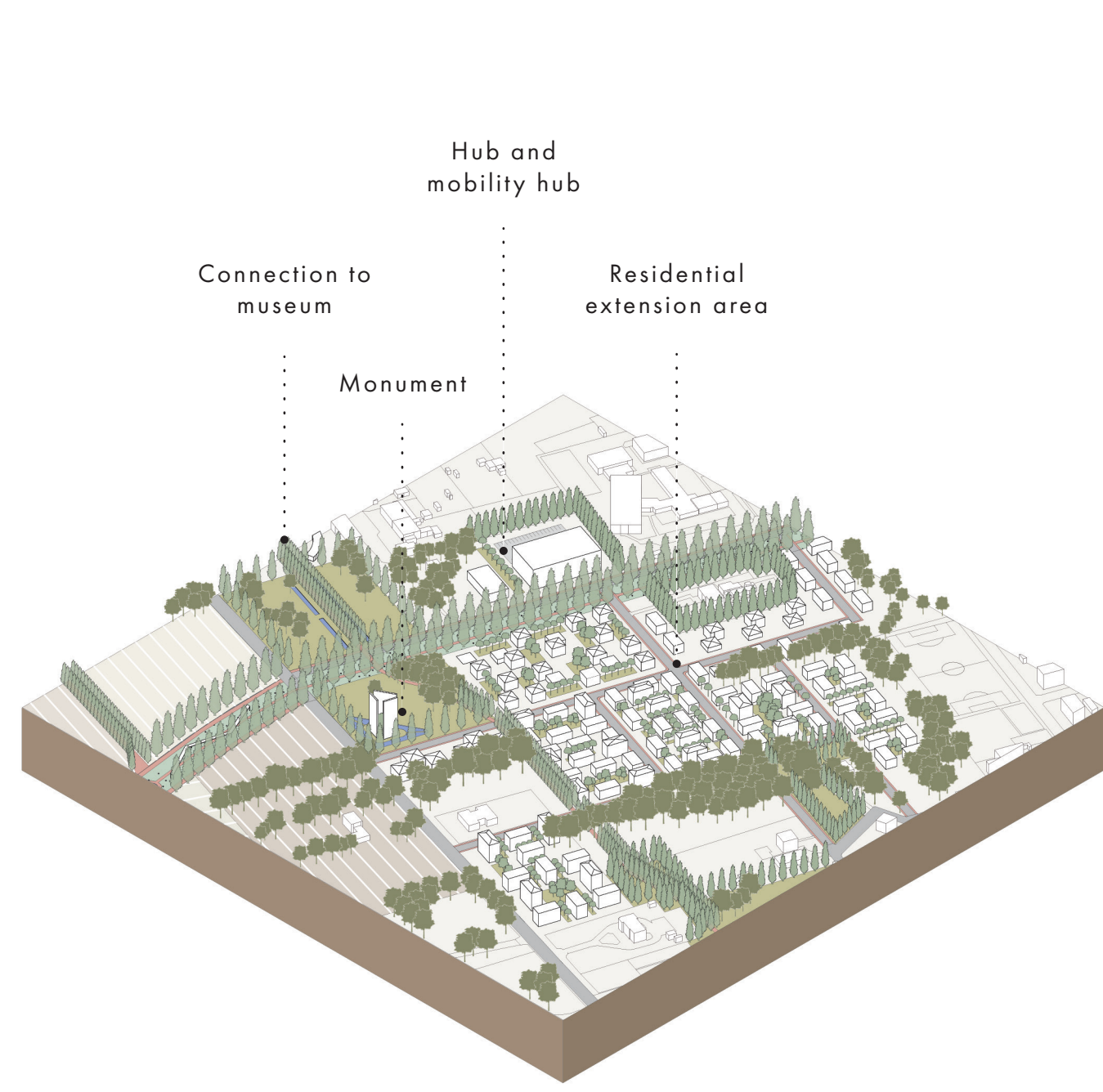

2 CONNECTION BETWEEN URBAN and LANDSCAPE

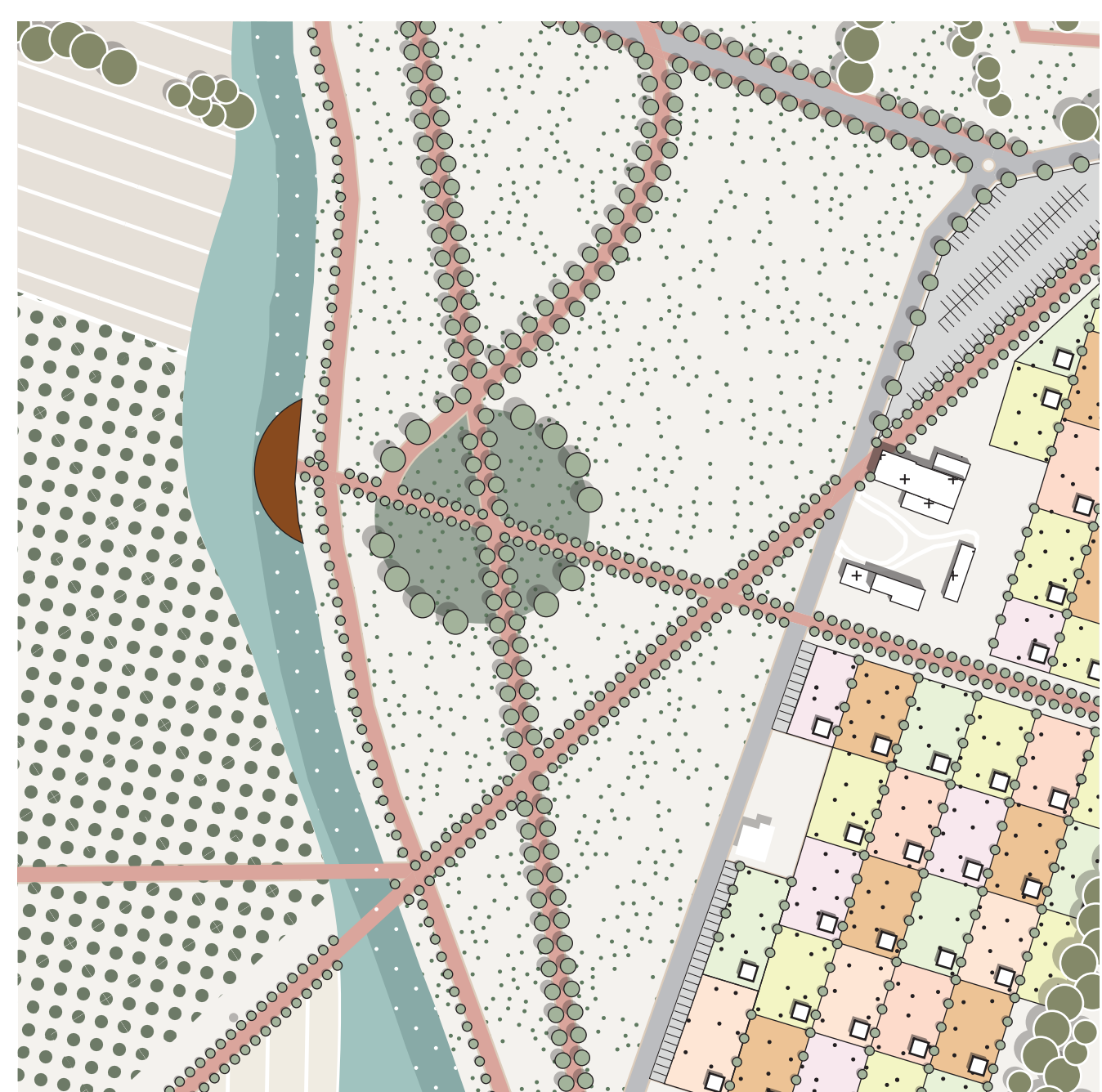
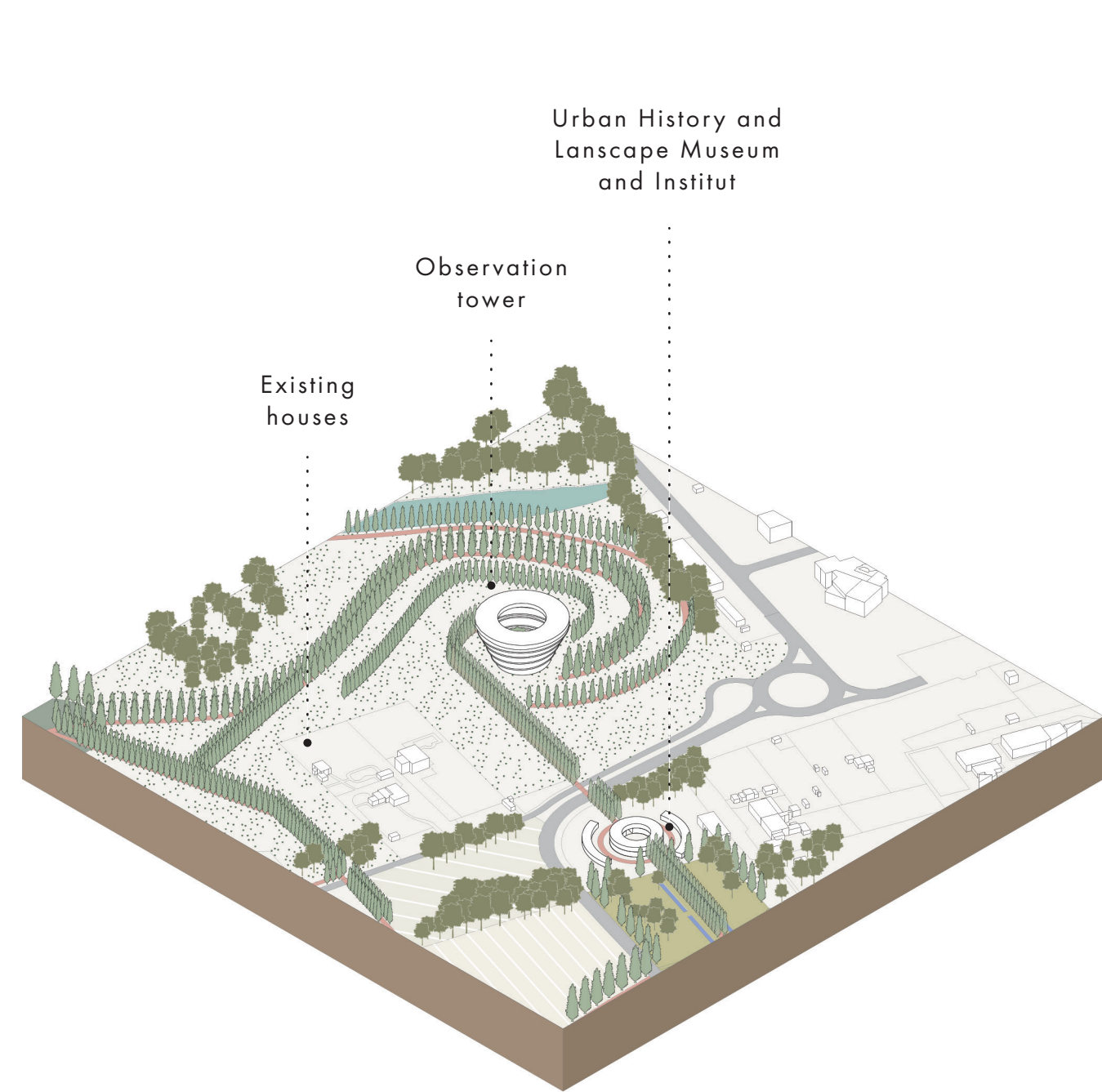

3 GREEN SHAPES: LINES and NODES

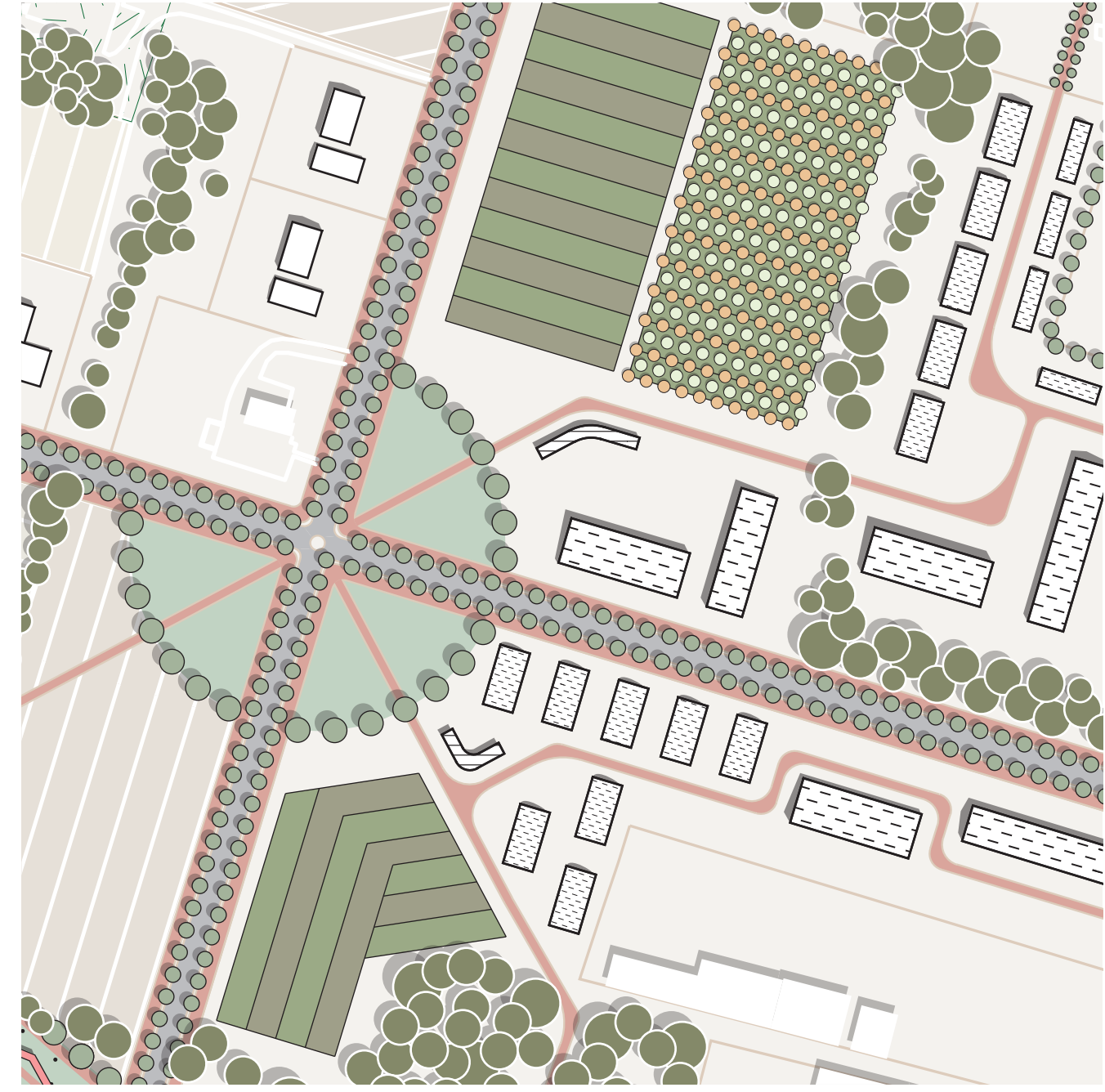
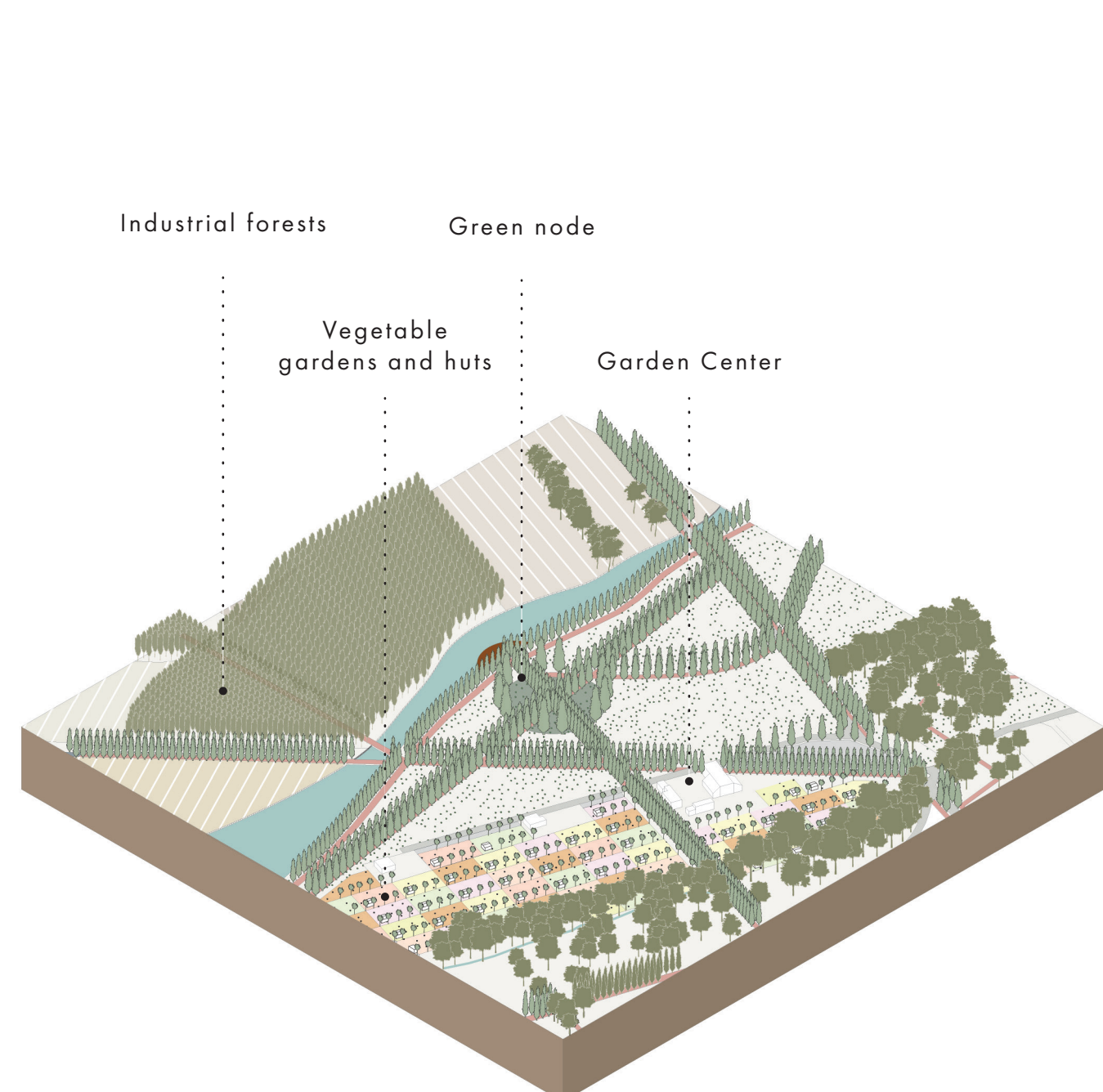

4 CENTRAL NODE: DISTRIBUTION to FUNCTIONS



5 INTERSECTION: GASTRONOMY CENTER



6 URBAN EXTENSION: MULTIFUNCTIONAL URBAN PARK

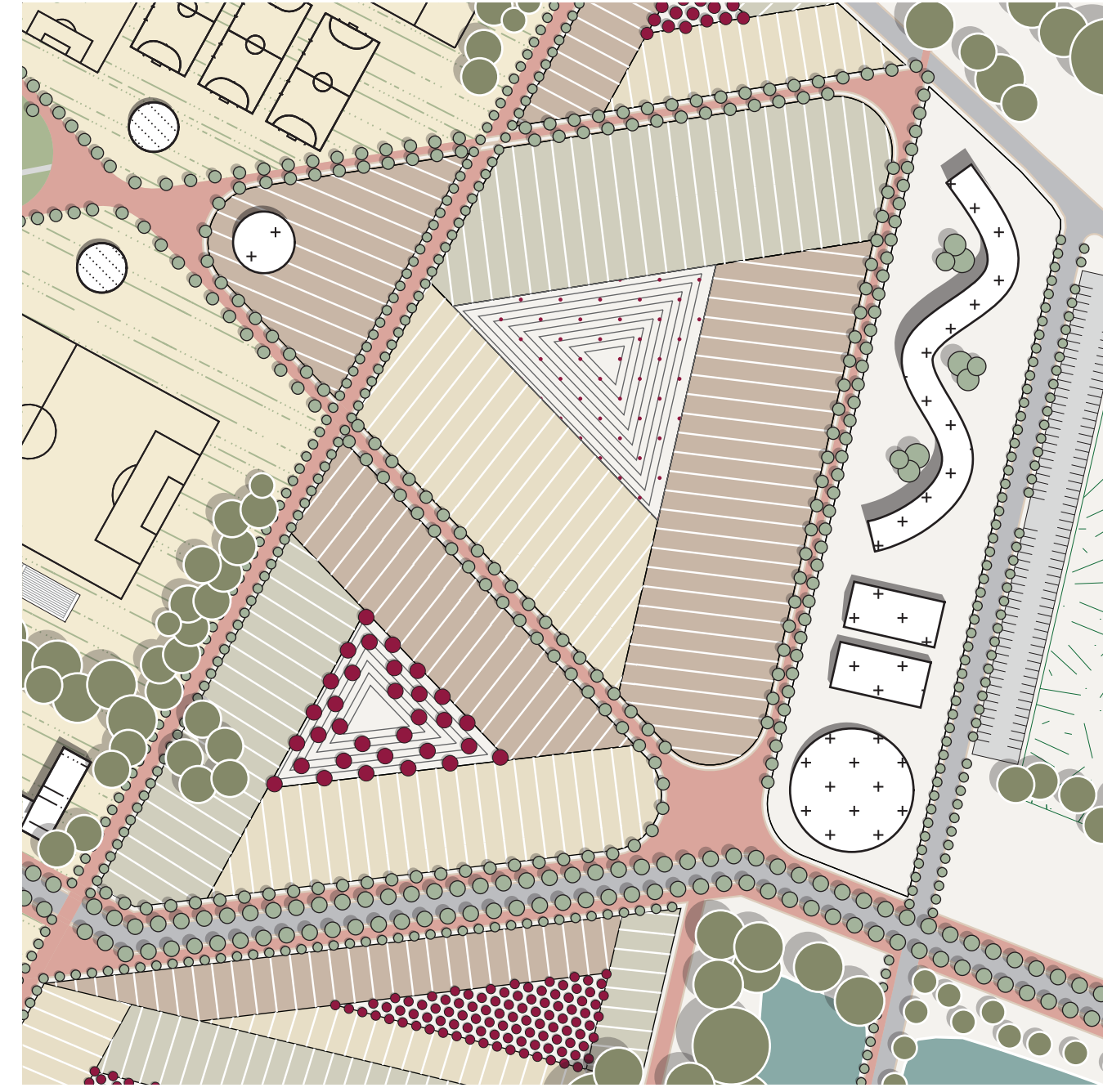
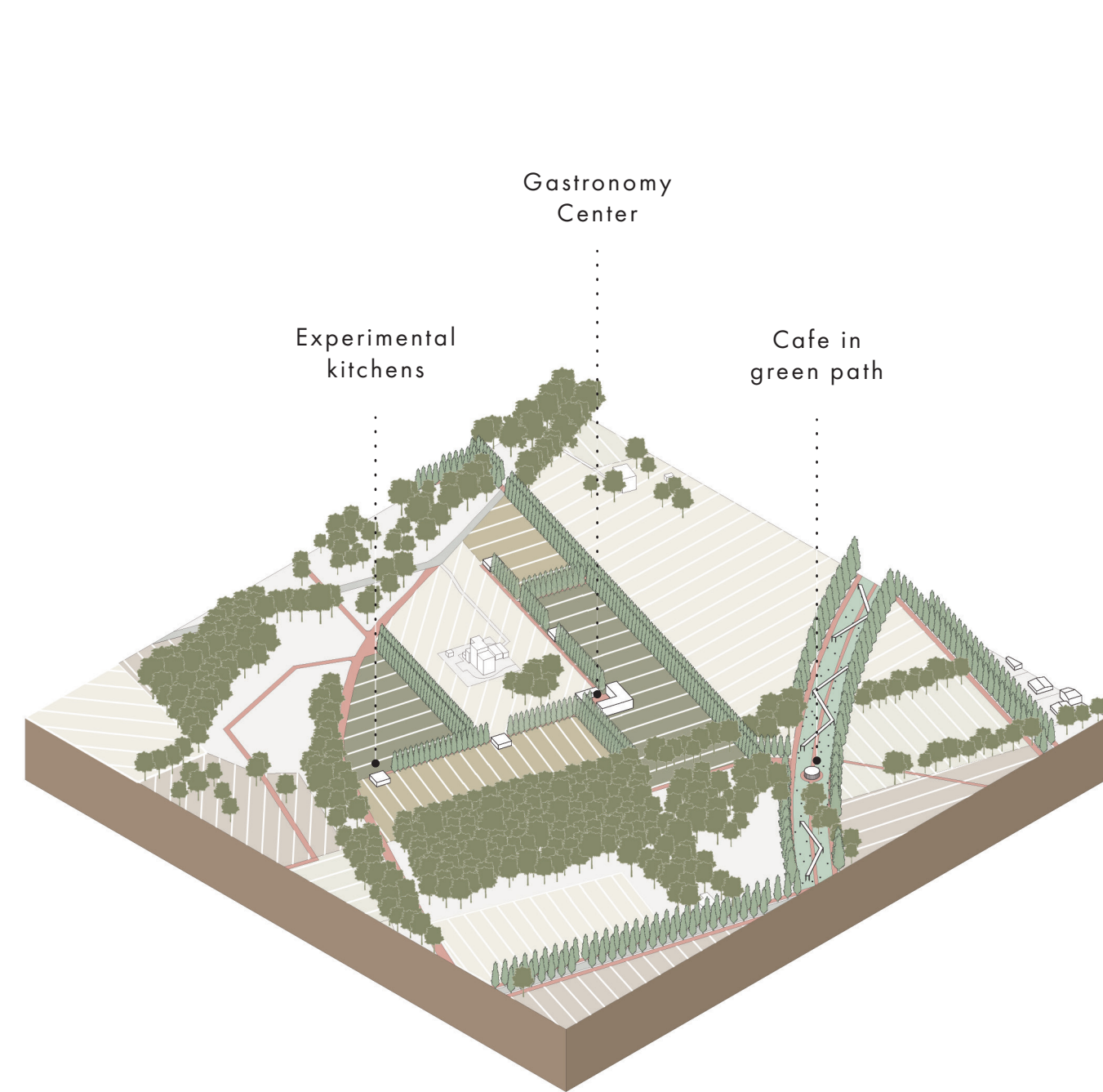
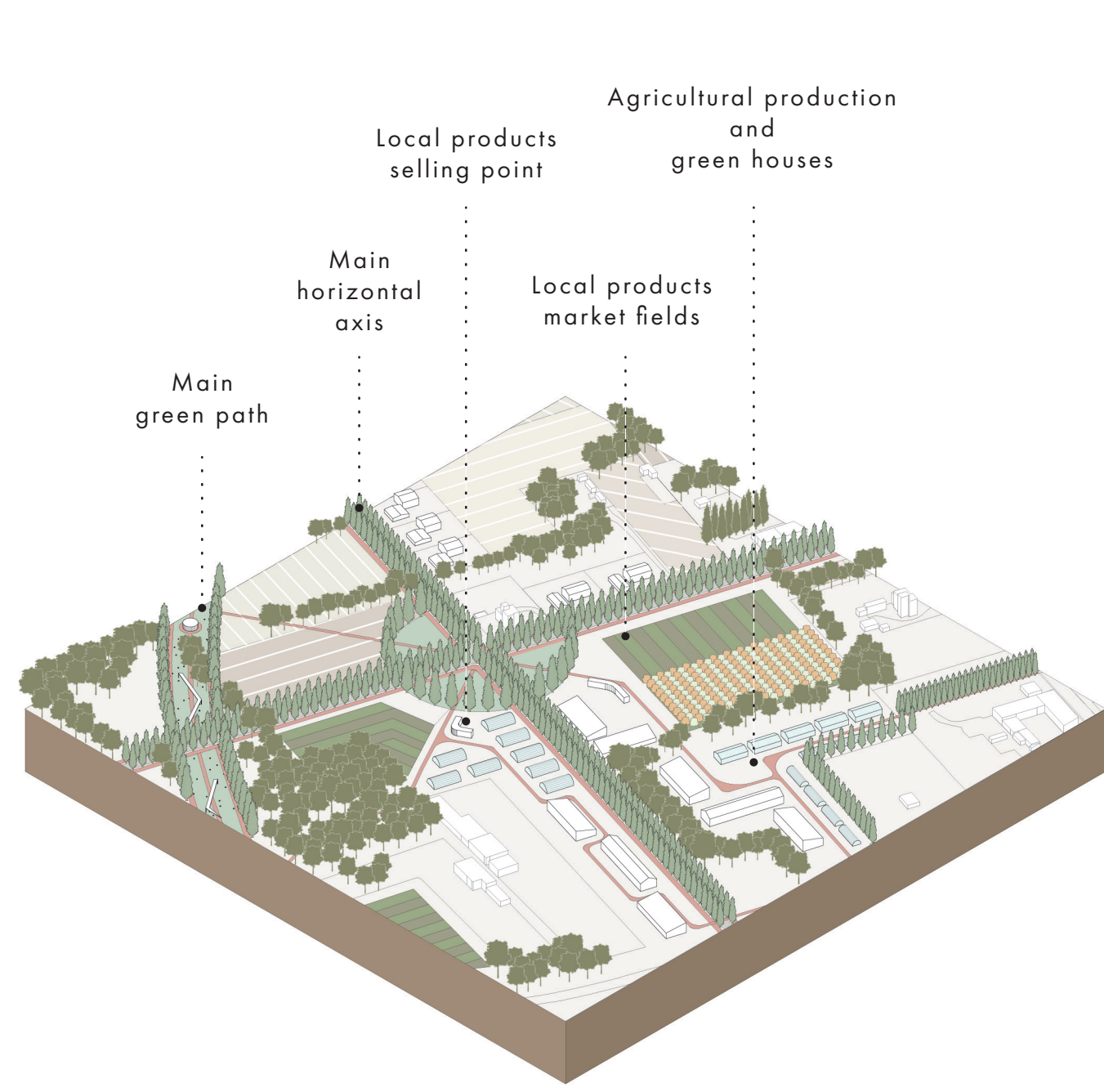

7 URBAN EXTENSION: AGRICULTURE and BOTANICS PARK

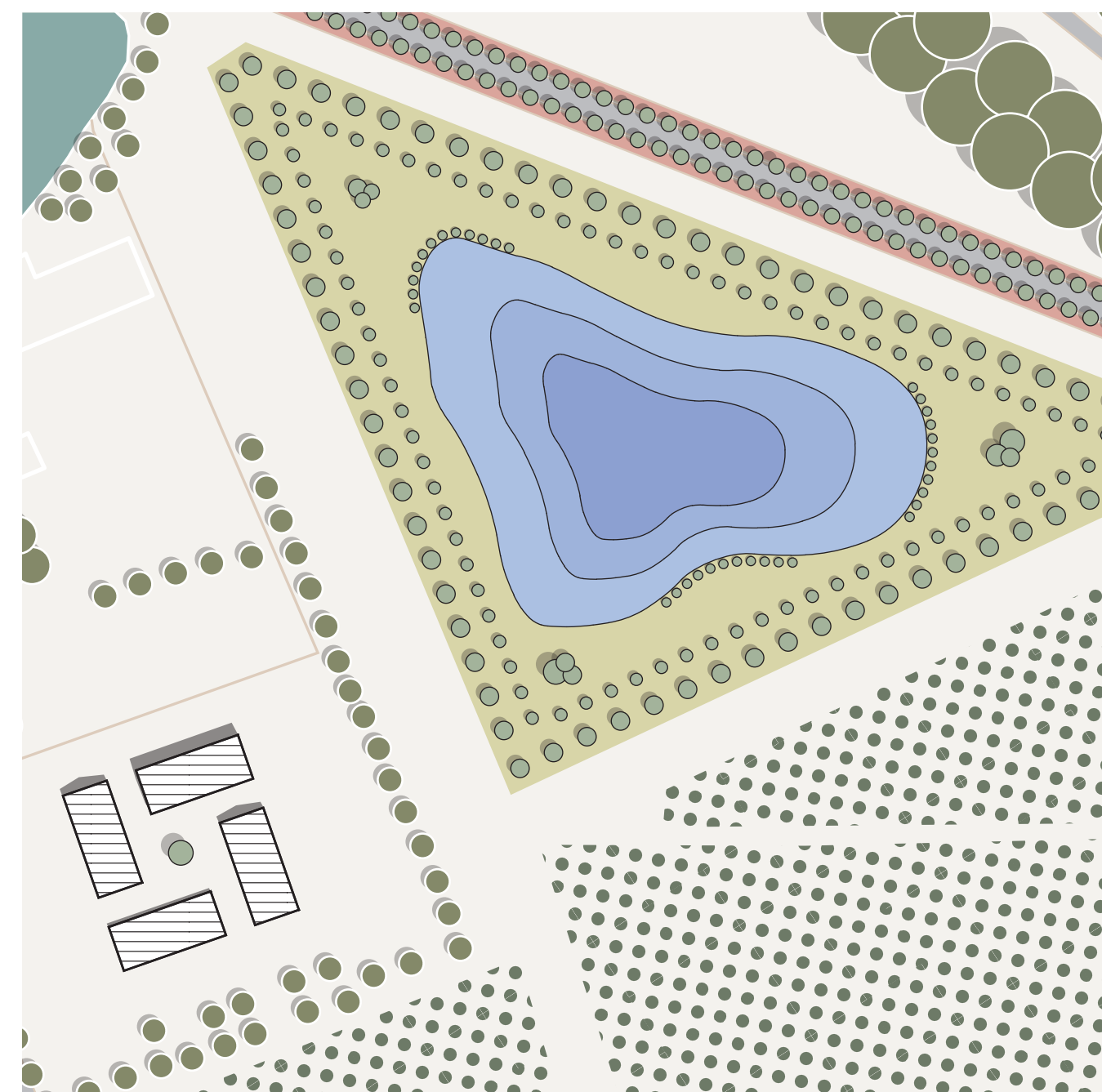

8 LANDSCAPE CONNECTION: NEW LAKE AREA

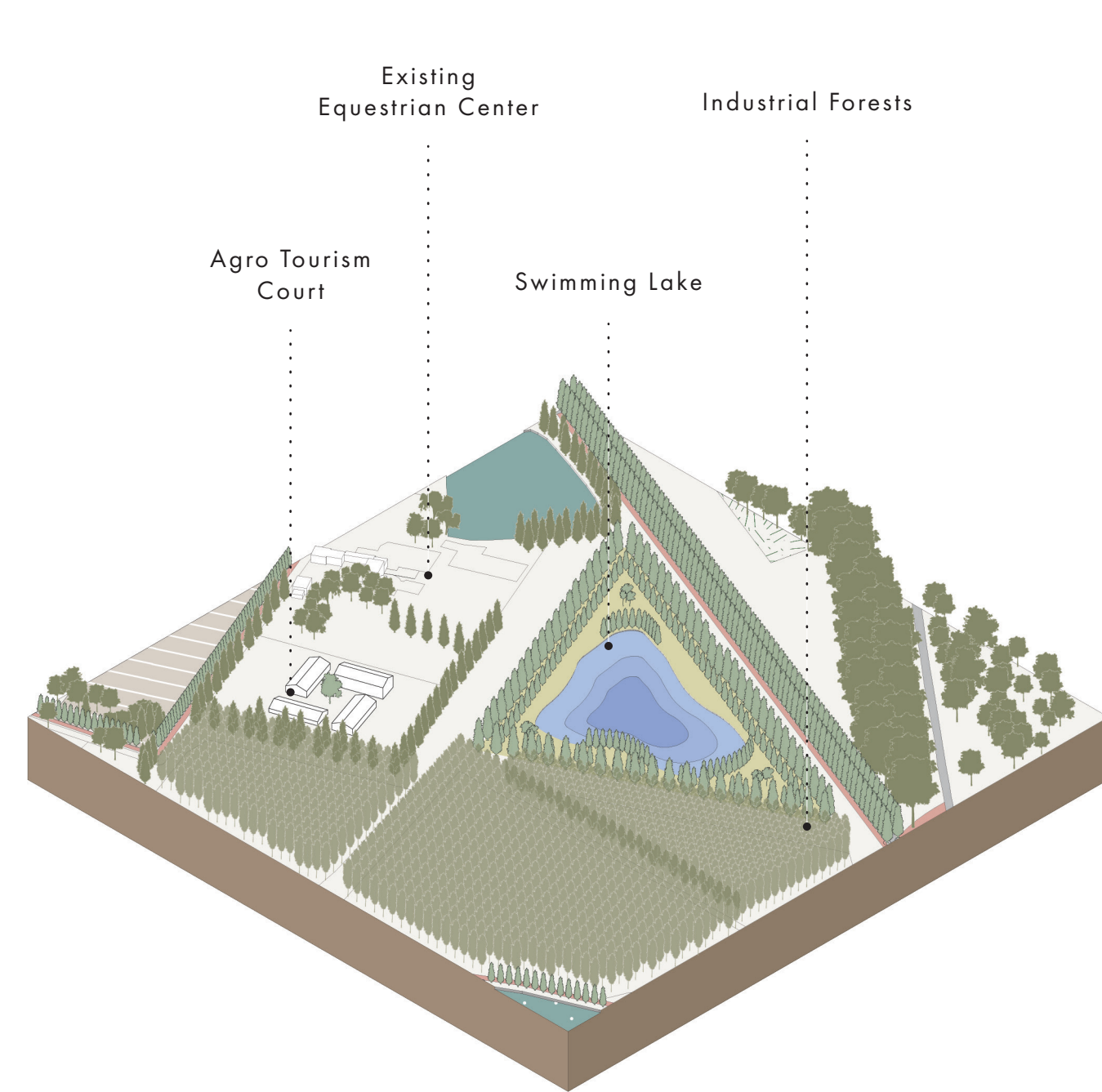
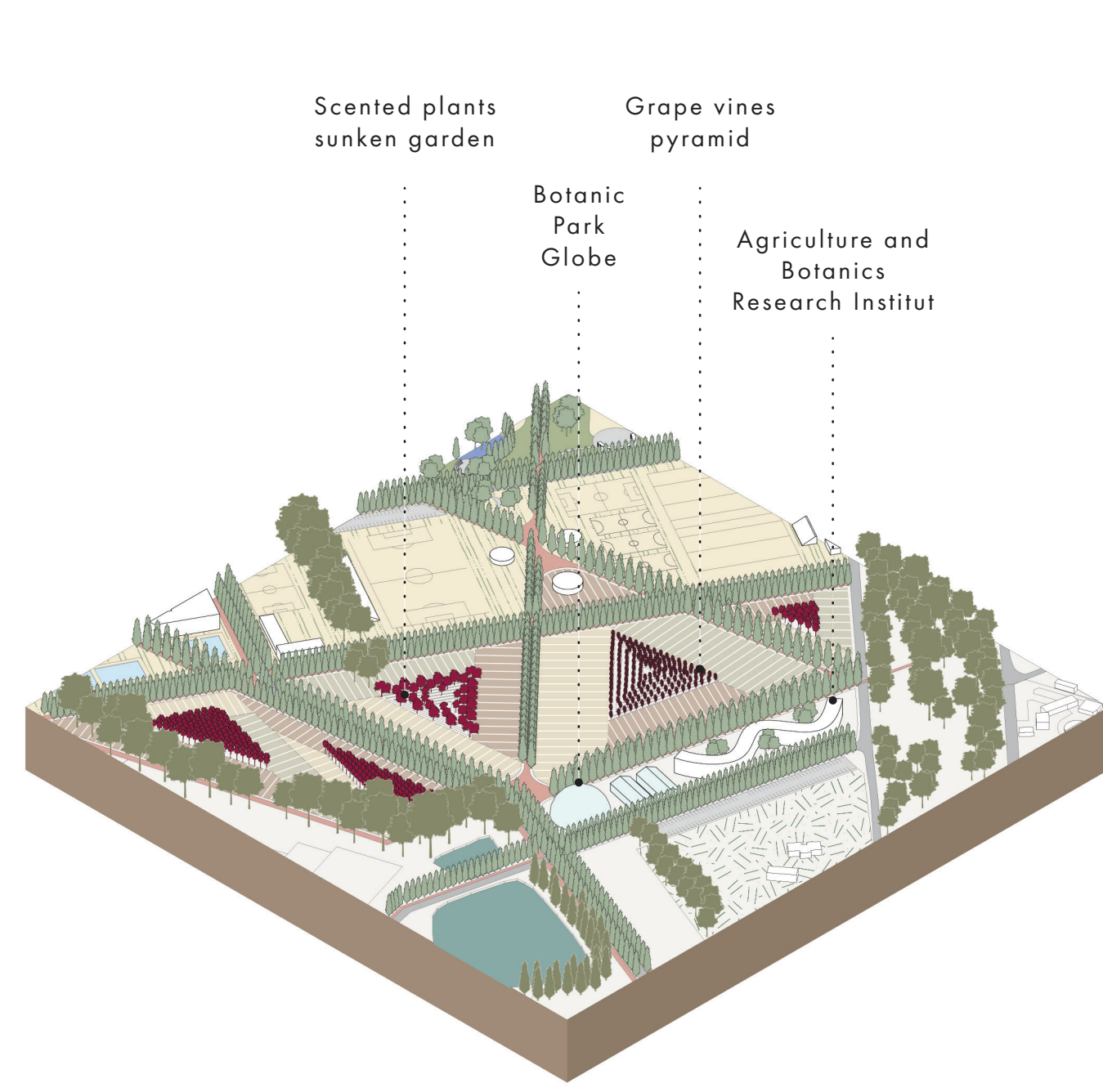

1: In this residential area, which is the continuation of the existing settlement of Te Brunetti, different types of buildings are organized in different combinations to form inner courtyards. There is a monument in the park, which is located in the continuation of the underpass to which Palazzo Te is connected, as it is the entrance to the whole area. Three stones of the monument symbolizes: Urban History-Gastronomy-Agriculture.

2: The museum-institute building located in the continuation of the urban extension and the main observation tower located in the natural park area, which is handled with the landscape connection approach, are directly connected by the path.

3: The node formed by the intersection of paths connecting different focal points is designed as a green square. This node is connected to the observation deck, which is the element of the landscape connection approach.

4: The central green node in the intersection area is located in the center of the main axes that distribute to the whole area in the north-south and east-west directions. This node also serves the paths to the gastronomy center and local products market and agricultural production area.

5: The gastronomy center, which is shaped around an existing residence in the agricultural area, is a unit located in the intersection area and connecting urban and agriculture.

6: The park, which is an urban extension, is completely organized with green pockets and hard surfaces with different functions, unlike the natural park. The new pedestrian-bike underpass at the point where the green path connects to the park opens to a higher three-stone monument. Thus, both ends of the green path have turned into reference points.

7: Another urban extension, Agriculture and Botanics Park, is the continuation of the botanical education area in Bosco Virgiliano and is a threshold for the transition to agricultural land. Different agricultural practices are seen in the area, which serves both educational and recreational purposes.

8: The most radical intervention made with the landscape connection approach is seen in this area. The lake area, designed in accordance with the natural shape of the area, is emphasized with trees.