

SOCIETÀ UMANITARIA SITE

The Società Humanitaria buildings, which are located in the heart of Milan, presents a unique example of architecture. Each part of the complex has its own story. In order to understand Società Humanitaria, we have to focus on all elements separately, to see the historical, architectural and functional diversity. It is also necessary to see it as one entity.

"Connect To Reveal" project is conservative transformation: an harmony between the church, the old Cloister, the latest intervention made by Gardella – Romano and the new design approach.

The Società Humanitaria buildings, which are located in the heart of Milan, presents a unique example of architecture. Each part of the complex has its own story. In order to understand Società Humanitaria, we have to focus on all elements separately, to see the historical, architectural and functional diversity. It is also necessary to see it as one entity.

"Connect To Reveal" project is conservative transformation: an harmony between the church, the old Cloister, the latest intervention made by Gardella – Romano and the new design approach.

The Società Humanitaria buildings, which are located in the heart of Milan, presents a unique example of architecture. Each part of the complex has its own story. In order to understand Società Humanitaria, we have to focus on all elements separately, to see the historical, architectural and functional diversity. It is also necessary to see it as one entity.

"Connect To Reveal" project is conservative transformation: an harmony between the church, the old Cloister, the latest intervention made by Gardella – Romano and the new design approach.

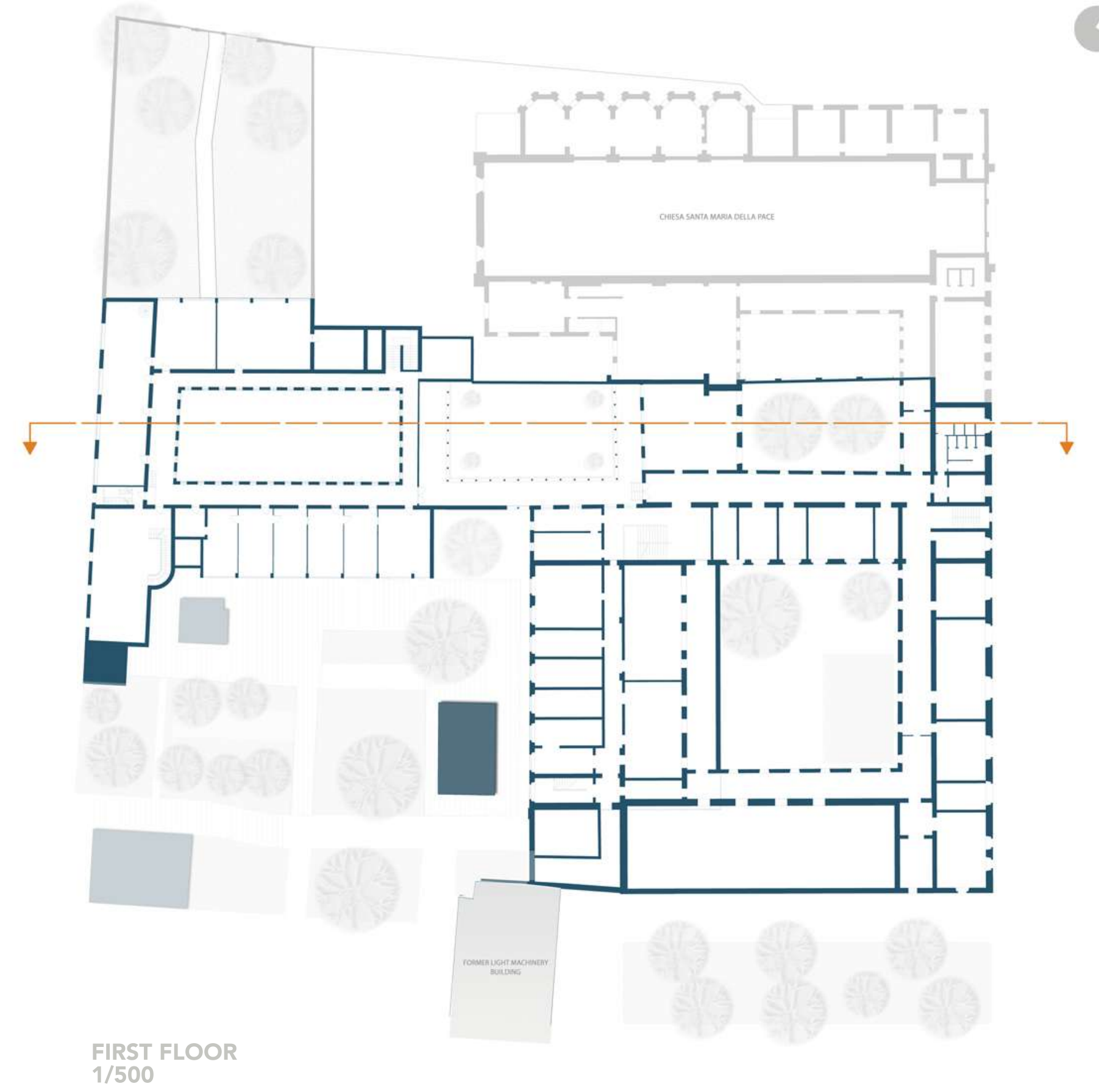
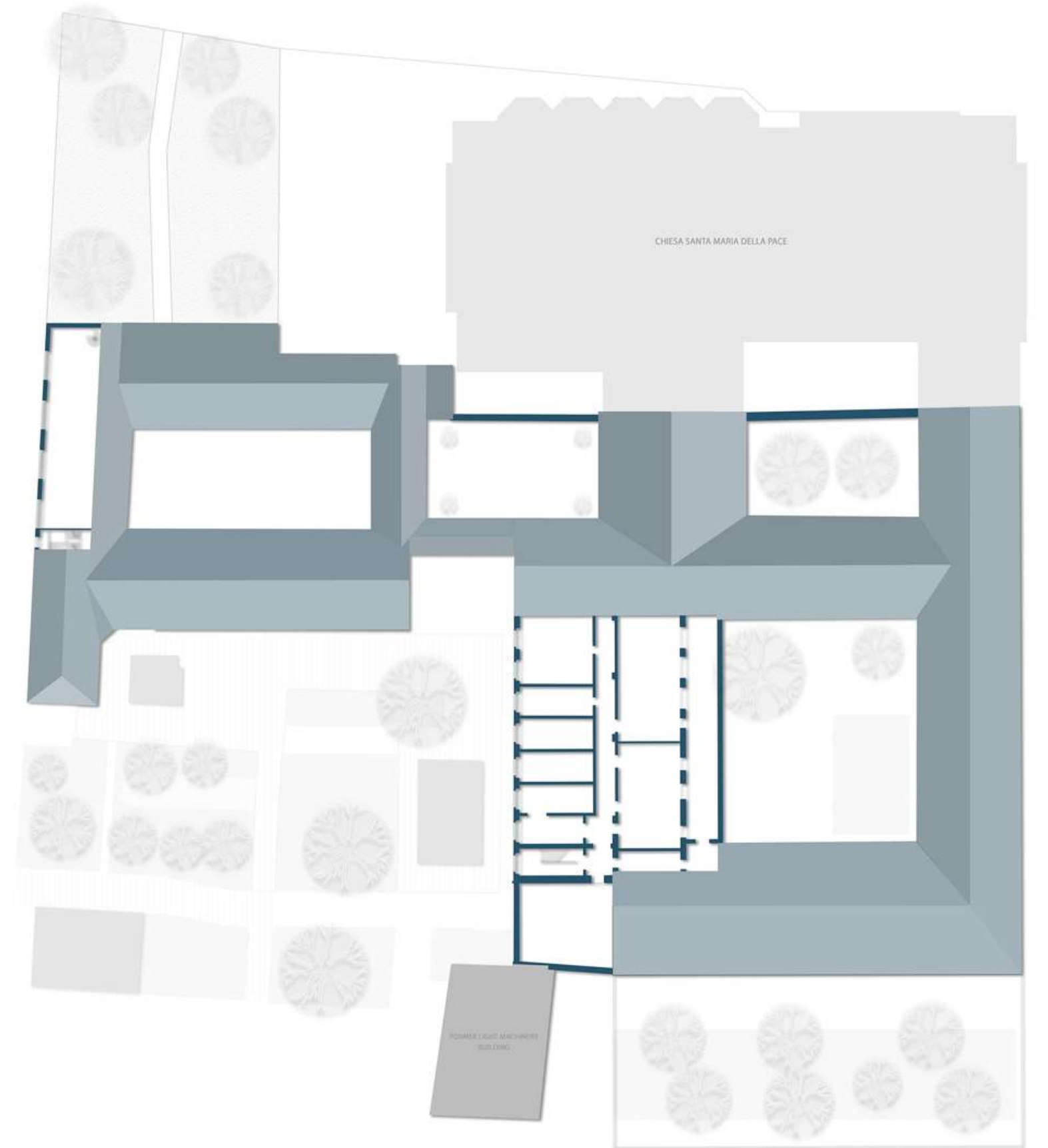

FIRST FLOOR
1/500



GROUND FLOOR
1/500

