



1 The interior of B3 presents a level change on the interior as a signal and transition from one significant condition to the next.



2 The circular cave like interior is located at the apex of the cross. It defines the axis of significance and is a catchment area for water.



3 A worship and observation point. Beautiful views of the landscape and valley are exhibited from this point.



4 This stepped catchment serves as a resting point for the locals as it is located close to the market.

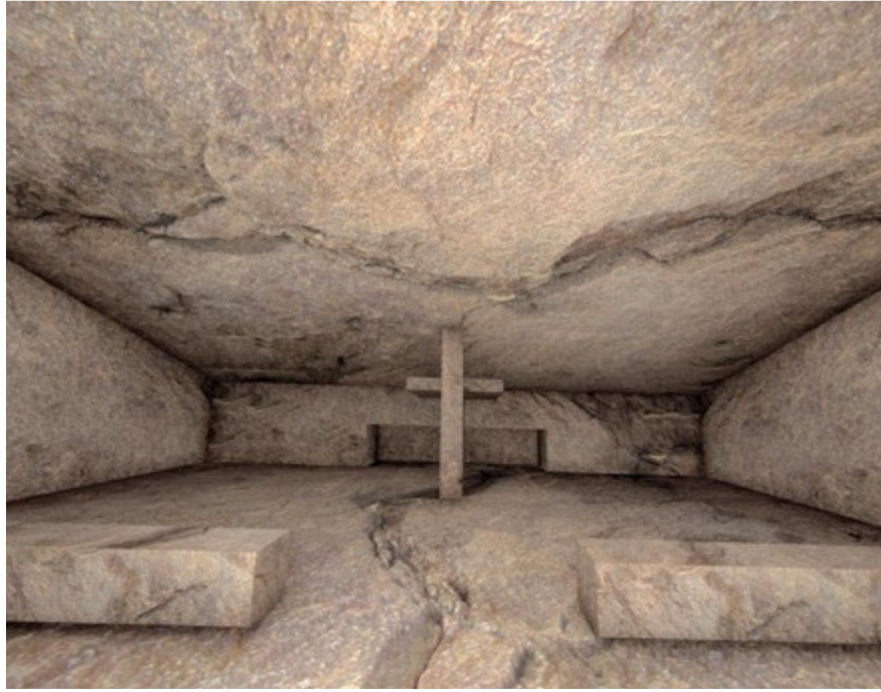

5 Below is an intimate 'cave like' worship area.

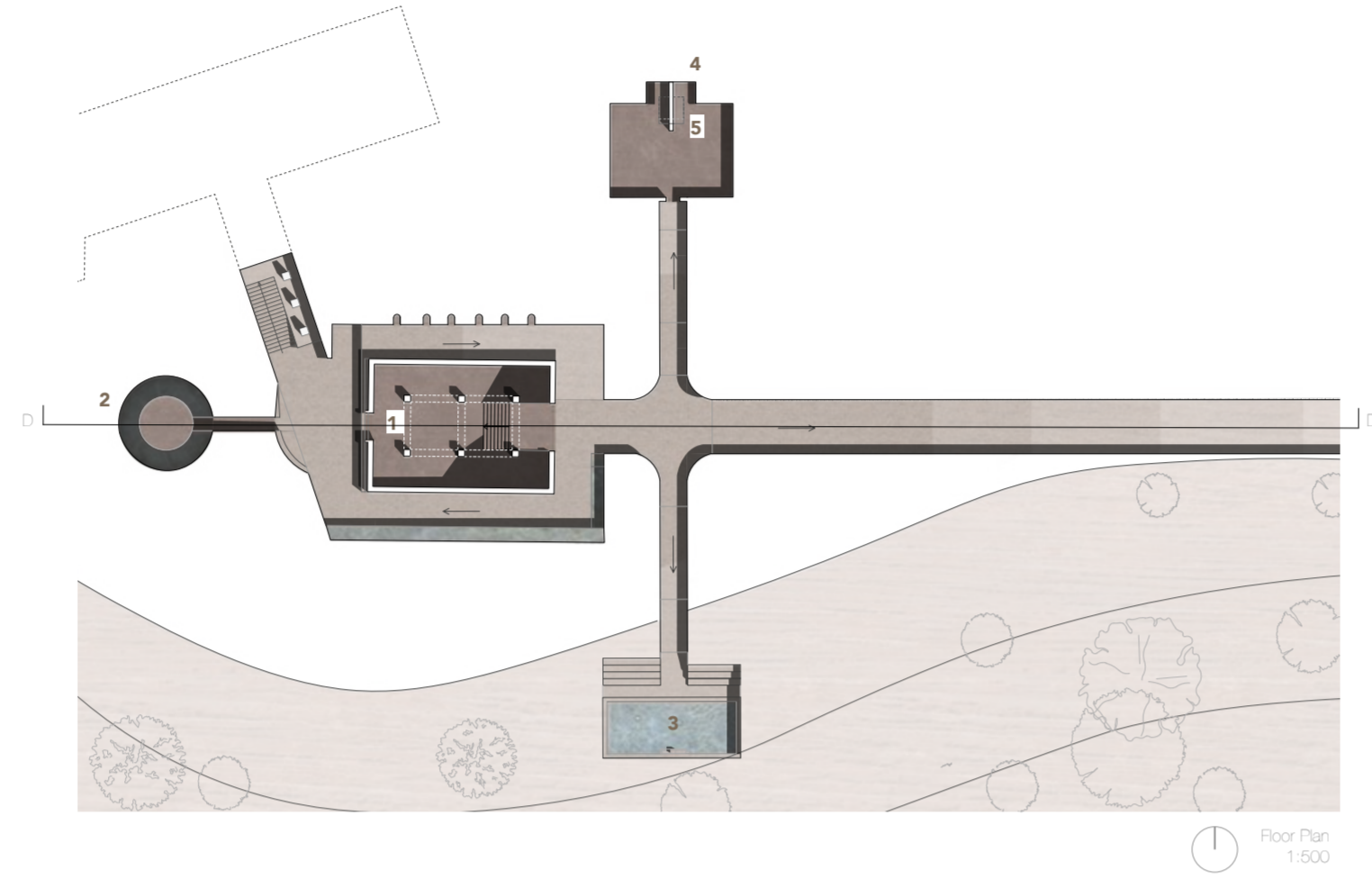

Floor Plan
1:500

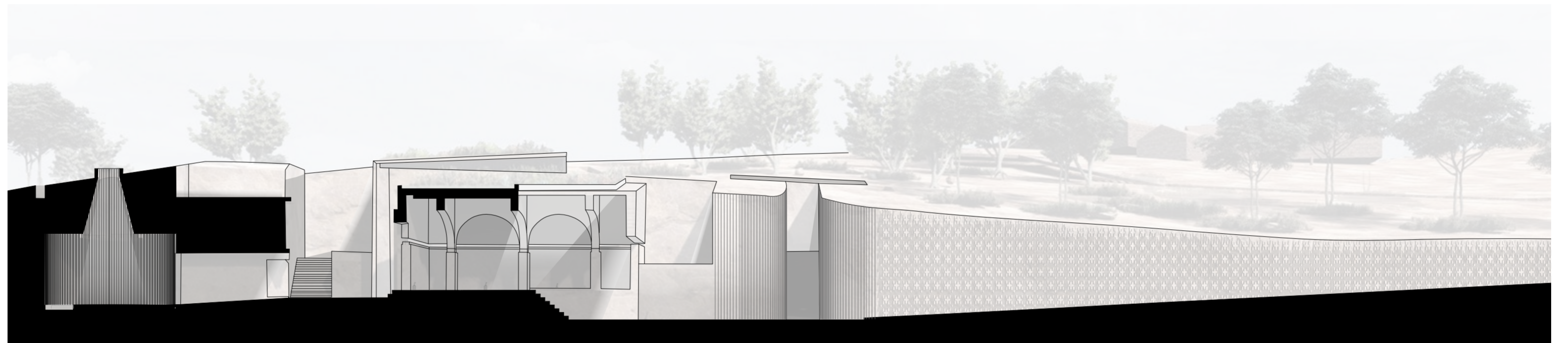

Long primary trench section
1:200