

BOXES CORE // TERRITORIAL DISPOSITION

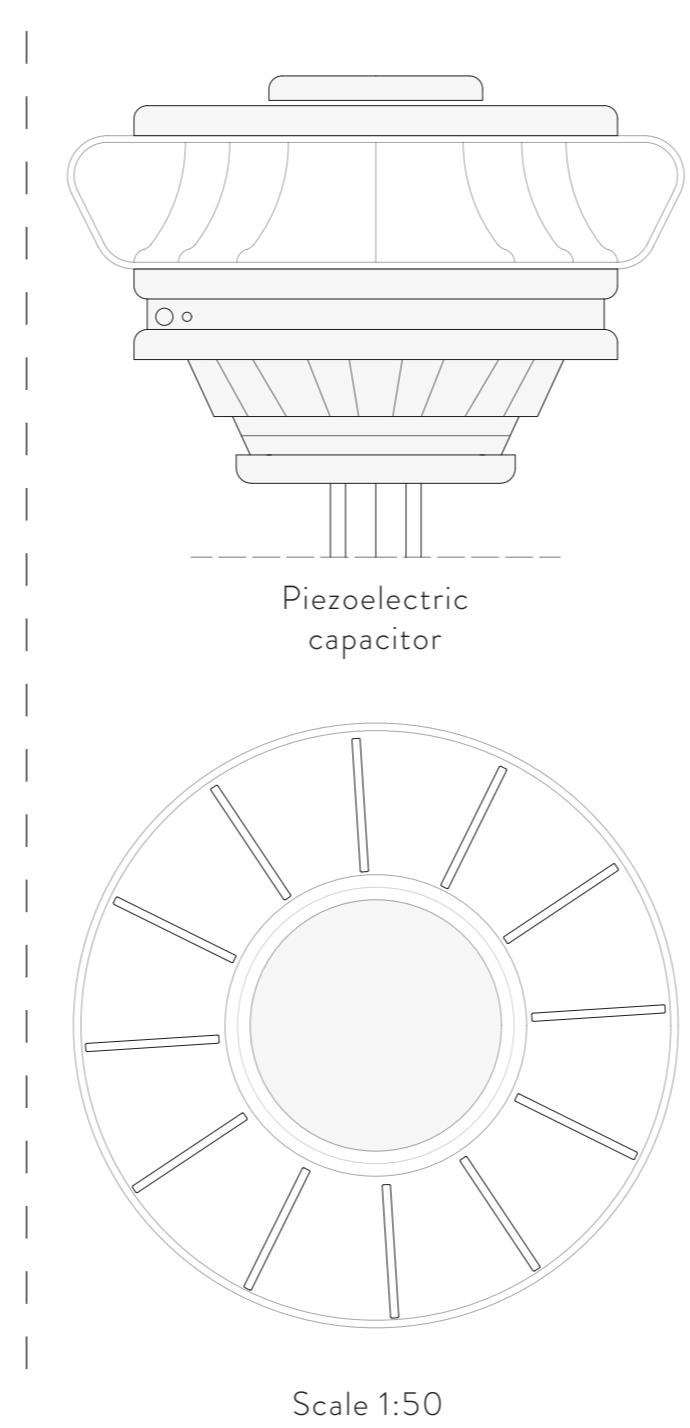
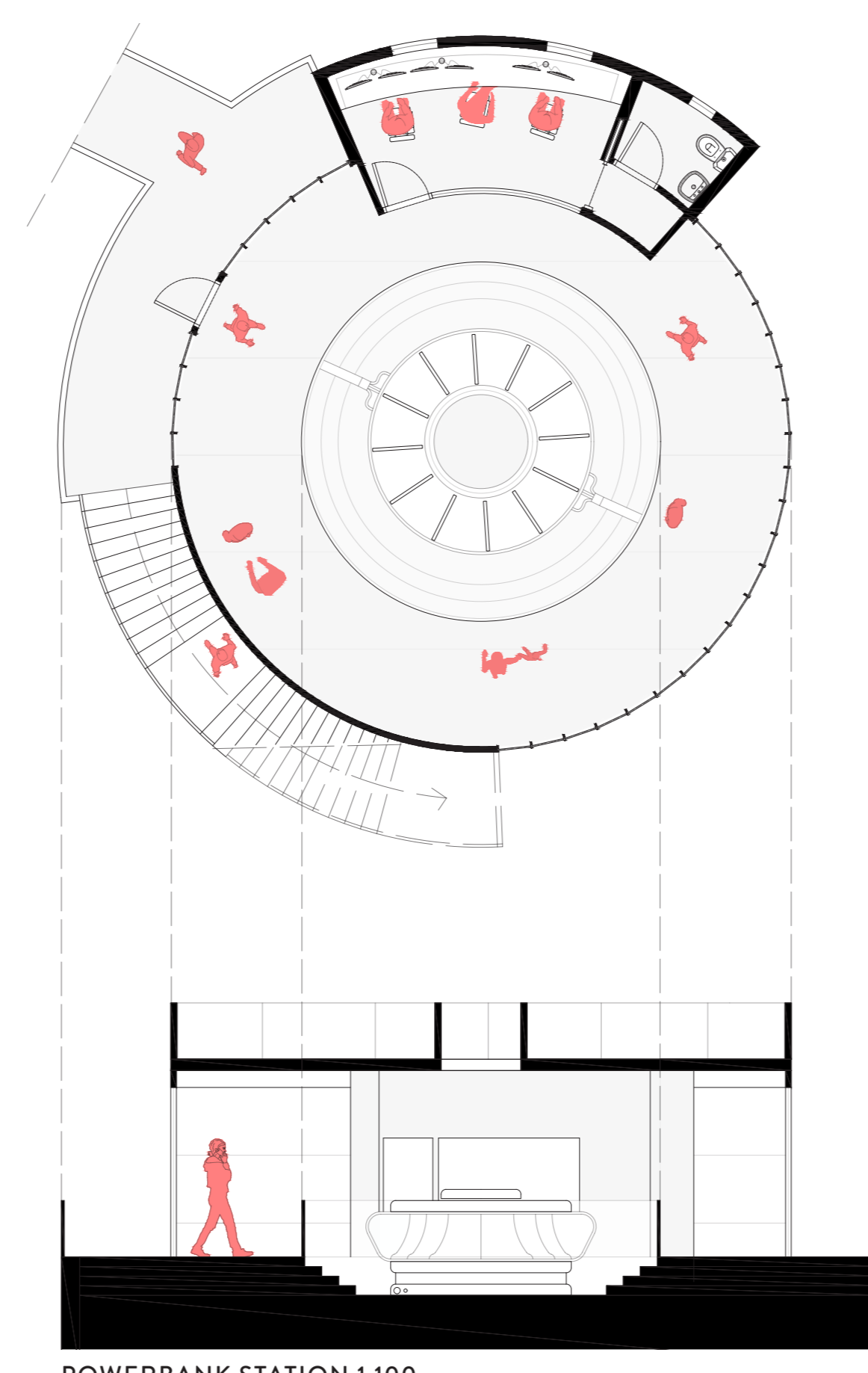
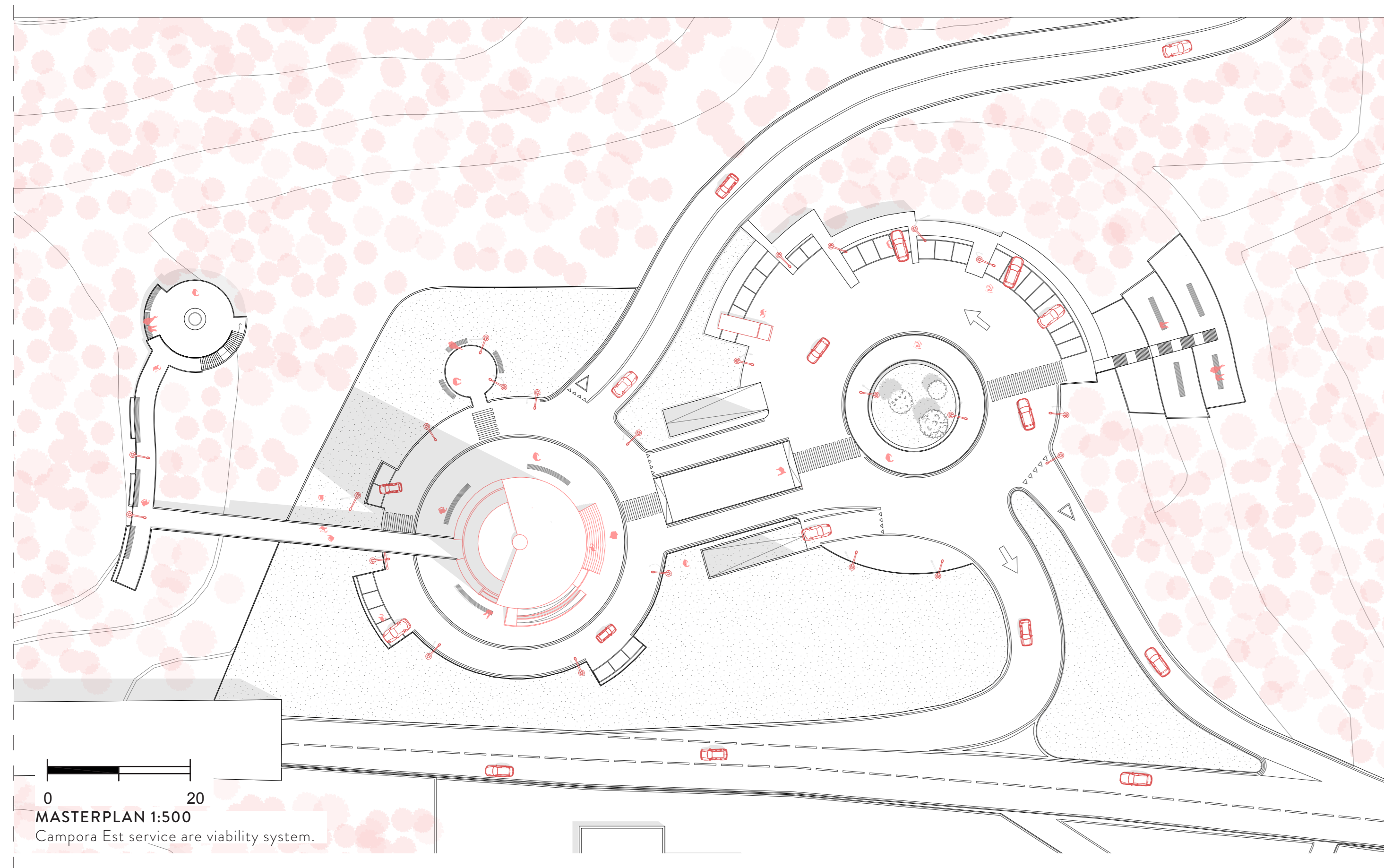

The piezoelectric power capacitor that powers all the tower through the piezoelectric plates set in the motorway.

The power bank station is located in the hill side of the site reachable by a bridge that directly connects the tower with a path leading to the capacitor location. This wants to connect the tower with the environment and invite the visitors of the service area to have a walk in the surrounding nature.

In this way they can observe the piezoelectric capacitor technology and at the same time observe the Boxes Core Tower and the Serra Ricco landscape.

