

PARKING UNDER THE MUSEUM - GROUND FLOOR LEVEL

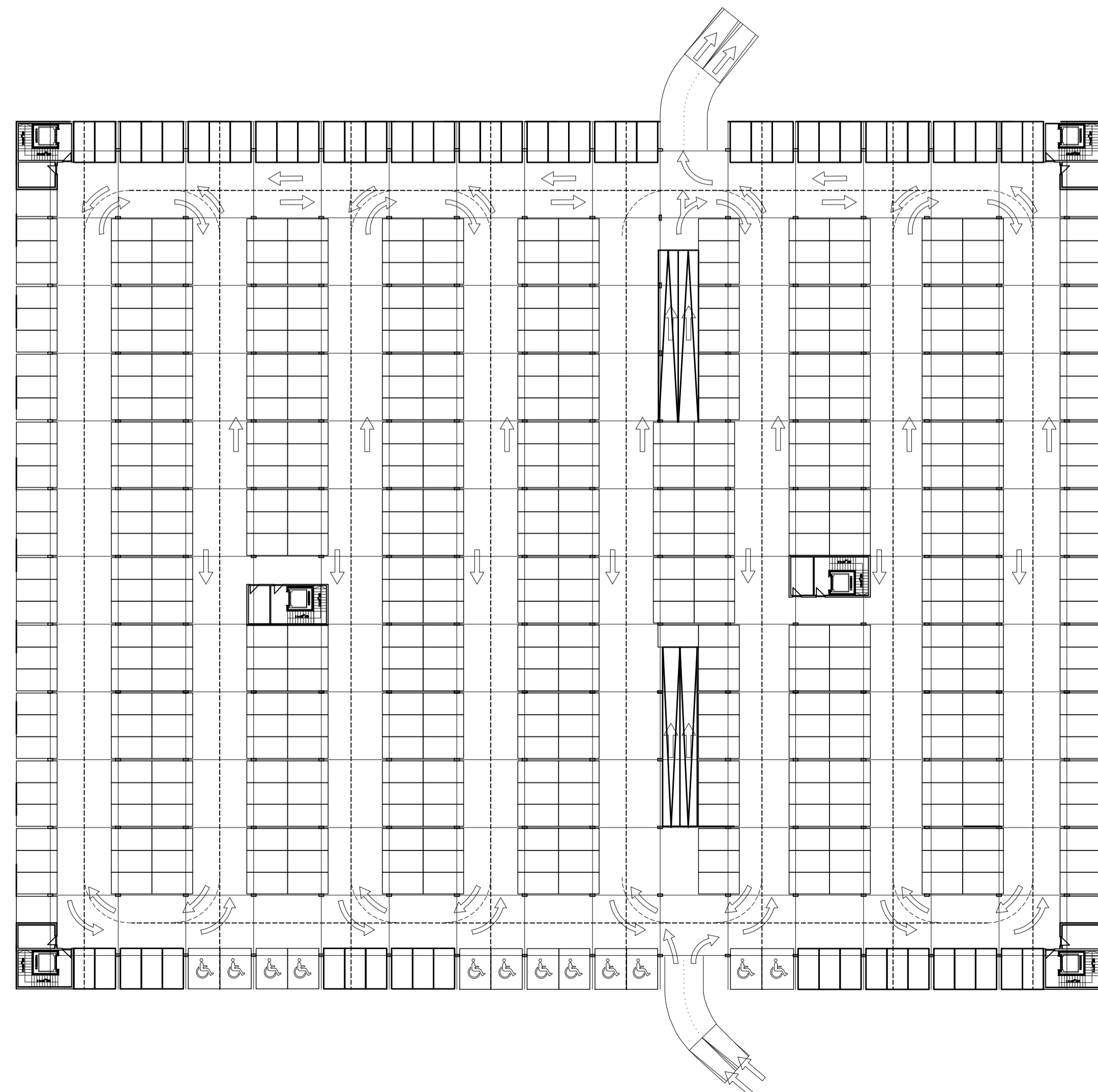

PARKING UNDER THE MAIN SQUARE - GROUND FLOOR LEVEL



Politecnico di Milano - Piacenza
 Facoltà di Architettura e Società
 Corso di Laurea specialistica in Architettura -
 Progettazione sostenibile di grandi opere

a.y. 2009/2010

thesis supervisor: arch. prof. Alberico BARBIANO di BELGIOJOSO

COMPLEX PROCESS FOR BIG SIZE PROJECTS. NEW
 MASTER PLAN FOR THE SCALO FARINI AREA IN
 MILAN. PEDESTRIAN AND VEHICULAR CIRCULATION
 SYSTEM AND CAR PARKING.

UNDERGROUND PARKING - -3.70 LEVEL FLOOR PLANS

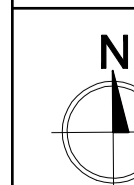

STUDENT:
 Pavlovic Boban 723543

22. July 2010.

POSTER
 5
 Scale 1:400