

CONNECTION there are two staircases, two elevators for handicap persons and two escalators which **CONNECT** the **GROUND FLOOR** directly to the level of **PINACOTECA**, in the first floor, without any interruption in

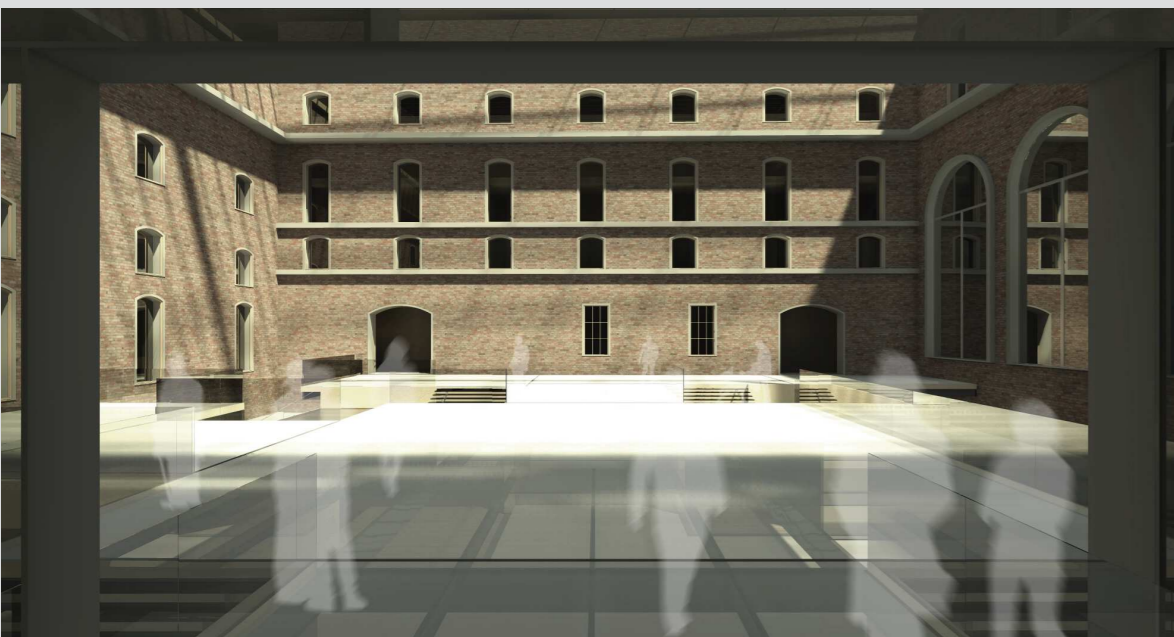

frontal view of the north existing facade from the vertical connection tower



view of the platforms and the vertical connection facade

the mezzanine which are accessible both by elevators and staircases. In that level, which is suspended like the other floors by cables, there are other two escalators which join this level to the last and **SURPRISING FLOOR : BELVEDERE**. This long path after a visual interruption right before arriving, which is caused

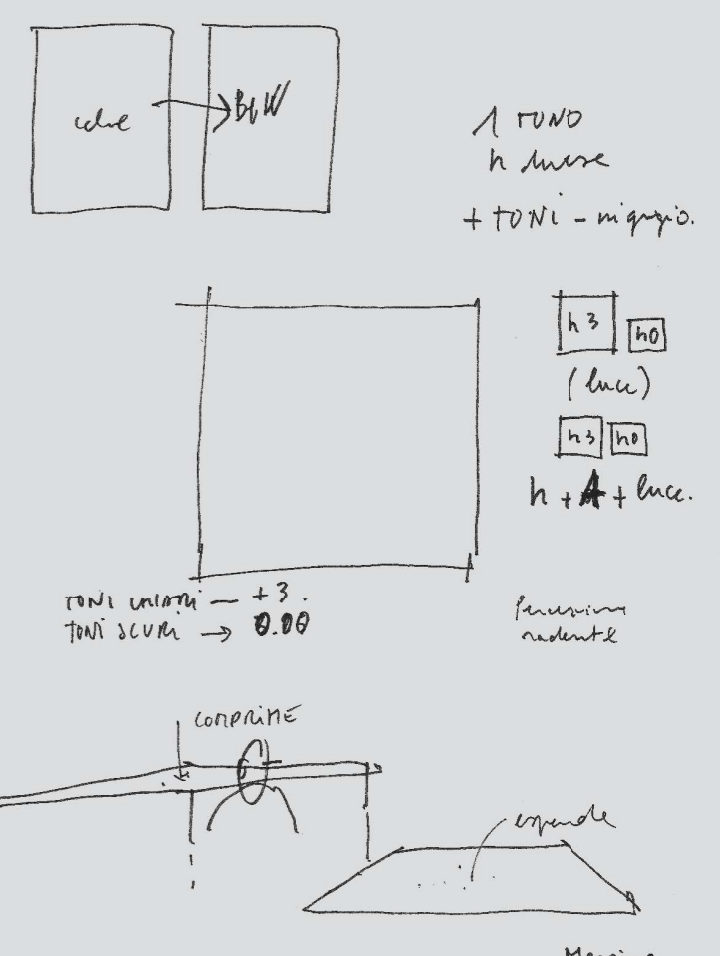

sketches about the colour of the surfaces according to the level

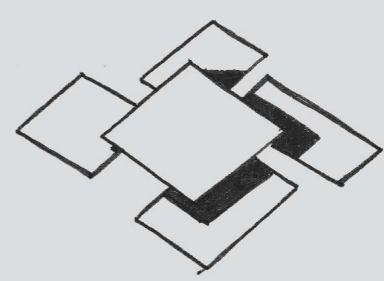

logo of the platforms

by two huge beams that they positioned for structural functioning, offers a **PANORAMIC VIEW** of the city through a huge parallelepiped **GLASS BOX** from which it is possible also to see the hanging roof of the Central Yard.