









CASA PANIZZA : Dispensa

PROCESSI DI DEGRADO RISCONTRATI:

-  Alterazione cromatica
-  Distacco
-  Efflorescenza
-  Lacuna
-  Patina biologica
-  Macchia
-  Frattura
-  presenza di impianto elettrico

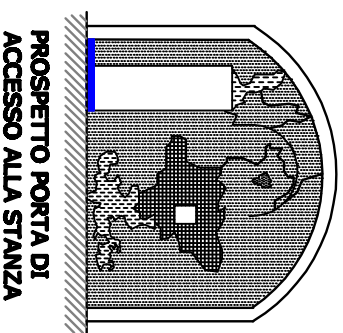
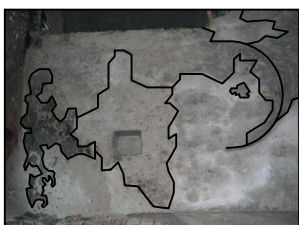

PROSPETTO PORTA DI ACCESSO ALLA STANZA

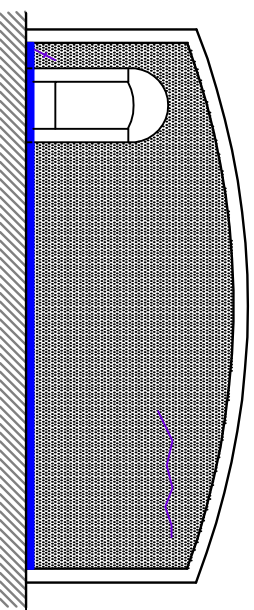

PROSPETTO DELLA PARETE CON VISTA SULLA VALLE

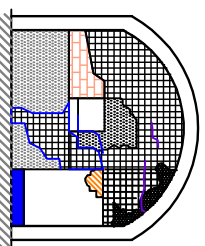

PROSPETTO DELLA PARETE CON LA PORTA MURATA CHE ACCEDE ALLA SCALINATA

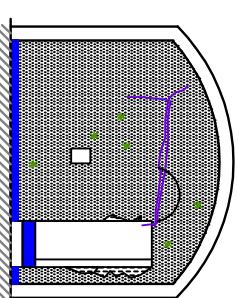

PROSPETTO DELLA PARETE DI ACCESSO ALLA STANZA ADIACENTE

0 100

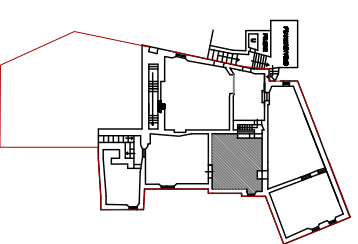

POLITECNICO DI MILANO
FACOLTÀ DI ARCHITETTURA V.O.
A.A. 2010 - 2011

TUTELA E RECUPERO DEL
PATRIMONIO
STORICO - ARCHITETTONICO

IL BORGO ABBANDONATO
DI BALESTRINO:

STUDIO DELLO STATO
DI DEGRADO E DEL RECUPERO
DELLA CASA - BOTTEGA
APPARTENENTE ALLA
FAMIGLIA PANIZZA

Relatore:
Prof. Amedeo Bellini
Co-relatrice:
Prof. Annamaria Cividini

Studente:
Monica Vittoria Crepaldi

STUDIO DEL DEGRADO
TAV. 3 E - Rif. Scheda N. 9 - 11

SCALA 1:100