

# Construction

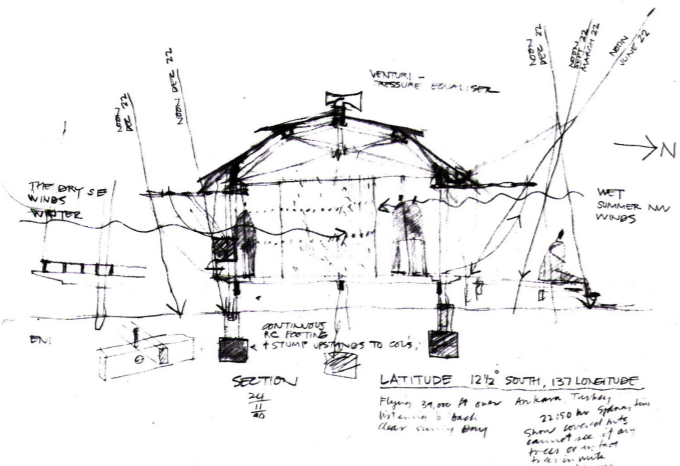

# Flexibility

Concept

The Aboriginal proverb taken by Glenn Murcutt is to emphasize his strong sensitivity to nature. Murcutt is used to place his works slightly raised above the ground allowing the passage of air and the natural cooling of the building.

# Prefab

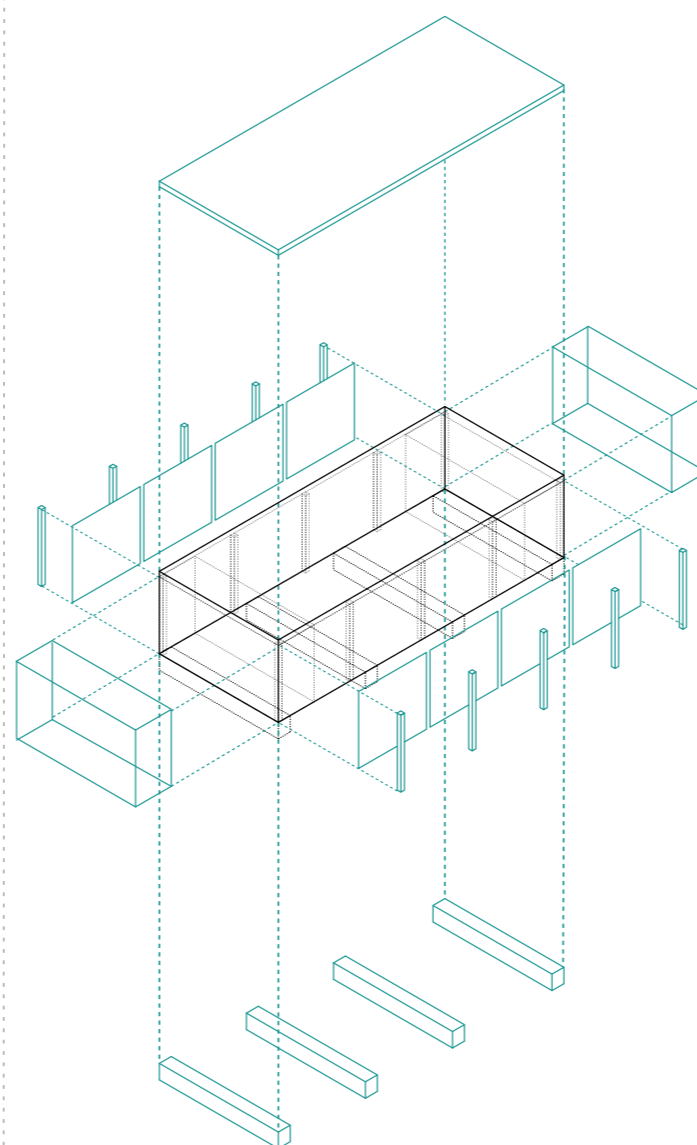

Element

# Prefabrication

Since the beginning when it was still a British colony the material were imported from the motherland and they needed to be easy to put together. Furthermore, even after being self-sufficient, the prefabrication helps to build in areas in which because of the big distances and the lack of raw materials was impossible to build before.

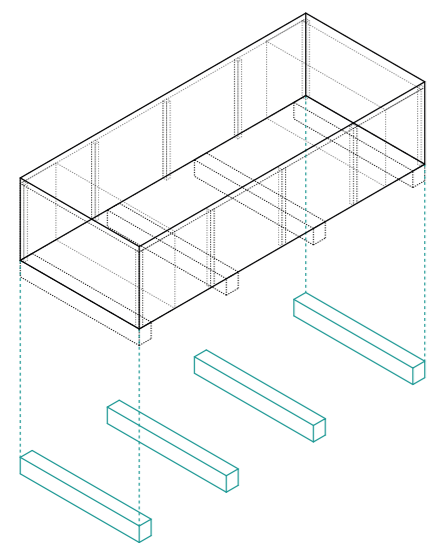
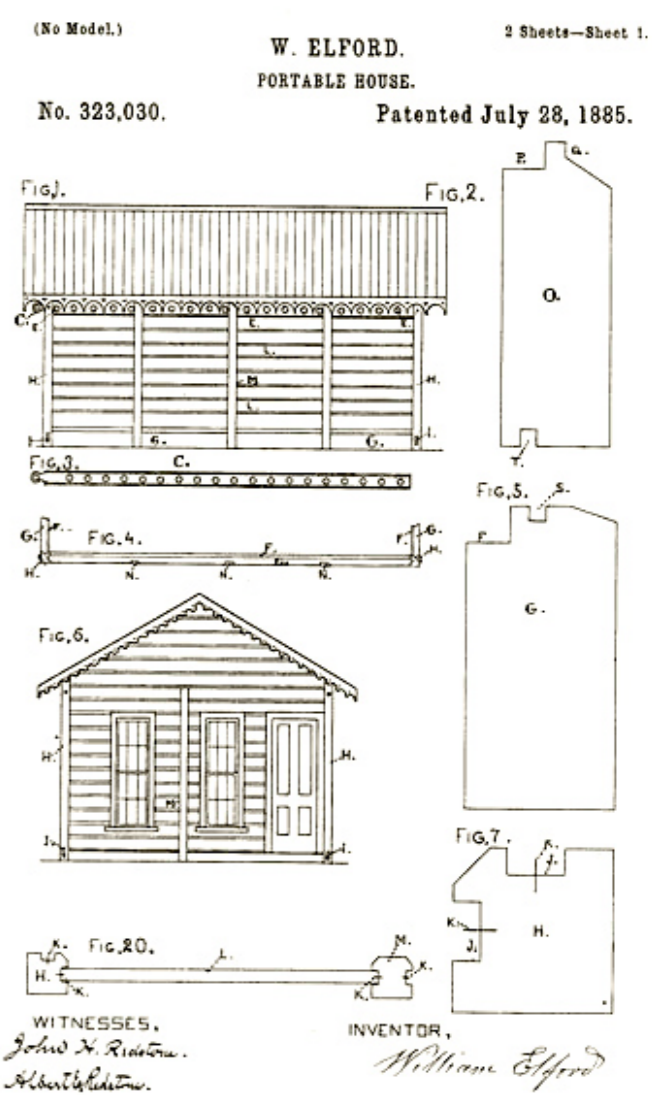

# "Touching the earth lightly"

Concept

# Active facade

"It connects the indoors with the out, a non-constant architecture that responds to the morning, the evening, the season, the heat, the cold, the sun, the rain the moment that will never pass again" - Troppo Architects

# Active facade

Element

# Corrugated iron

Element

# Corrugated iron

Used since 1850 to build the prefabricated house called "portable house" imported from England like the Bellhouse and Abercrombie house in Melbourne was left apart because of the high temperature reached in summer and the low temperature in winter. However today it is still used thanks to its lightness, cheapness and the easy transportation as a roof cover or for gazebos and verandahs.

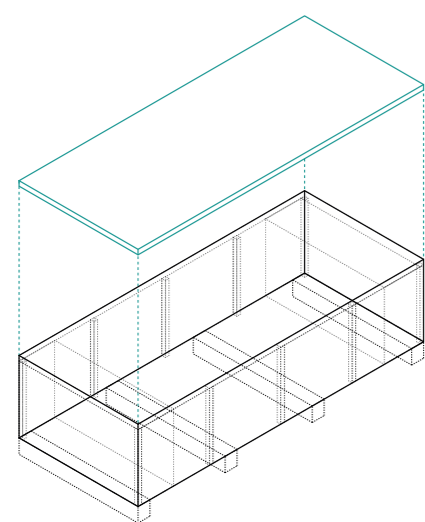
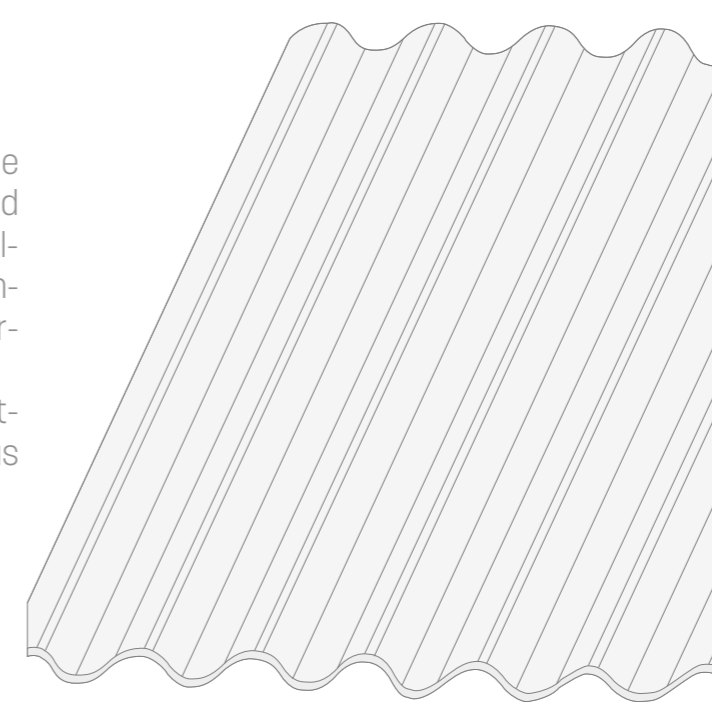

# Roof

Element

# Roof

For the aboriginal culture the roof is the most important element of the house and there is no division between interior and exterior but just the concept of shelter.

# Verandah

Element

# Verandah

At the beginning the verandah was put on the entrance of the house as a protection from the sun and filter for guests. Murcutt and Godsell reuse the verandah according to the orientation and as a filter from the interior to the garden.

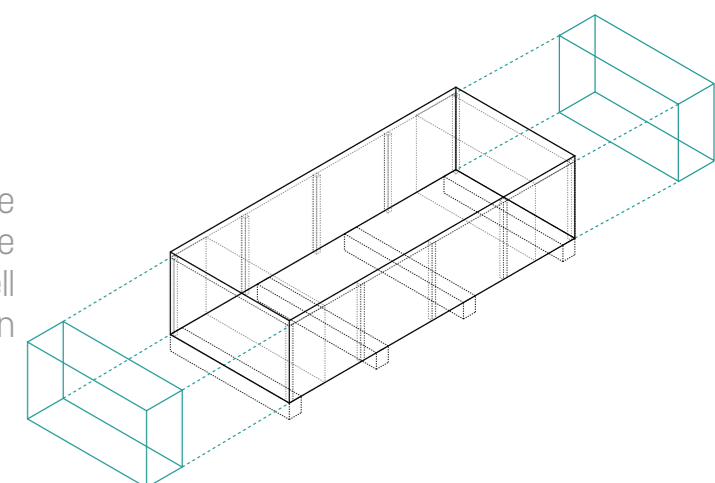

# Glenn Murcutt

Architect

The man does not own the land that lives but he is its guardian and tutor. Concept of transience and consequent use of materials "able to return to the land"

During the project the only invariants that can be considered are the Climate and Topography.

In European culture the outside comes in opposition with the domestic space while the Australian culture, linked to the Aboriginal, does not see this separation but a continuum, the spaces are in continuity with each other, there is not stasis but movement.



Glenn Murcutt use a reference for his projects industrial and agricultural constructions like storehouses, greenhouses and woolsheds.

# Romantic austerity

Concept

Wood  
Murcutt usually use two different kinds of wood: HOOP PINE for walls and ceilings and BRUSH BOX for the floor, parquet.

**BOX GUTTER**  
It's a typical gutter taken from woodsheds which is designed flat and it drains on the edges.

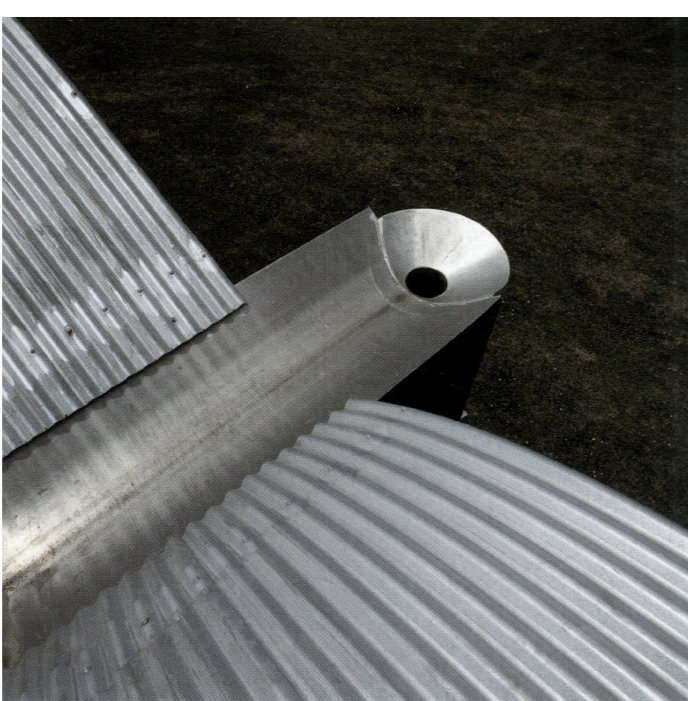

**LIGHT and VENTILATION**  
Murcutt leave a space between the ceiling and the wall to let the natural light to go through and the natural ventilation. He also usually leave a space under the roof for crossing ventilation.

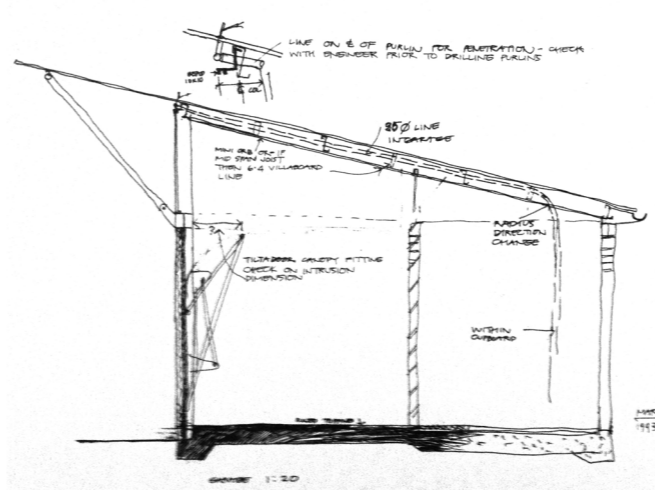

# Magney House, Paddington, Sydney

The commintent ask to have the concept of the vacation house but inside the city district of Paddington in Sydney. The house seems inside the nature and there's no feeling to have neighbours. The walls are red as the typical red sand of the Australian outback. The entrance is in a lower level and it helps the entrance of the sun light and the crossing ventilation.

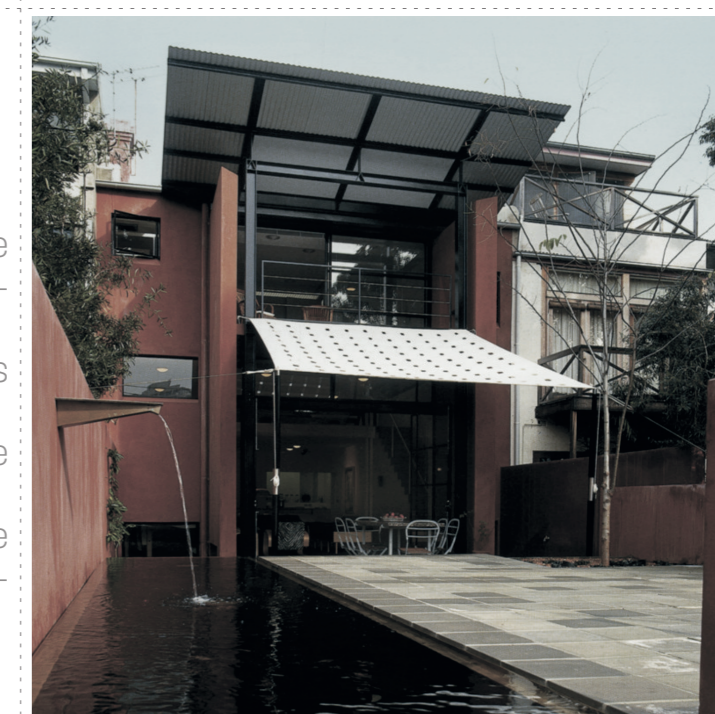

# Sean Godsell

Architect



"investigation into the similarities between the enclosed verandah of the traditional Japanese house and the 'sun room' of the Australian house. My interest lies in the iconic nature of these elements to both cultures - Asian and European - and the common architectural ground which they afford to the region."



"The universal nature of the container means that the houses can be stockpiled and easily transported throughout the world. The need to 'house', born out of the adversity of war offers for architects the opportunity to provide shelter for fellow human beings in need. To that end our building provides: flexibility, mobile + reusable, minimum site impact, solar power + passive solar design, recycled materials."

Philosophy

# Troppo Architects

Architect

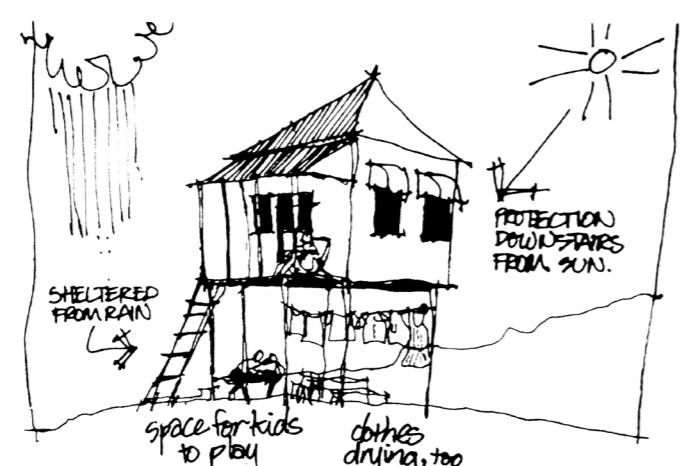

"The phrase "going troppo" means to be "heat affected", a little mad in the heat of the tropics; but the two architects who went "troppo" became acclimatised and they understood the place." They brought the idea of climate, region history, context and formal variety in the Northern Territory architecture.

Philosophy



# the Green can

Concept

**HEARING THE RAIN**  
take advantage of the natural elements  
**TRANSPORTED MATERIALS**  
corrugated iron, steel framing, plywood timber panels, fibre cement sheet, louvres, and the idea of the building as a prefabricated kit of parts, freely assembled and disassembled.  
**HOUSE AS COMPOUND**  
houses that grow, hybrid idea of extendable space, free flow of air, the idea of the house as village.  
**THE ADJUSTABLE SKIN**  
**THE INSIDE-OUTSIDE HOUSE**  
**THE TENTH LINE**  
space is extendable, infinitely adjustable.