

TORRE VELASCA
 altezza: 106 m
 in piano: 26
 progettista: GEMFR
 anno: 1958

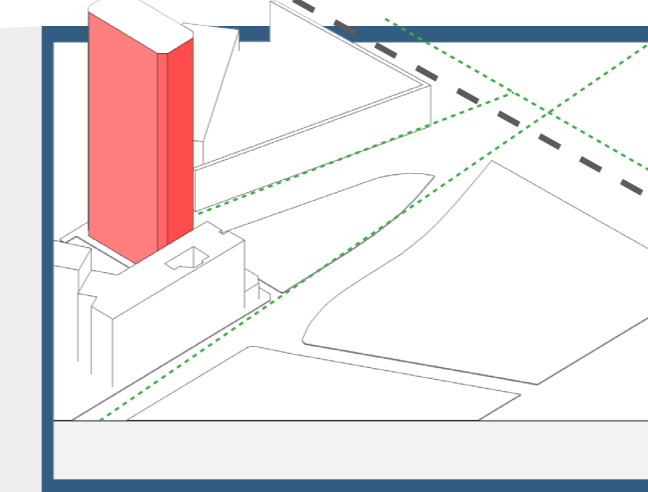

TORRE DI PORTA ROMANA
 altezza: 89 m
 in piano: 23
 progettista: P. Cossali
 anno: 1962 - 1963

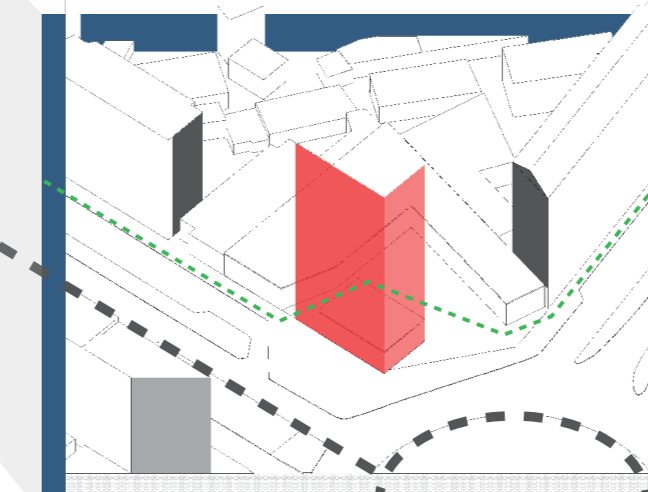
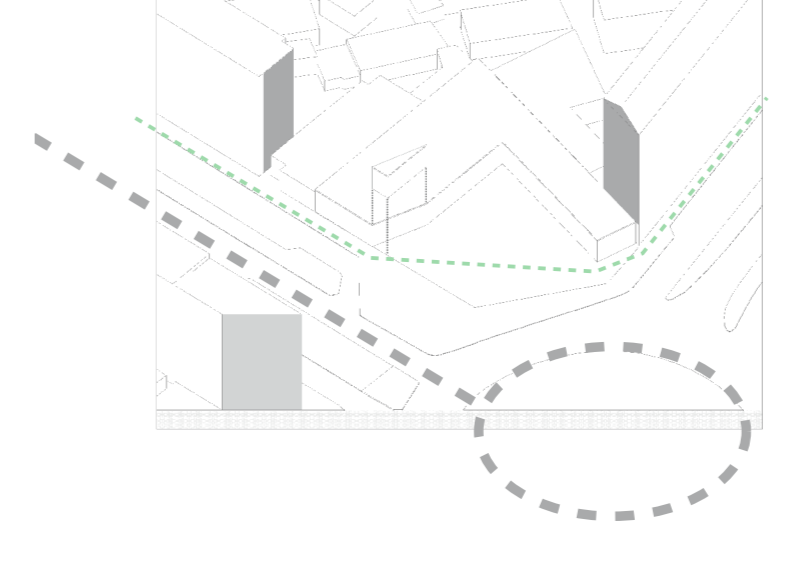
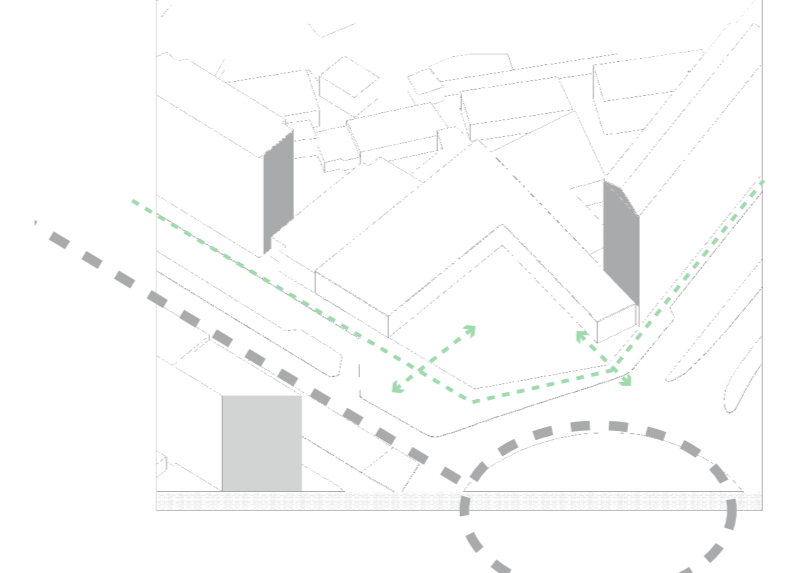
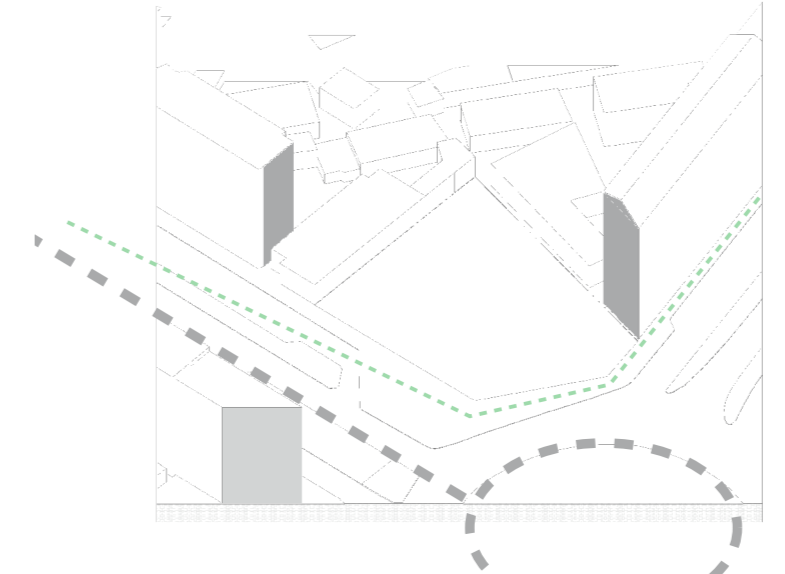

PLANIMETRIA GENERALE DI MILANO
 1: 5000
 Asse di Corso Lodi - Porta Romana



Piano Beruto_1885

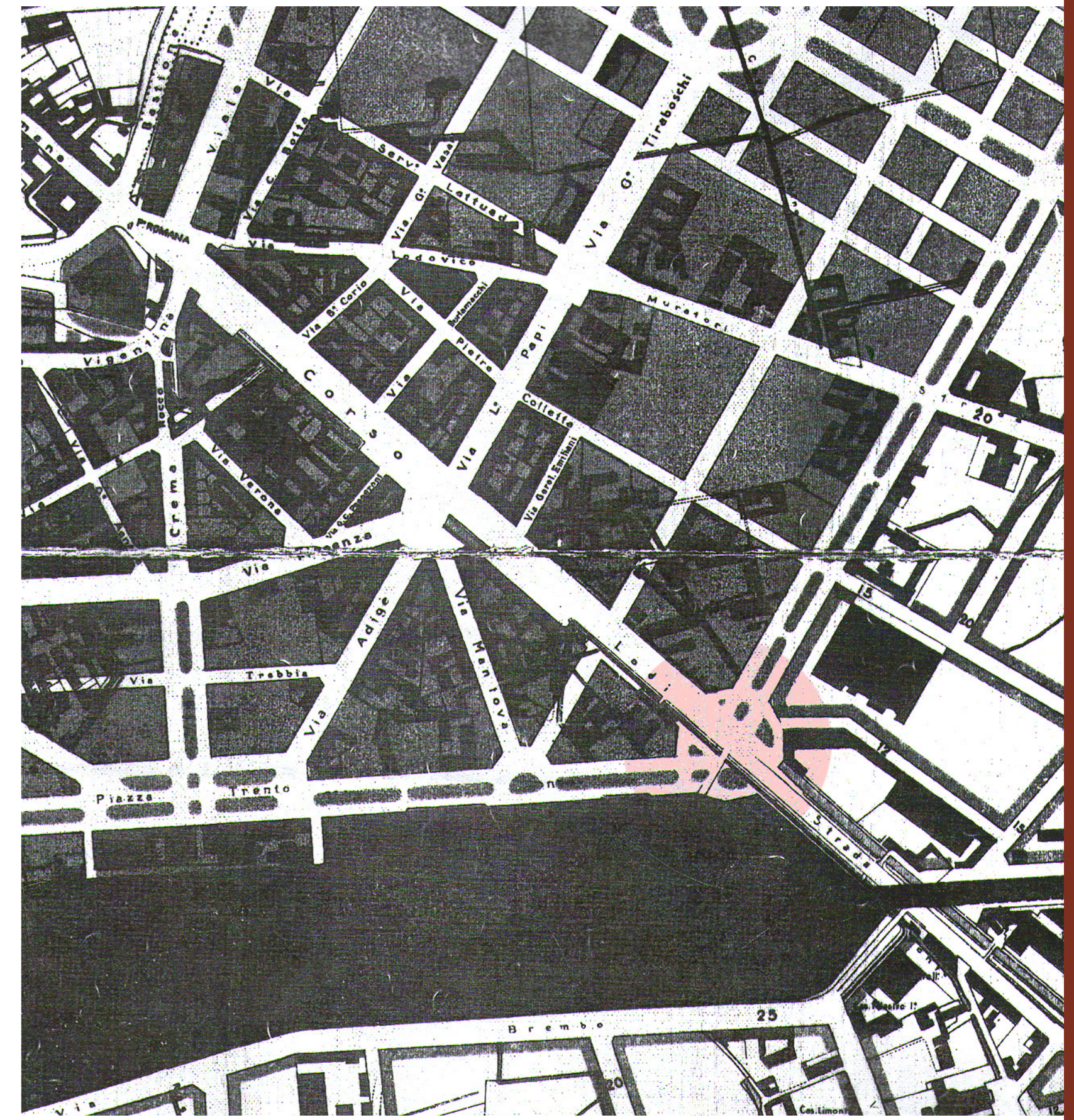

Piano Pavia - Masera_1910

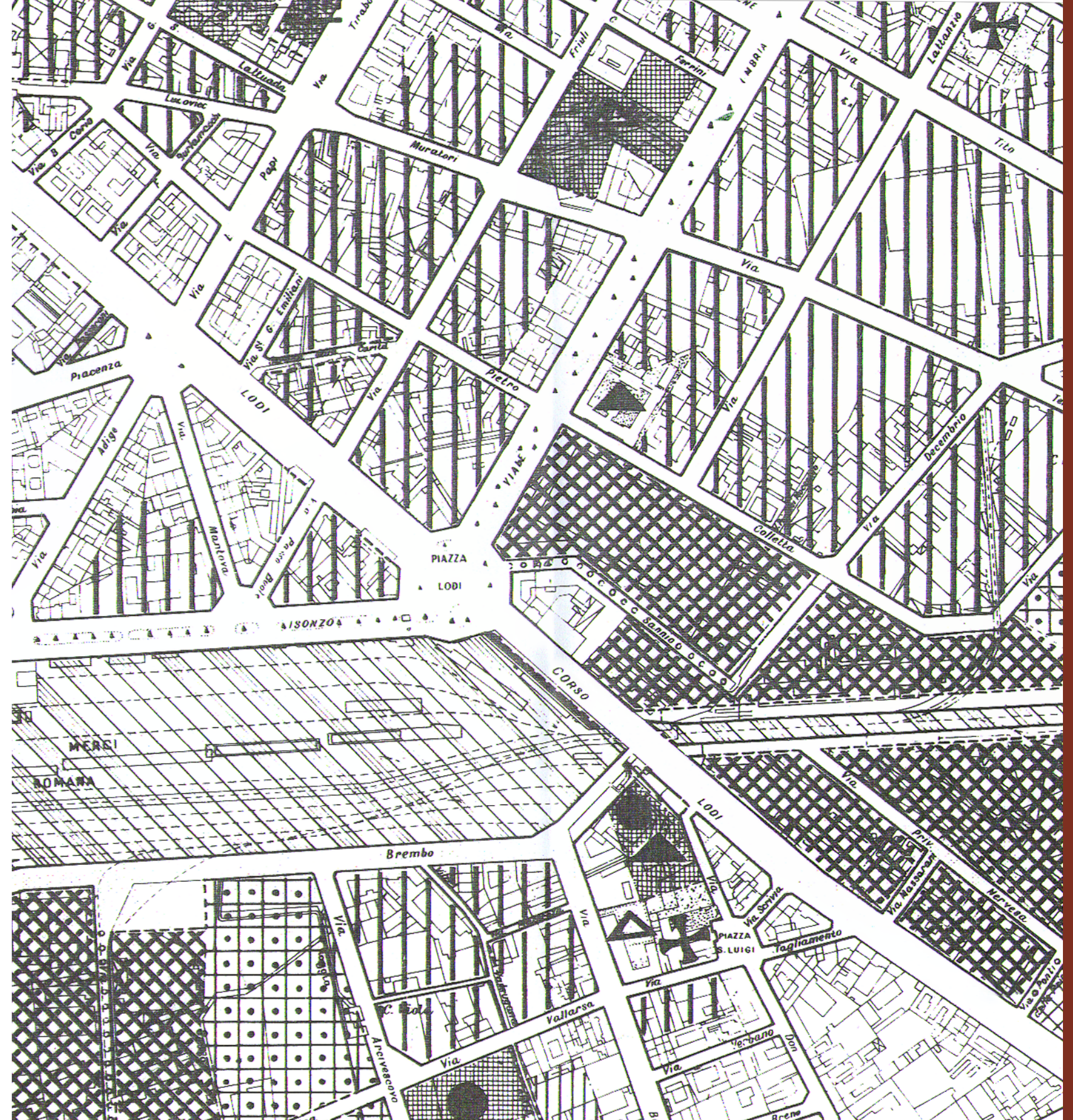

CTC_1986