

SYNTHETIC DESCRIPTION



GRID



INFRASTRUCTURES



RIVER MORPHOLOGY



BUILD UP SPACE



VACANT AREAS



URBAN FABRIC TYPE
colonial-era block

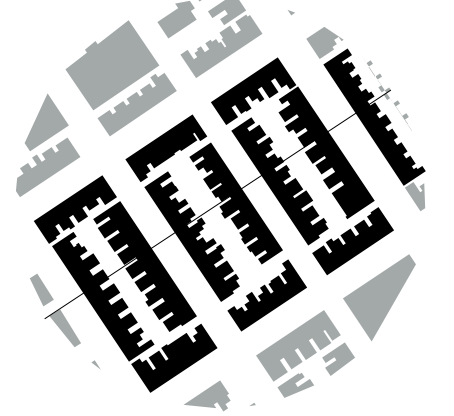

URBAN FABRIC TYPE
industrial-era block Philadelphia

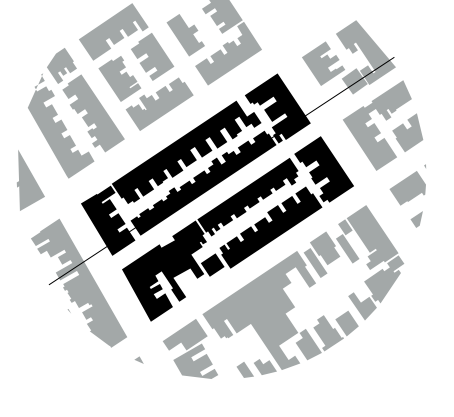

URBAN FABRIC TYPE
industrial-era block Camden

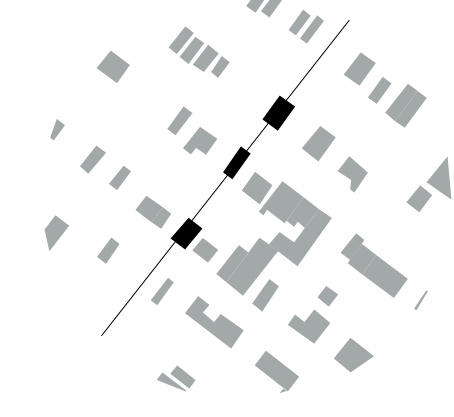

URBAN FABRIC TYPE
diffused city Camden



URBAN FABRIC TYPE
industrial block Camden



LANDUSE DESCRIPTION

- residential
- industrial
- commercial

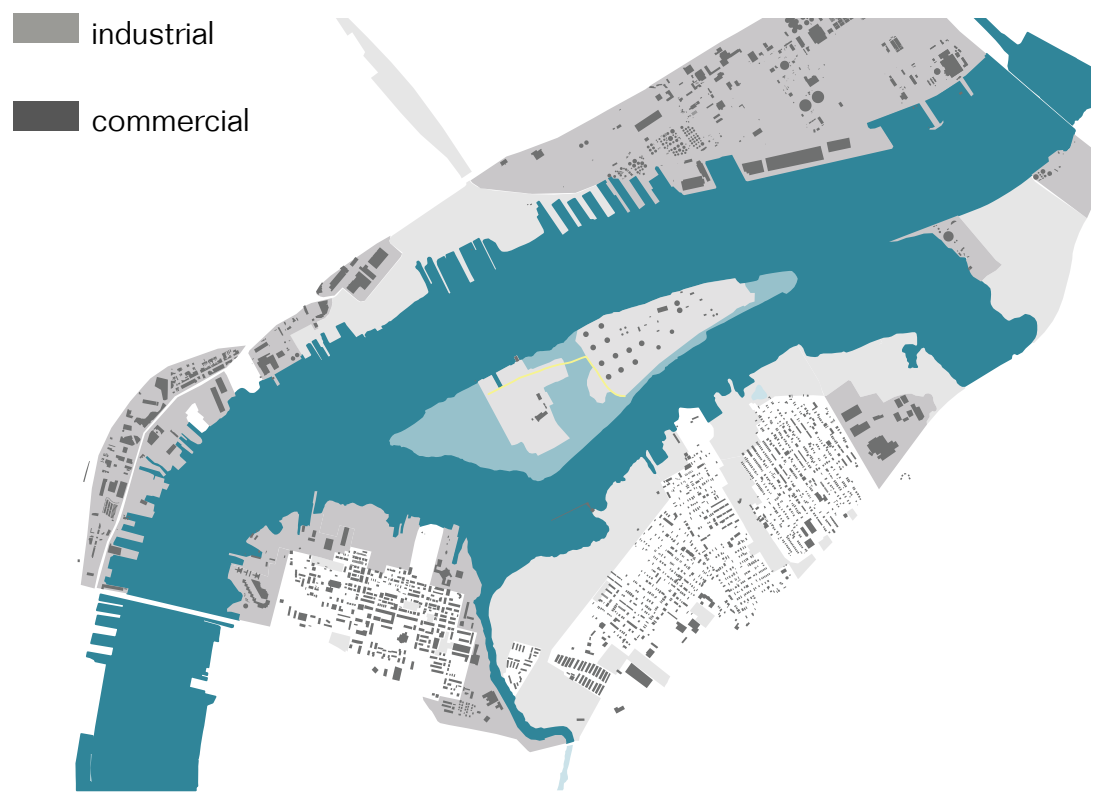

VACANT LAND

- semi-abandoned
- abandoned

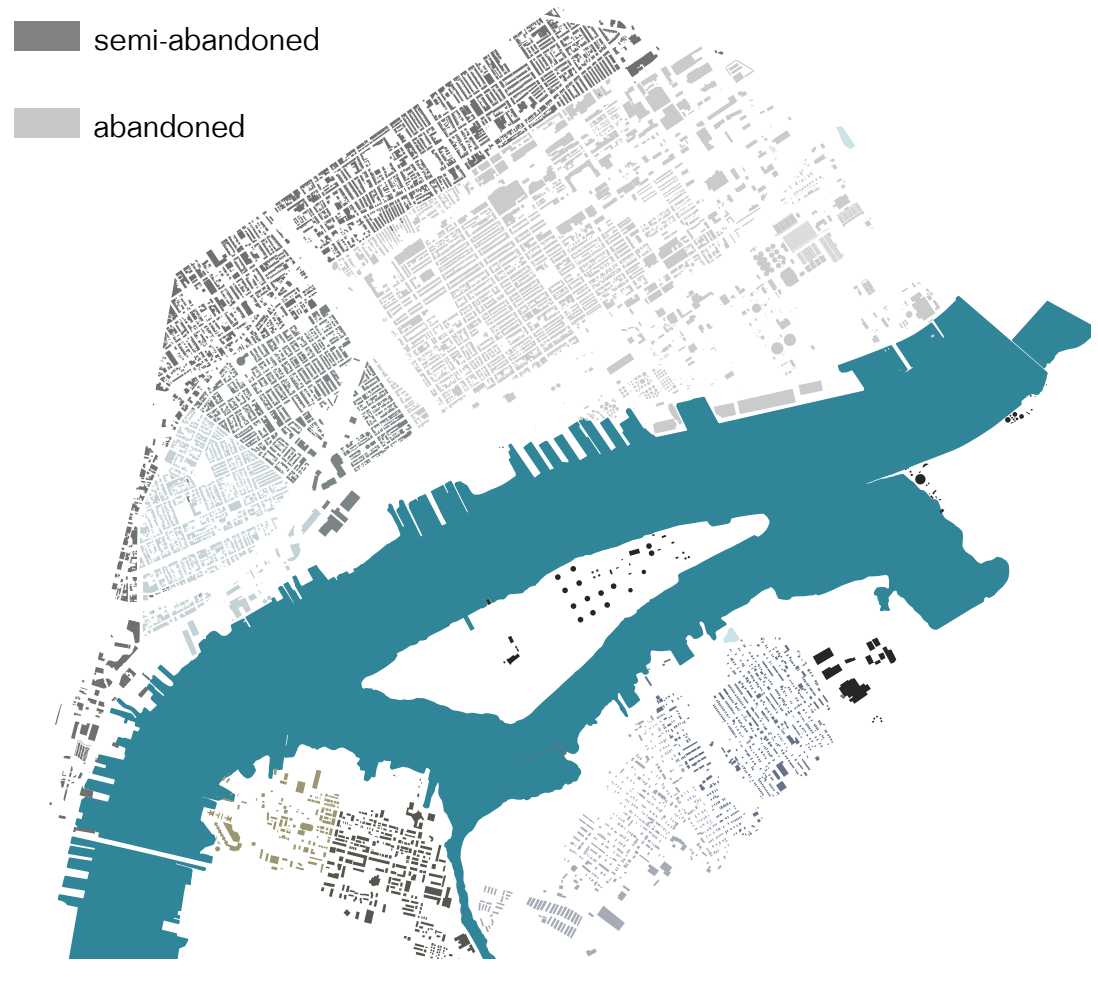

POLITICAL SUBDIVISION AND POPULATION

Cooper point	12,793 in.	area 0,6	kmq
Pyne point	5,591 in.	area 1,19	kmq
Cramer hill	4,460 in.	area 1,62	kmq
Biedman	5,600 in.	area 1,32	kmq
Pennsauken Township	35,885 in.	area 31,281	kmq
Port richmond	34,128 in.	area 9,01	kmq
Fishtown	15,970 in.	area 1,17	kmq
Olde richmond	30,227 in.	area 1,30	kmq

HISTORICAL DEVELOPMENT PETTY ISLAND



1894 Farms and Residential development

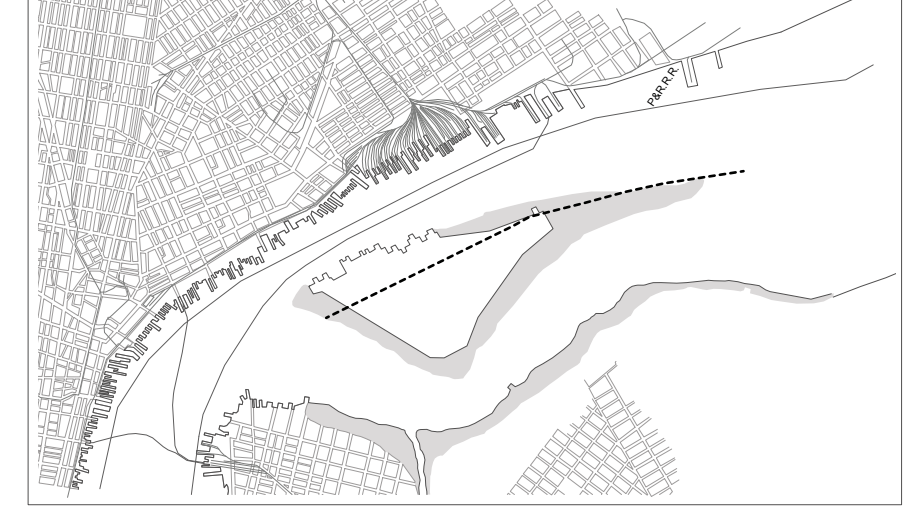

1894 Navigation improvement project



1898 New residential development on remodeled island



1924 First railway connection on the island



1928 First industrial settlements on the island

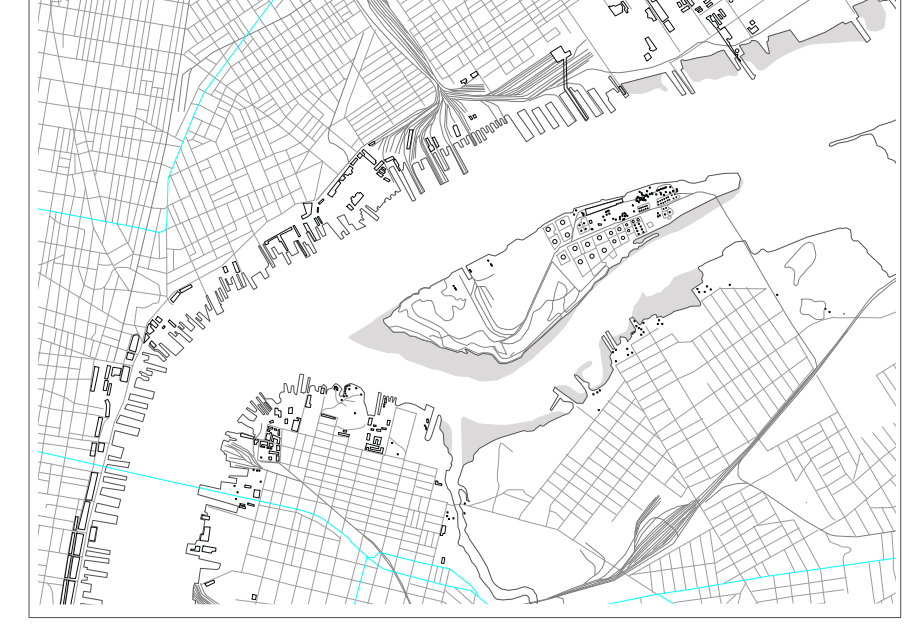

1958 Industrial development on the island