

- FORUM TRANSITORIUM NERVAE -

L'ARGILETUM, IL PERCORSO ARCHEOLOGICO DI CONNESSIONE TRA IL FORO ROMANO E I FORI IMPERIALI

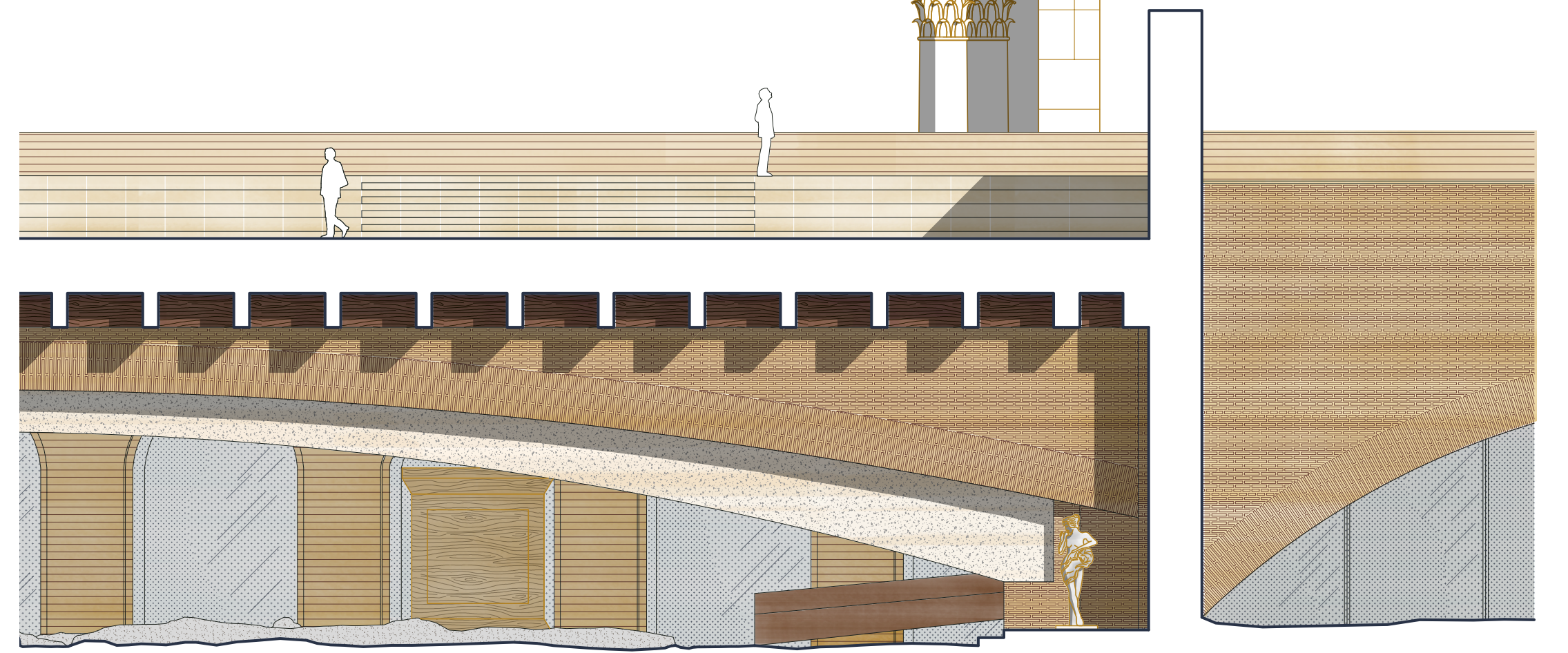

*immagine X, XI, XII, XIII. RIDEFINIZIONE DEI LIMITI - pianta e sezione trasversale, scala 1:100*

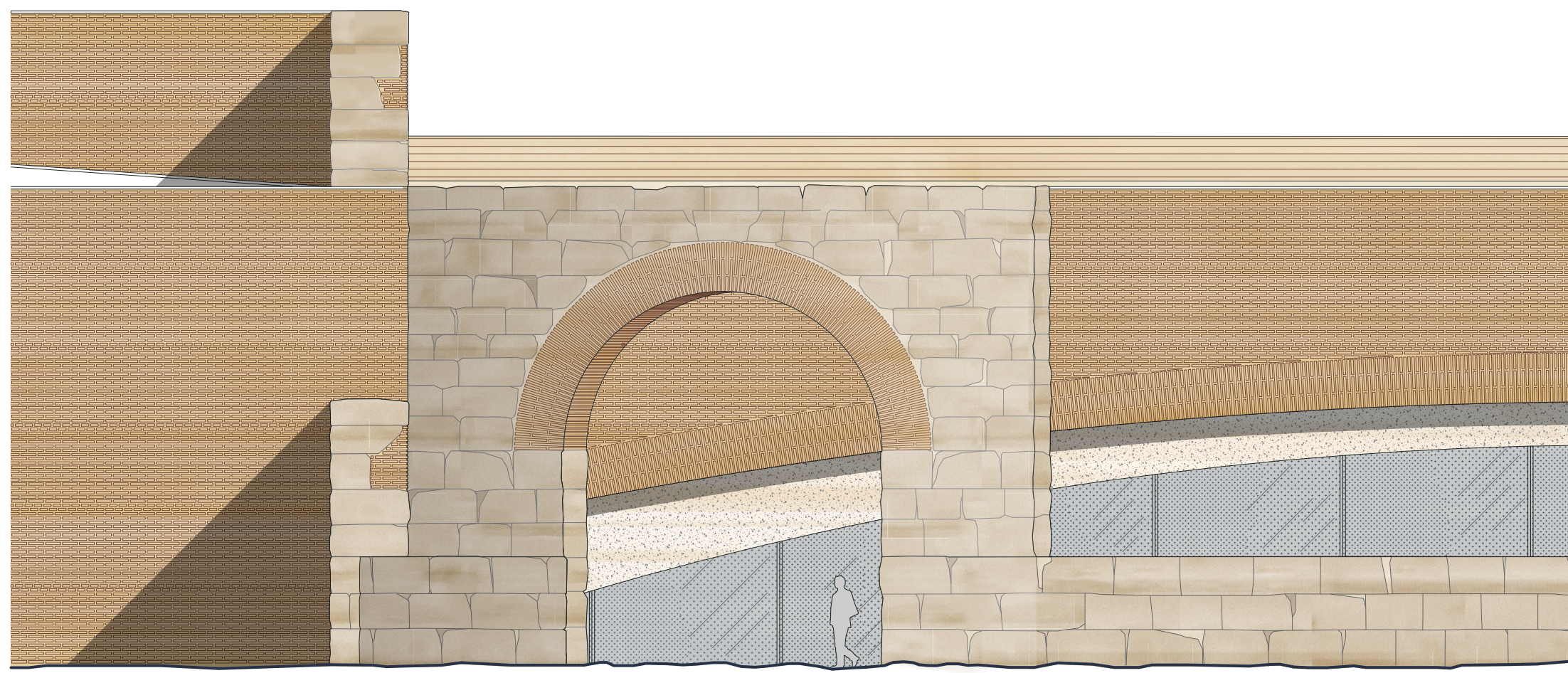
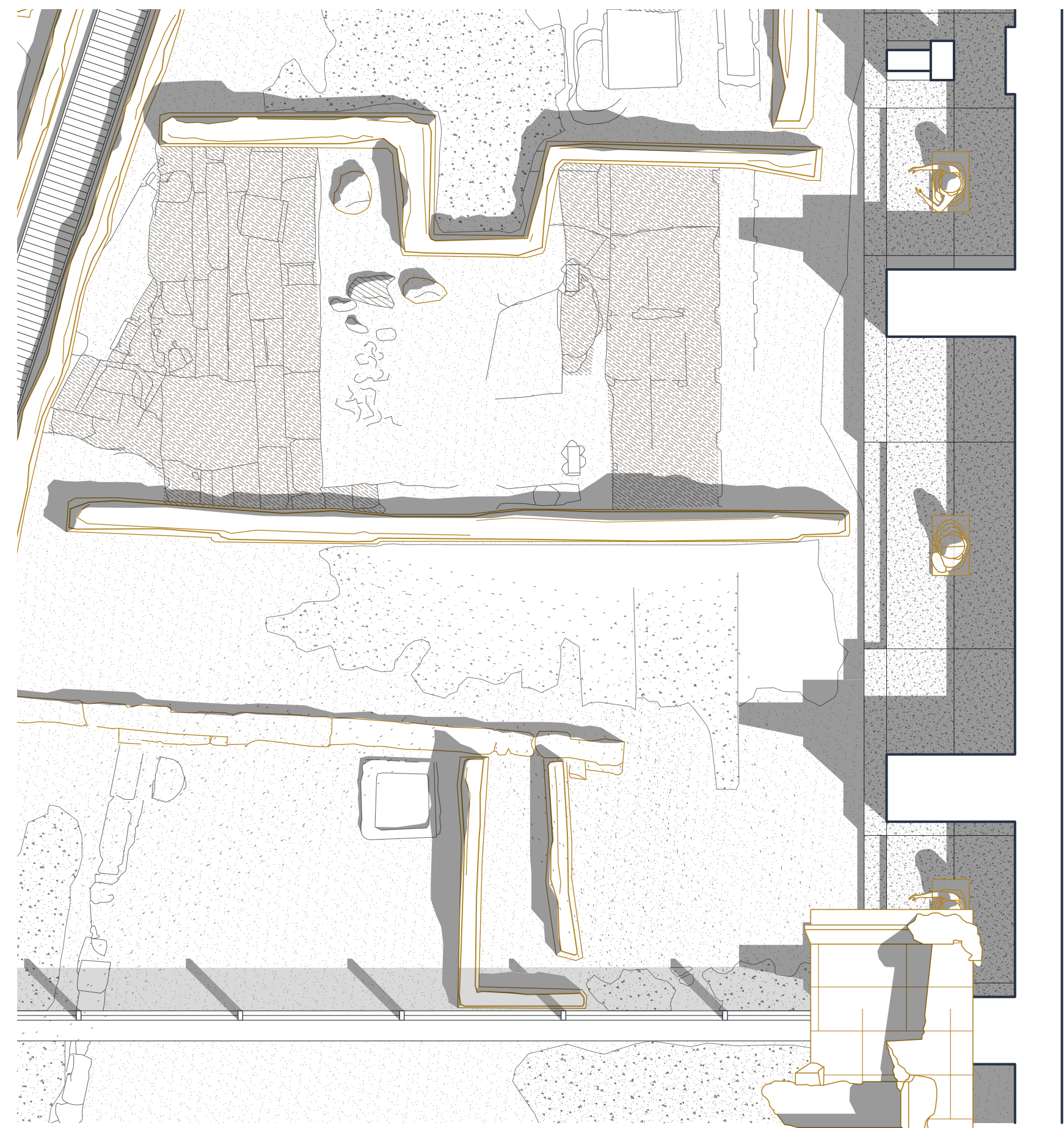
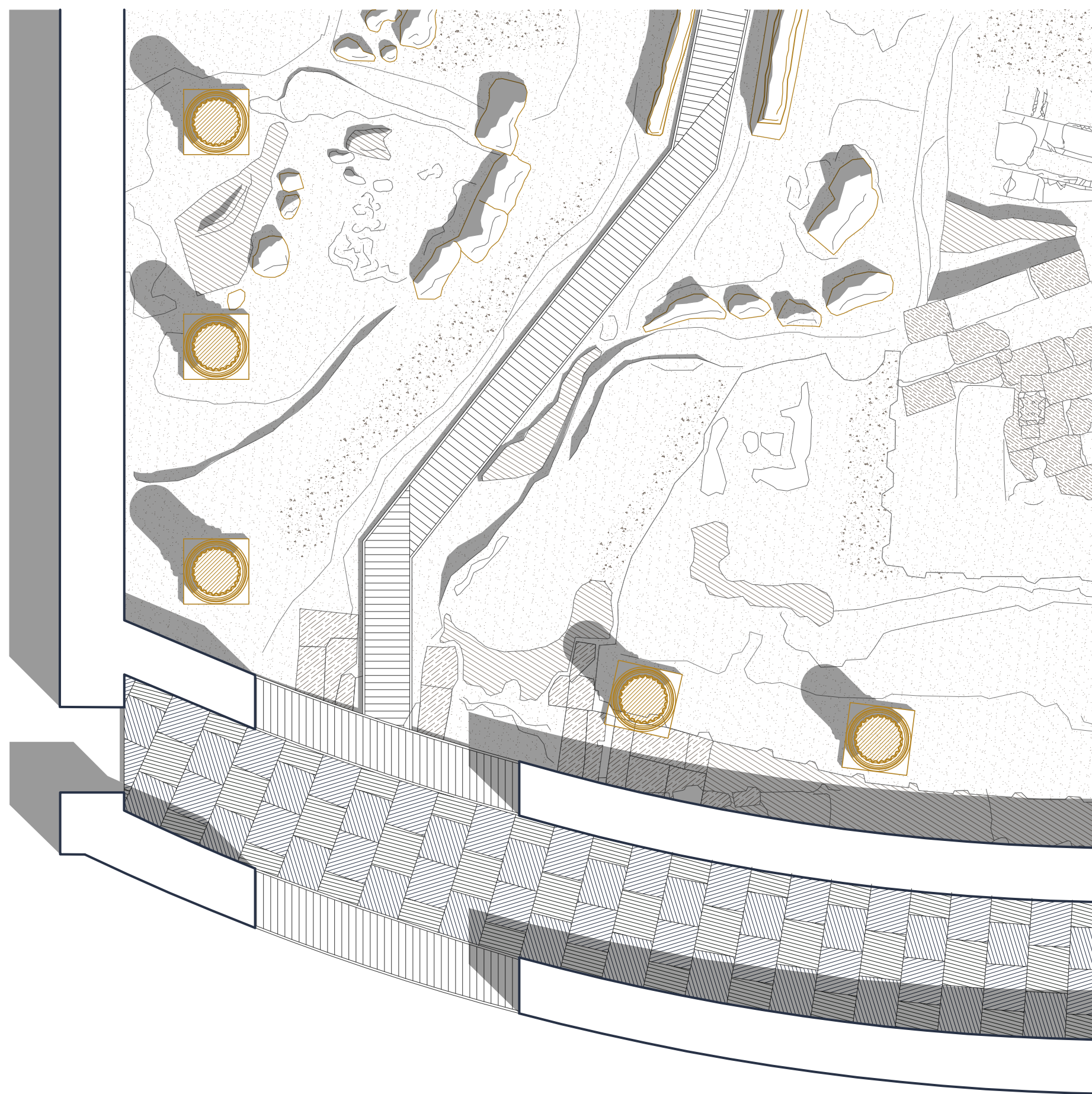
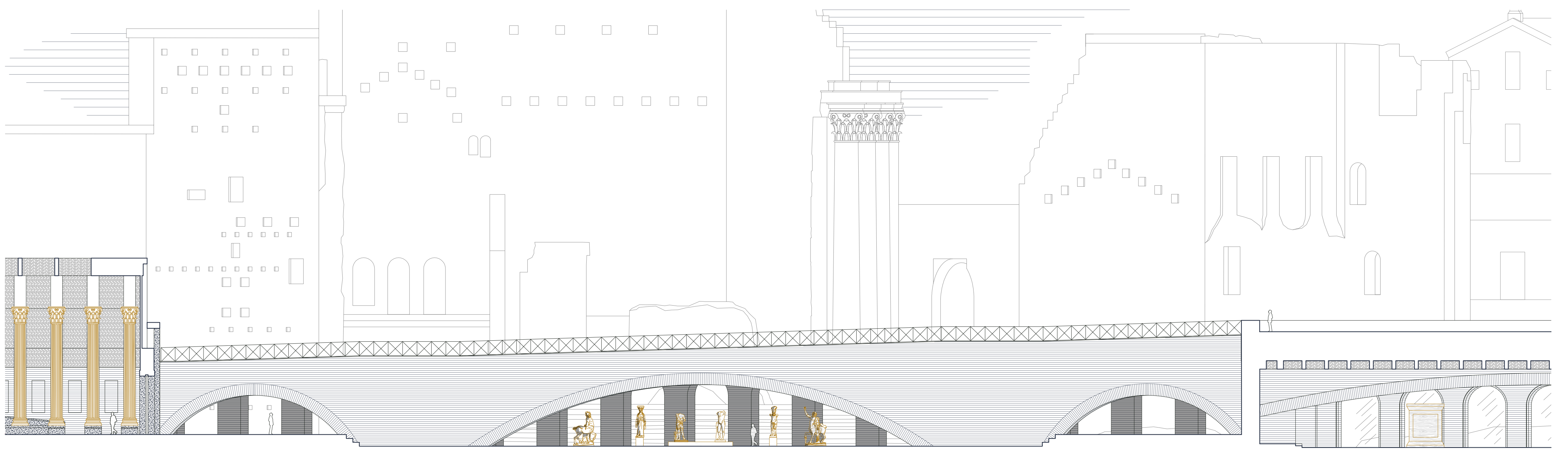

*immagine XIV. LA VIA ALESSANDRINA COME PORTICO ANTIQVARIUM - sezione trasversale Foro di Augusto, scala 1:200*

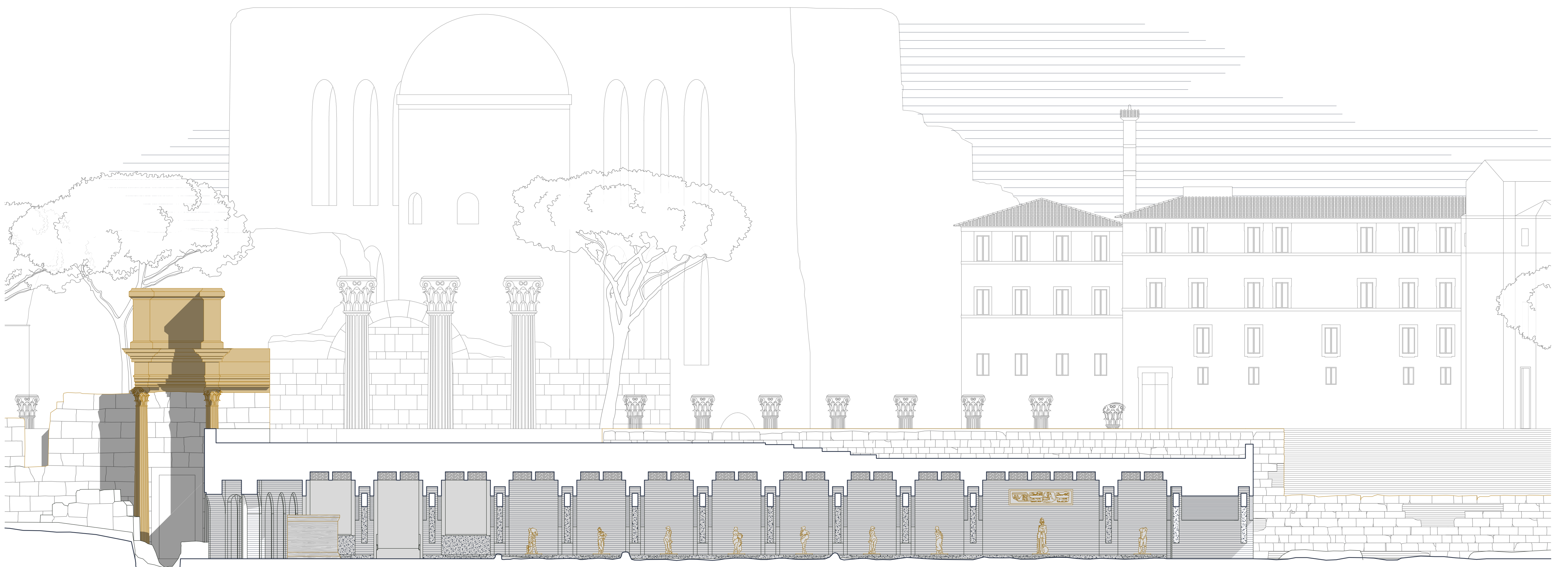

*immagine XV. RIDEFINIZIONE DELLA CONTINUITÀ SPAZIALE - sezione longitudinale, scala 1:200*