

5. Pianta a quota +58,5m
copertura; passerella panoramica

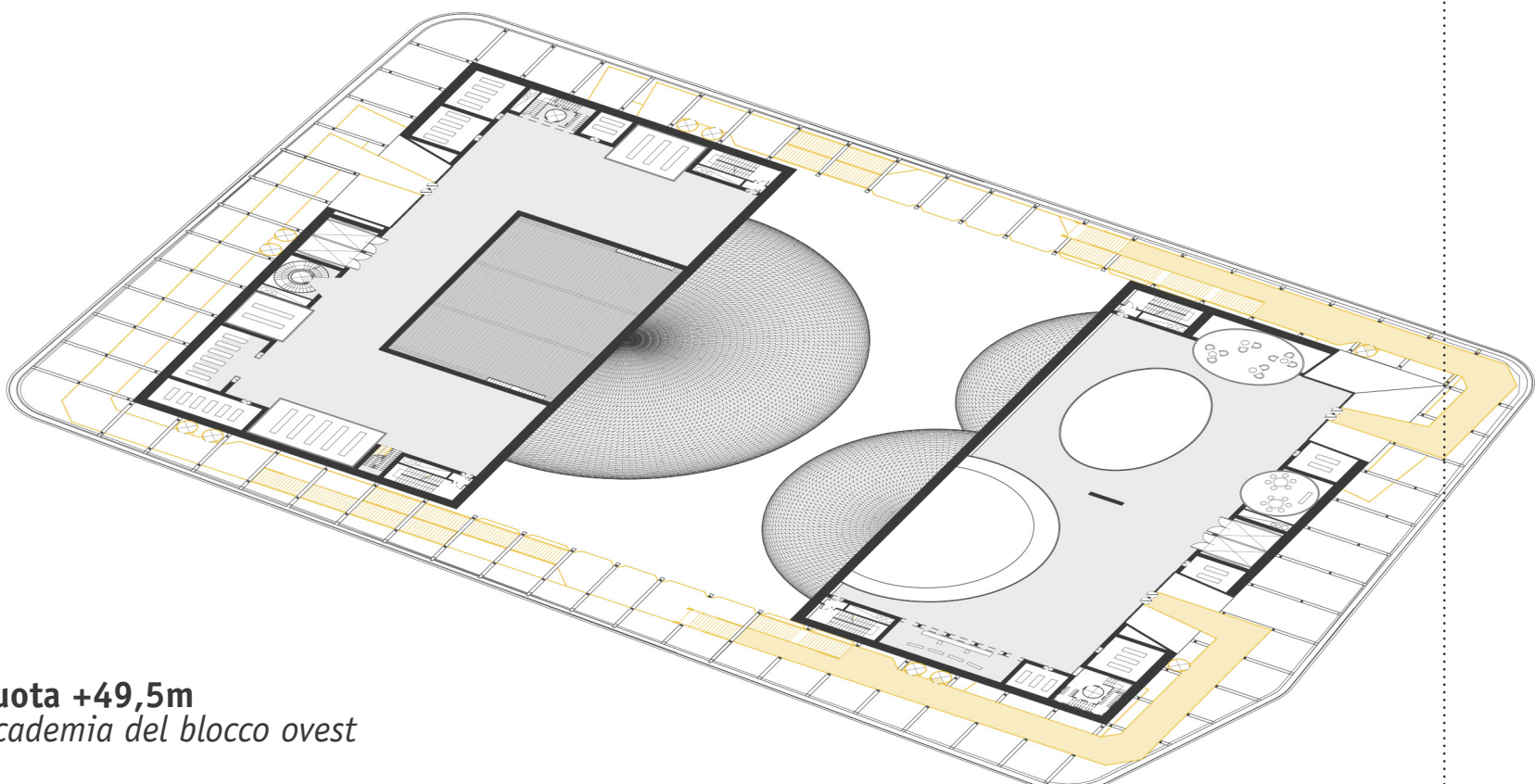

4. Pianta a quota +49,5m
ingresso all'accademia del blocco ovest

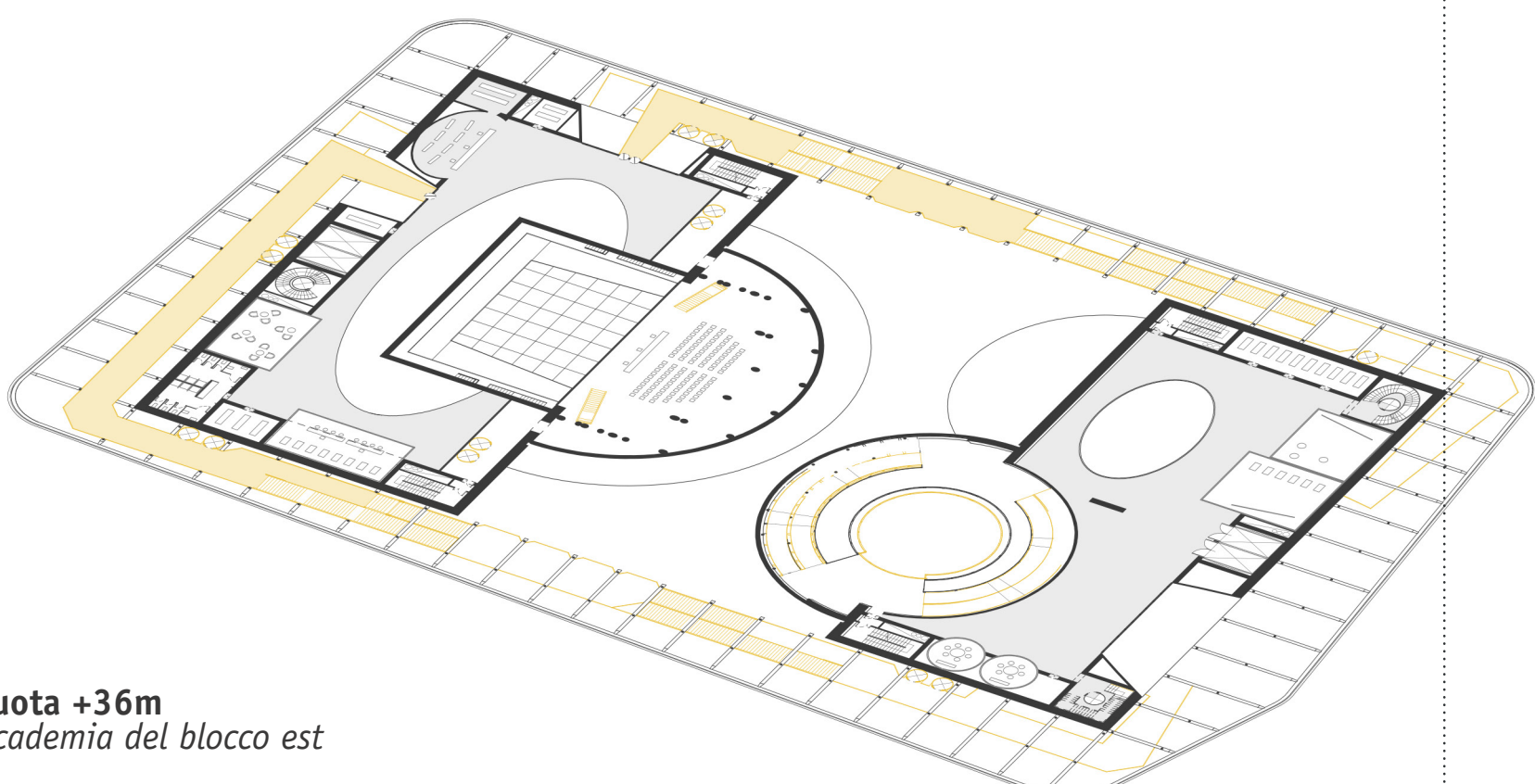

3. Pianta a quota +36m
ingresso all'accademia del blocco est

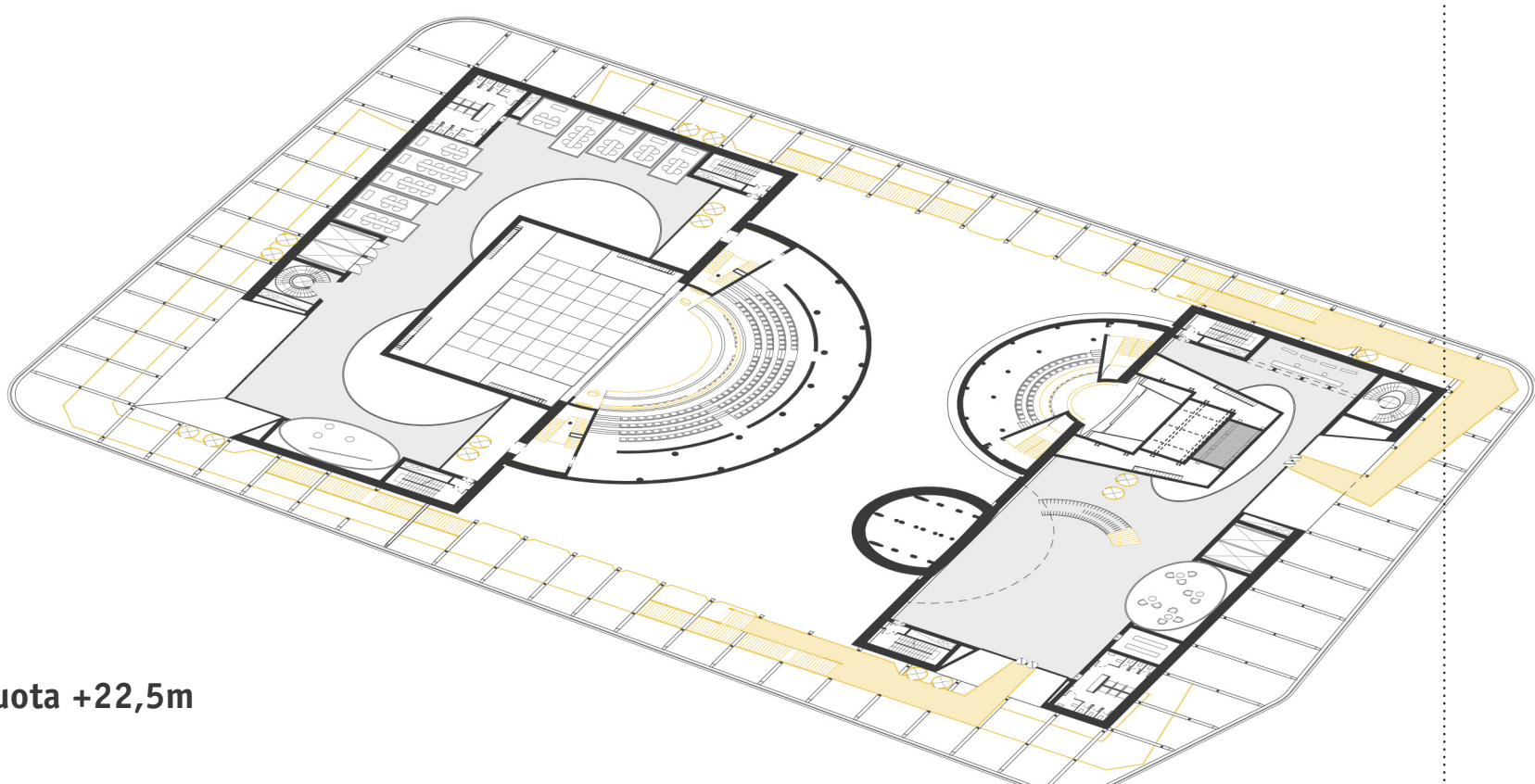

2. Pianta a quota +22,5m
foyer sala M

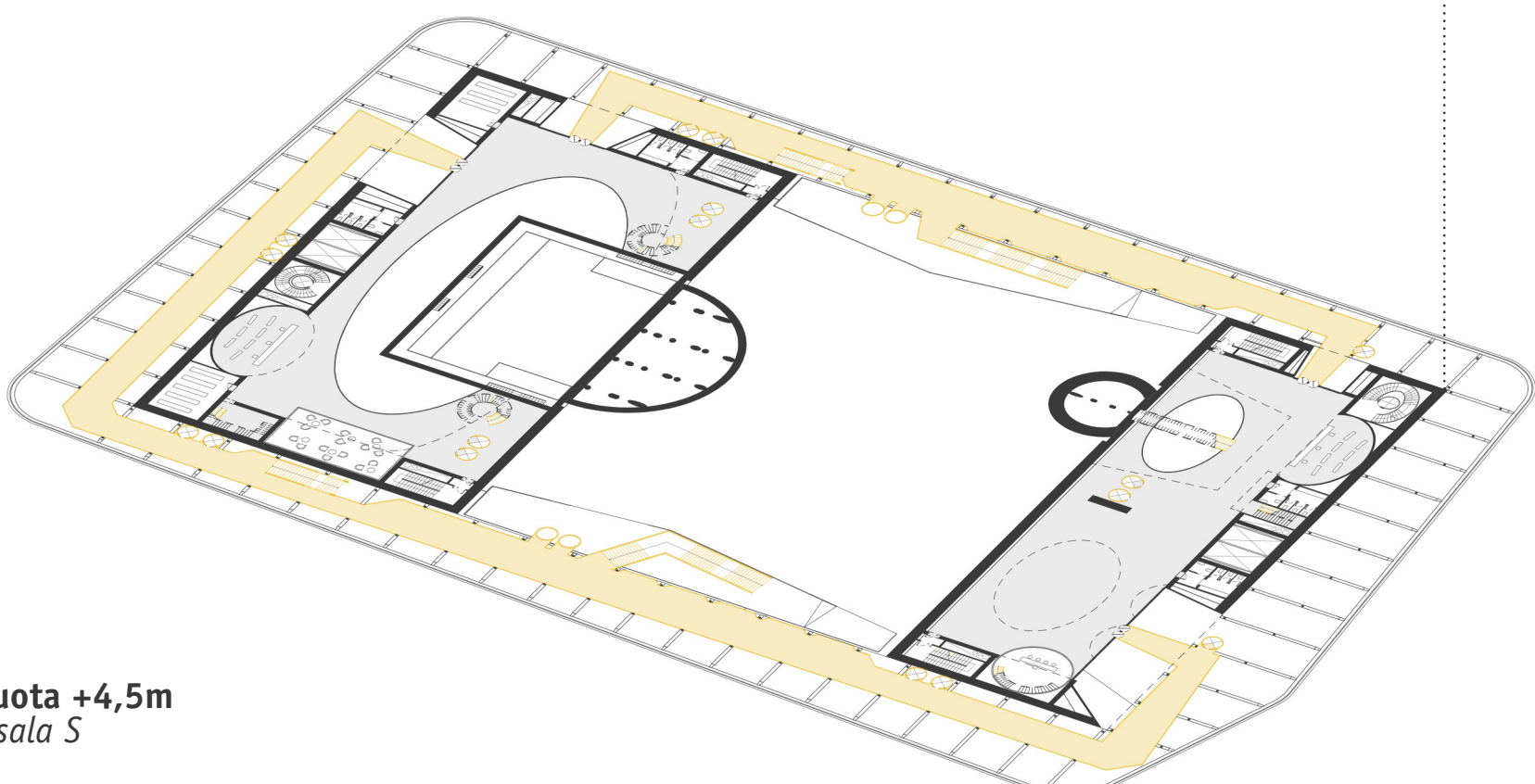

1. Pianta a quota +4,5m
foyer sala L e sala S

Sezione schematica
flussi (arancione: pubblico, giallo: tecnici) e funzioni principali

m
0 15 30

