

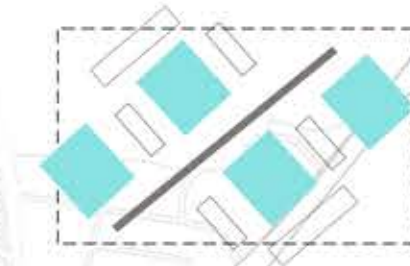

CATEGORIZING DIFFERENT TYPE OF VEGETATION

I LOW VEGETATION : THEY CAN CONTRIBUTE TO A SENSE OF CHARACTER AND NEW AMENITY THAT SIGNIFICANTLY IMPROVES THE LIVEABILITY OF SUBDIVISIONS.



II HIGH VEGETATION : USING TREES ARE ALSO VERY EFFECTIVE AT PROMOTING LEGIBILITY AND WAY-FINDING .IT CREATES BUFFER OR REFUGE SPACES AND CAN HELP TO SLOW DOWN VEHICLES CLOSE TO PEDESTRIANS BY MAKING THE CARRIAGEWAY APPEAR NARROWER

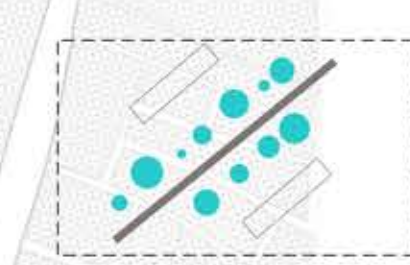

III GARDEN TYPE VEGETATION :CREATING PATTERN THROUGH REPETITION AND CONTINUITY BY USING :

- REPETITION WITH FORM
- REPETITION WITH TEXTURE
- REPETITION WITH COLOR

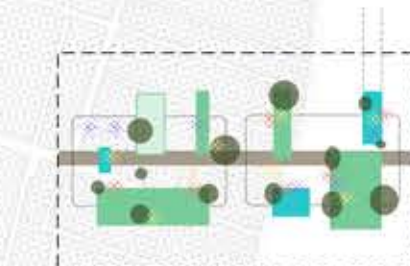

TO CONNECT THE AREA OF THE PROJECT AND THE AGRICULTURAL LAND AROUND THE PROJECT USE ECO-SOURCED NATIVE VEGETATION, (MOHAMMADI FLOWER) IT FITS WITH THE OVERALL LANDSCAPE DESIGN STRATEGY AND HELPS TO CREATE LOW-MAINTENANCE AND SUCCESSFUL PLANTING. THIS WILL LEAD TO THE MOST ECOLOGICALLY APPROPRIATE AND CLIMATE-RESISTANT LANDSCAPING OUTCOME POSSIBLE AS WELL AS CONTRIBUTING TO LOCAL IDENTITY.