

3. Urban Analysis and Problems

Social Analysis

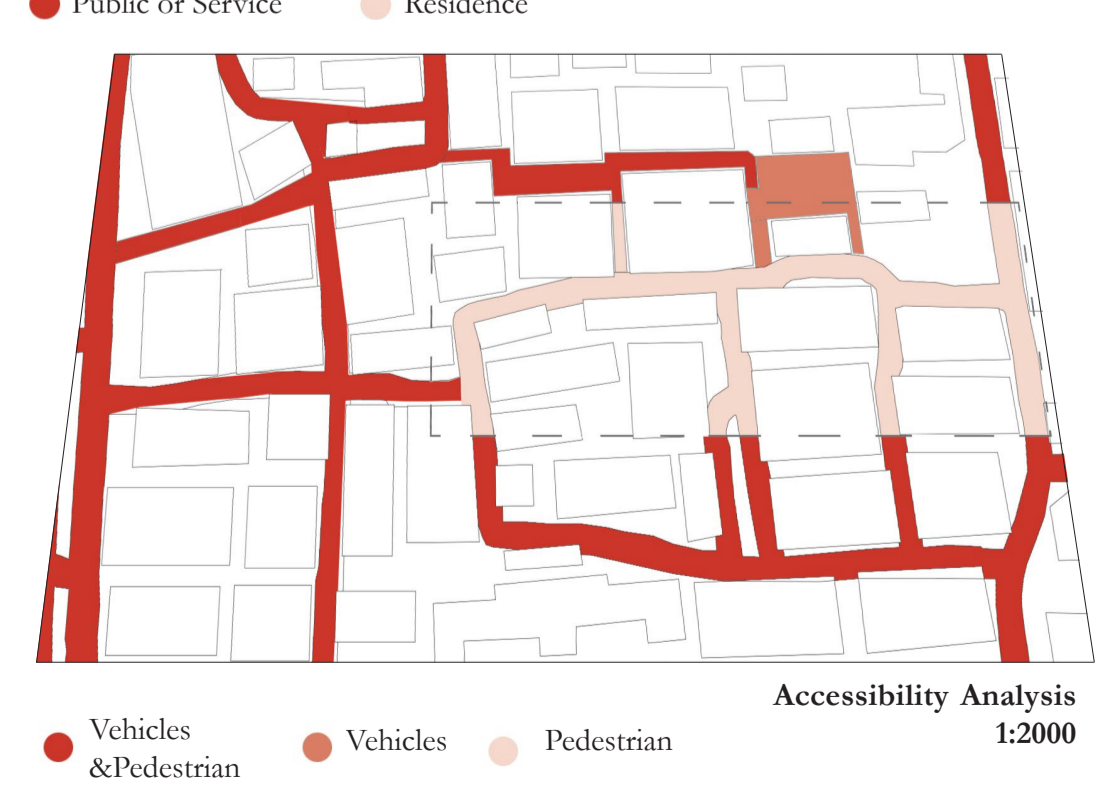
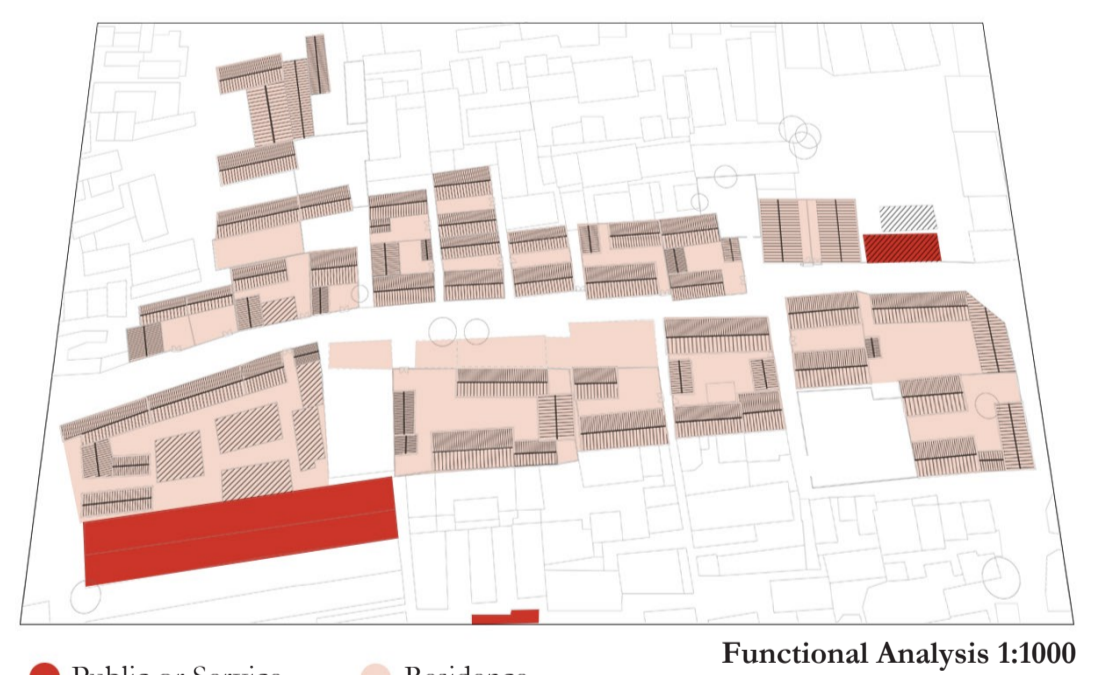
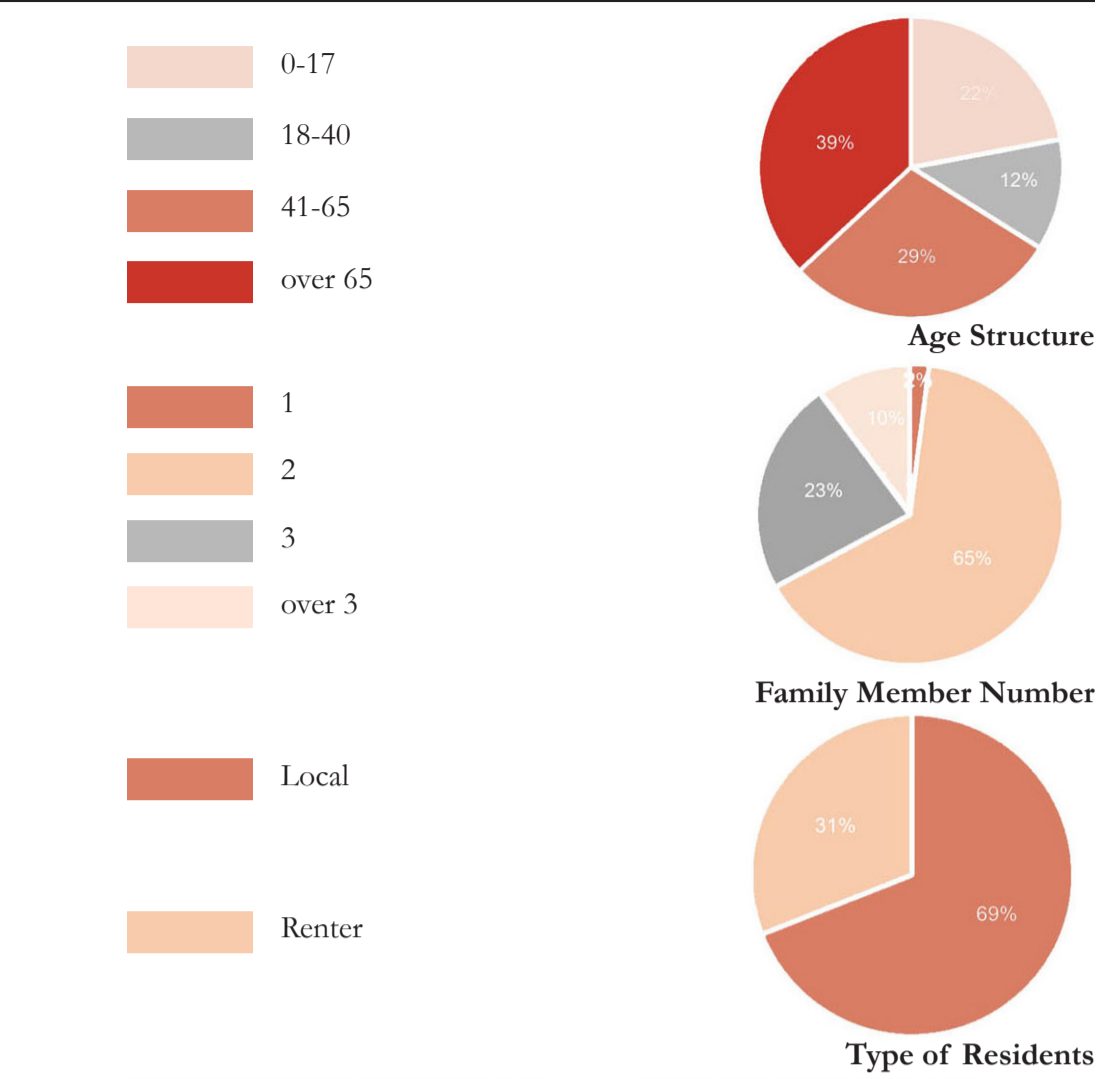

Analysis of Existing Historical Elements

Contrast Between the Old and New



Existing Courtyard Typologies

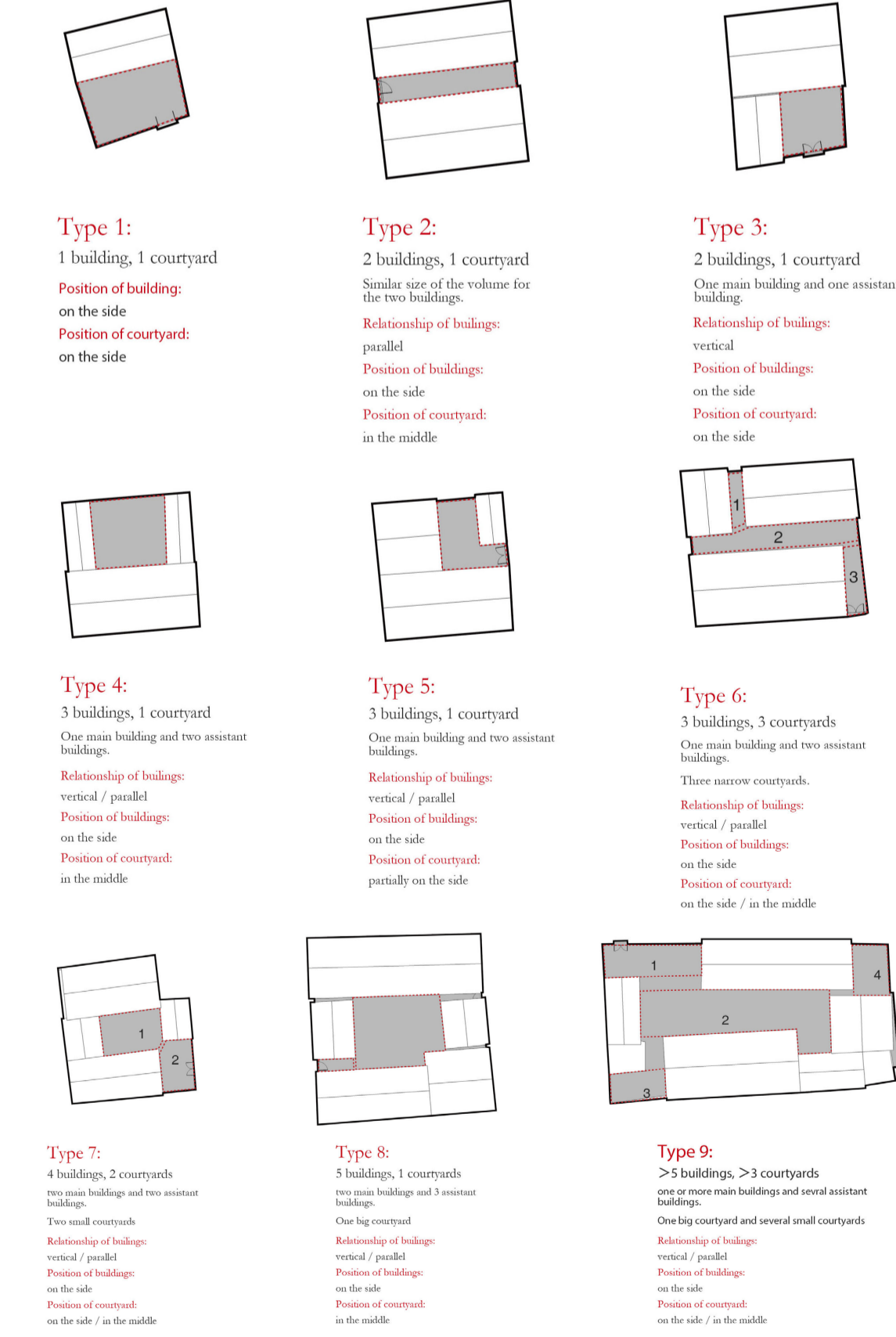

Analysis of Public & Private Areas

Photos

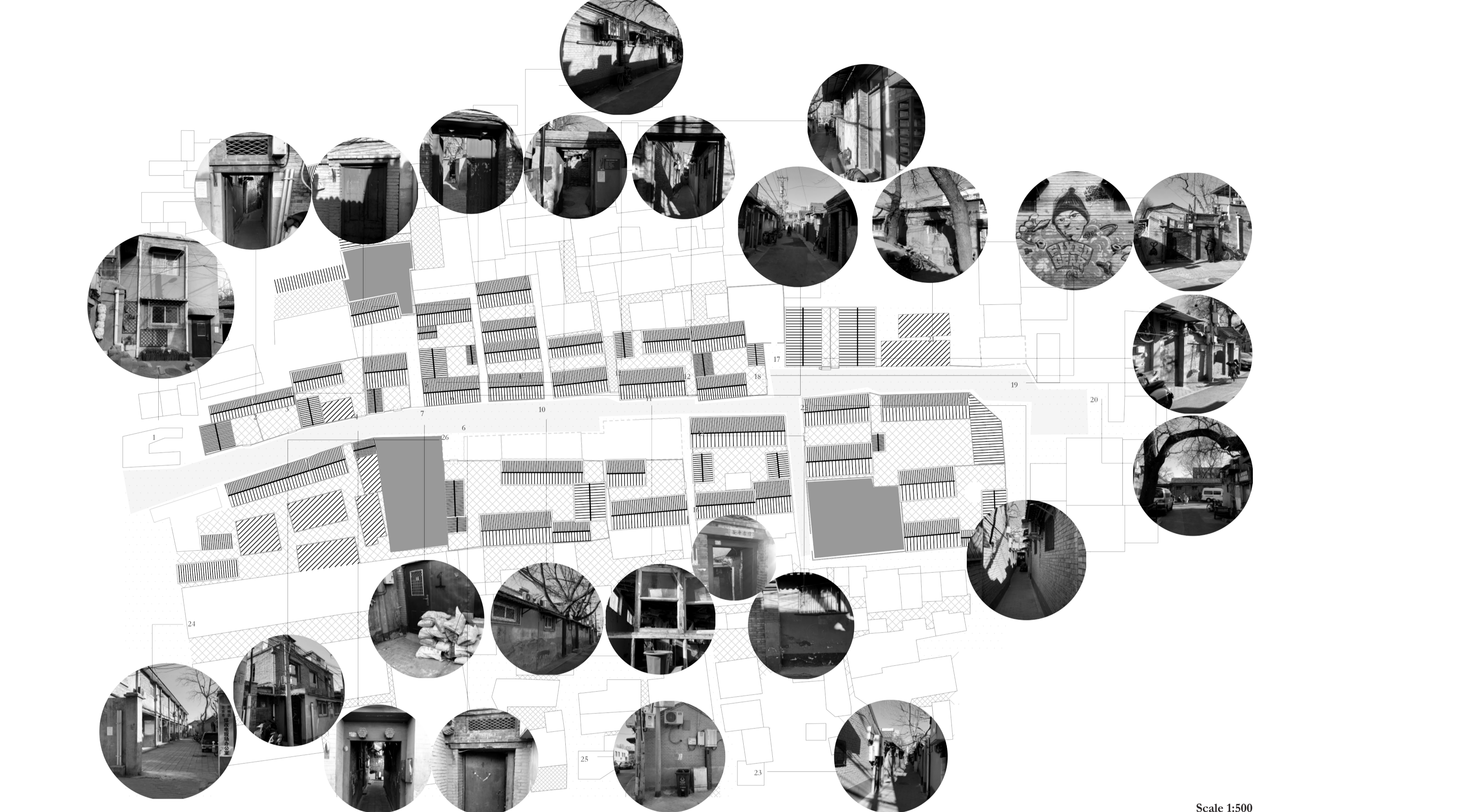

Analysis of Public and Private space and Problems



Problems by analysing the public space:

- Limited dimension of width of alley cause that it is difficult to keep people stop by rather than passing by.
- Disordered traffic situation (vehicles and pedestrian get through in this narrow space).
- Poor sanitary conditions (not organized clean plan, disordered janitors...)

Problems by analysing the private space:

- Lack of communication of each neighborhood with different ages and background of residents.
- Several abandoned houses without an appropriate use or construct.
- Sharing yard with a rent condition without good communication.
- Some illegal construction by the owners cause the view of alley looks a mess and unsafe.
- Residents lack of enthusiasm of becoming a part of community or awareness of the historical value of the area they are living.