

Main calculation - New building		
Comfort	Value	Category
1.1 Daylight:	4.0 %	1.6
1.2 Thermal environment:	Better level	1.6
1.3 Indoor air quality:	≤ 1000 ppm	2.2
Classification		
Energy	Value	Category
2.1 Energy demand:	65.0 kWh/m ²	2.3
2.2 Energy supply:	44.0 kWh/m ²	2.3
2.3 Primary energy:	5.0 kWh/m ²	2.3
Classification		
Environment	Value	Category
3.1 Environmental loads:	Good level	2.3
3.2 Freshwater:	25 % savings	2.5
3.3 Sustainable construction:	Good level	2.3
Classification		

Data from measurements - New building		
Comfort	Value	Category
1.1 Daylight:	0.0 %	-
1.2 Thermal environment:	Out of AH category	-
1.3 Indoor air quality:	> 1200 ppm	-
Classification		
Energy	Value	Category
2.1 Energy demand:	0.0 kWh/m ²	-
2.2 Energy supply:	0.0 kWh/m ²	-
2.3 Primary energy:	0.0 kWh/m ²	-
Classification		
Environment	Value	Category
3.1 Environmental loads:	Lowest level	-
3.2 Freshwater:	0 % savings	-
3.3 Sustainable construction:	Lowest level	-
Classification		

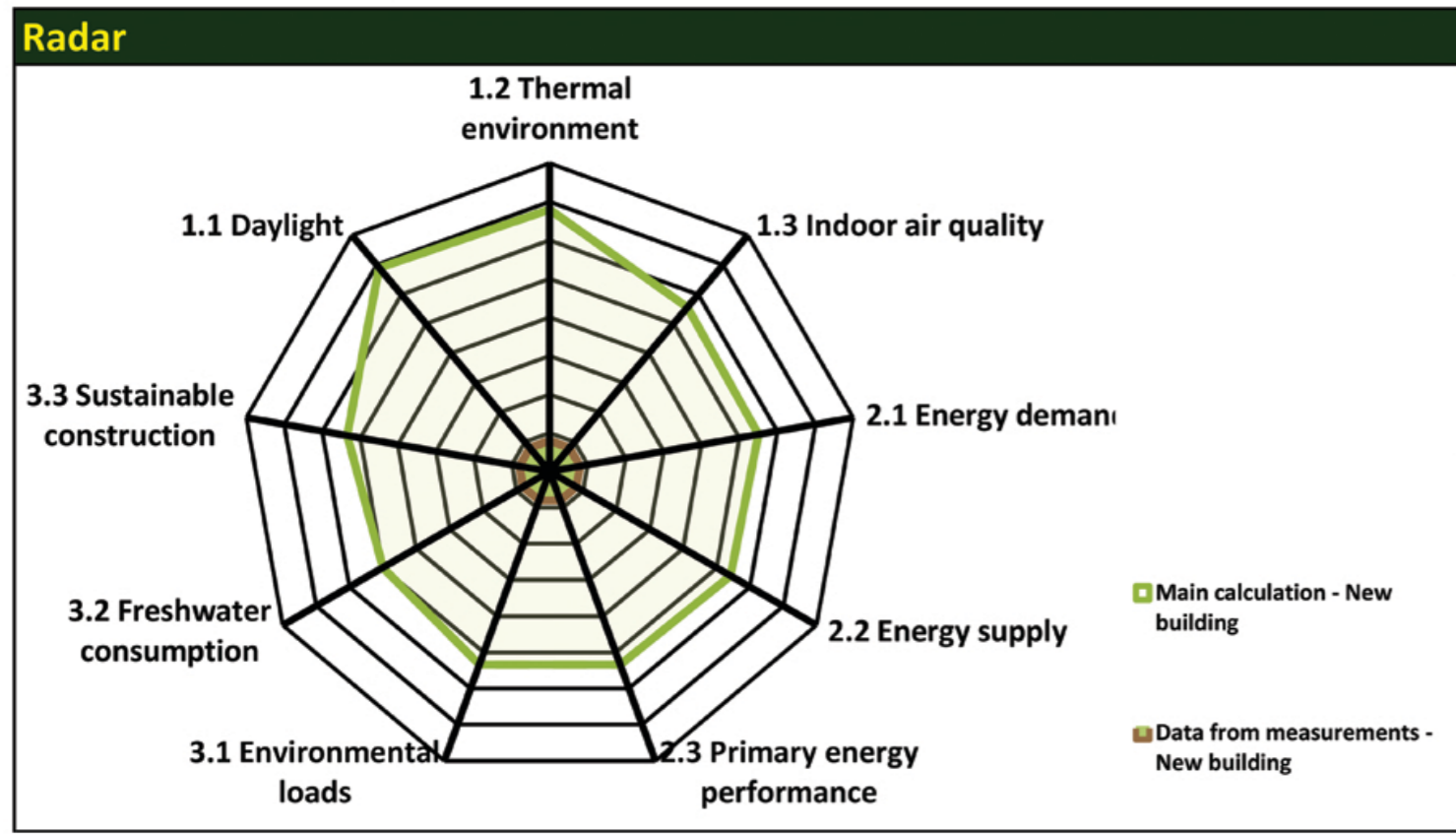

Y ? N	Credit	1	1	BIM App	Y ? N	1	1	1
14	0	1	16	3	2	1	1	1
Location and Transportation								
1	Credit	LEED for Neighborhood Development Location	16	1	1	1	1	1
1	Credit	Sensitive Land Protection	1	1	1	1	1	1
2	Credit	High Priority Site	2	1	1	1	1	1
4	1	Credit	Surrounding Density and Diverse Uses	5	1	1	1	1
3	Credit	Access to Quality Transit	5	1	1	1	1	1
1	Credit	Bicycle Facilities	1	1	1	1	1	1
1	Credit	Reduced Parking Footprint	1	1	1	1	1	1
1	Credit	Green Vehicles	1	1	1	1	1	1
Sustainable Sites								
4	0	2	10	6	0	0	0	0
1	Prereq	Construction Activity Pollution Prevention	Required	Y	1	1	1	1
1	Credit	Site Assessment	1	1	1	1	1	1
1	Credit	Site Development - Protect or Restore Habitat	2	1	1	1	1	1
1	Credit	Open Space	1	1	1	1	1	1
1	Credit	Rainwater Management	3	1	1	1	1	1
1	Credit	Heat Island Reduction	2	1	1	1	1	1
1	Credit	Light Pollution Reduction	1	1	1	1	1	1
Water Efficiency								
7	1	1	11	0	0	0	0	0
Y	Prereq	Outdoor Water Use Reduction	Required	Y	1	1	1	1
Y	Prereq	Indoor Water Use Reduction	Required	Y	1	1	1	1
Y	Prereq	Building-Level Water Metering	Required	Y	1	1	1	1
1	Credit	Outdoor Water Use Reduction	2	1	1	1	1	1
5	1	Credit	Indoor Water Use Reduction	6	1	1	1	1
1	Credit	Cooling Tower Water Use	2	1	1	1	1	1
1	Credit	Water Metering	1	1	1	1	1	1
Energy and Atmosphere								
23	6	2	33	0	0	0	0	0
Y	Prereq	Fundamental Commissioning and Verification	Required	Y	1	1	1	1
Y	Prereq	Minimum Energy Performance	Required	Y	1	1	1	1
Y	Prereq	Building-Level Energy Metering	Required	Y	1	1	1	1
Y	Prereq	Fundamental Refrigerant Management	Required	Y	1	1	1	1
5	1	Credit	Enhanced Commissioning	6	1	1	1	1
12	6	Credit	Optimize Energy Performance	18	1	1	1	1
1	Credit	Advanced Energy Metering	1	1	1	1	1	1
1	Credit	Demand Response	2	1	1	1	1	1
1	2	Credit	Renewable Energy Production	3	1	1	1	1
1	Credit	Enhanced Refrigerant Management	1	1	1	1	1	1
2	Credit	Green Power and Carbon Offsets	2	1	1	1	1	1

Y ? N	Credit	1 <th>1 <th>BIM App</th> <th>Y ? N</th> <th>1 <th>1 <th>1 </th></th></th></th>	1 <th>BIM App</th> <th>Y ? N</th> <th>1 <th>1 <th>1 </th></th></th>	BIM App	Y ? N	1 <th>1 <th>1 </th></th>	1 <th>1 </th>	1
11	0	1	13	5	0	0	0	0
Materials and Resources								
Y	Prereq	Storage and Collection of Recyclables	Required	Y	1	1	1	1
Y	Prereq	Construction and Demolition Waste Management Planning	Required	Y	1	1	1	1
5	Credit	Building Life-Cycle Impact Reduction	5	1	1	1	1	1
2	Credit	Building Product Disclosure and Optimization - Environmental Product Declarations	2	1	1	1	1	1
2	Credit	Building Product Disclosure and Optimization - Sourcing of Raw Materials	2	1	1	1	1	1
2	Credit	Building Product Disclosure and Optimization - Material Ingredients	2	1	1	1	1	1
2	Credit	Construction and Demolition Waste Management	2	1	1	1	1	1
Indoor Environmental Quality								
12	0	1	16	6	3	0	0	0
Y	Prereq	Minimum Indoor Air Quality Performance	Required	Y	1	1	1	1
Y	Prereq	Environmental Tobacco Smoke Control	Required	Y	1	1	1	1
1	Credit	Enhanced Indoor Air Quality Strategies	2	1	1	1	1	1
1	Credit	Low-Emitting Materials	3	1	1	1	1	1
1	Credit	Construction Indoor Air Quality Management Plan	1	1	1	1	1	1
2	Credit	Indoor Air Quality Assessment	2	1	1	1	1	1
1	Credit	Thermal Comfort	1	1	1	1	1	1
2	Credit	Interior Lighting	2	1	1	1	1	1
3	Credit	Daylight	3	1	1	1	1	1
1	Credit	Quality Views	1	1	1	1	1	1
1	Credit	Acoustic Performance	1	1	1	1	1	1
Innovation								
2	0	0	6	0	0	0	0	0
1	Credit	Innovation	5	1	1	1	1	1
1	Credit	LEED Accredited Professional	1	1	1	1	1	1
Regional Priority								
0	4	0	4	0	0	0	0	0
1	Credit	Regional Priority: Specific Credit	1	1	1	1	1	1
1	Credit	Regional Priority: Specific Credit	1	1	1	1	1	1
1	Credit	Regional Priority: Specific Credit	1	1	1	1	1	1
1	Credit	Regional Priority: Specific Credit	1	1	1	1	1	1

73 11 8 TOTALS Possible Points: 110
Certified: 40 to 49 points, Silver: 50 to 59 points, Gold: 60 to 79 points, Platinum: 80 to 110

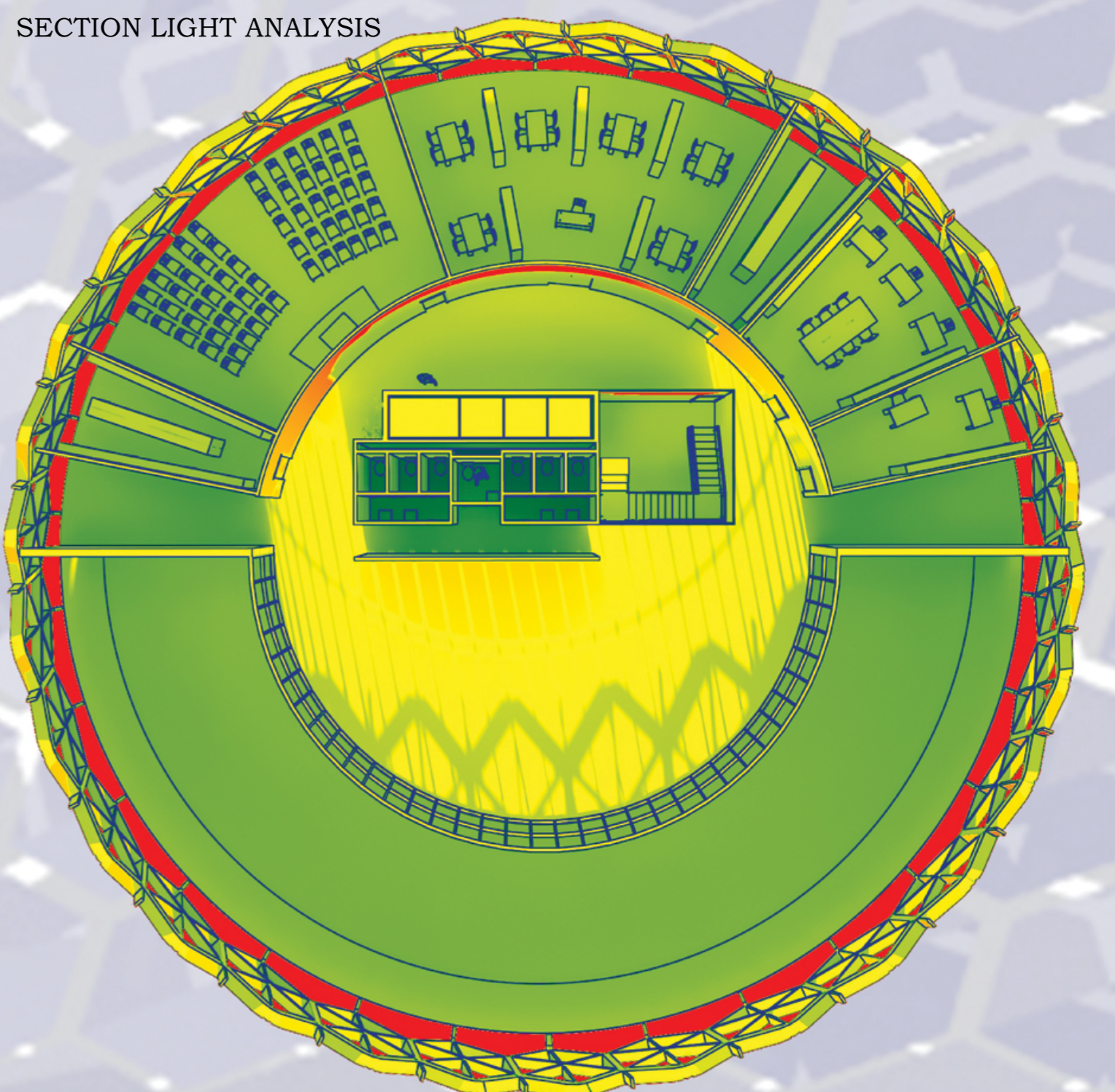
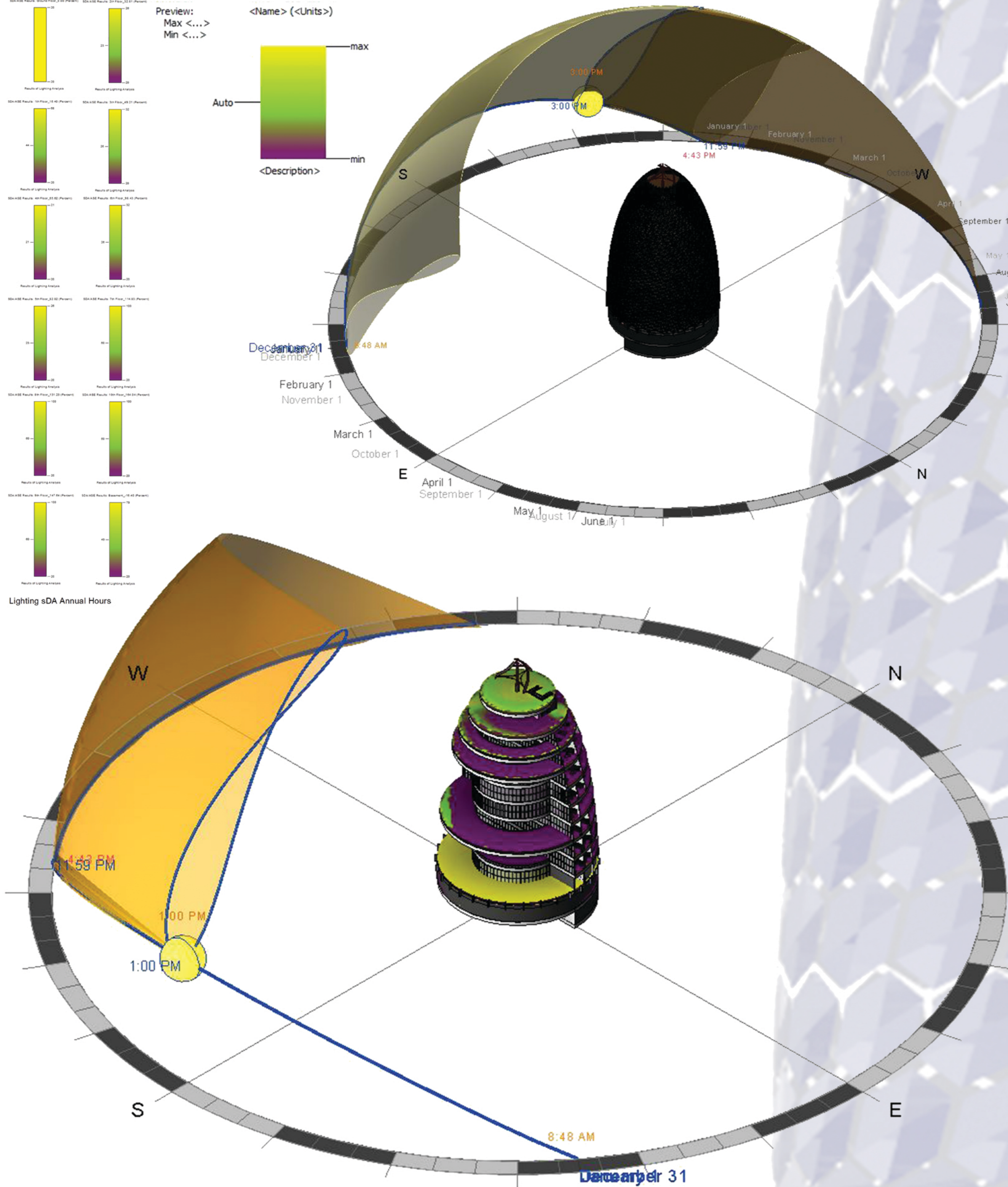
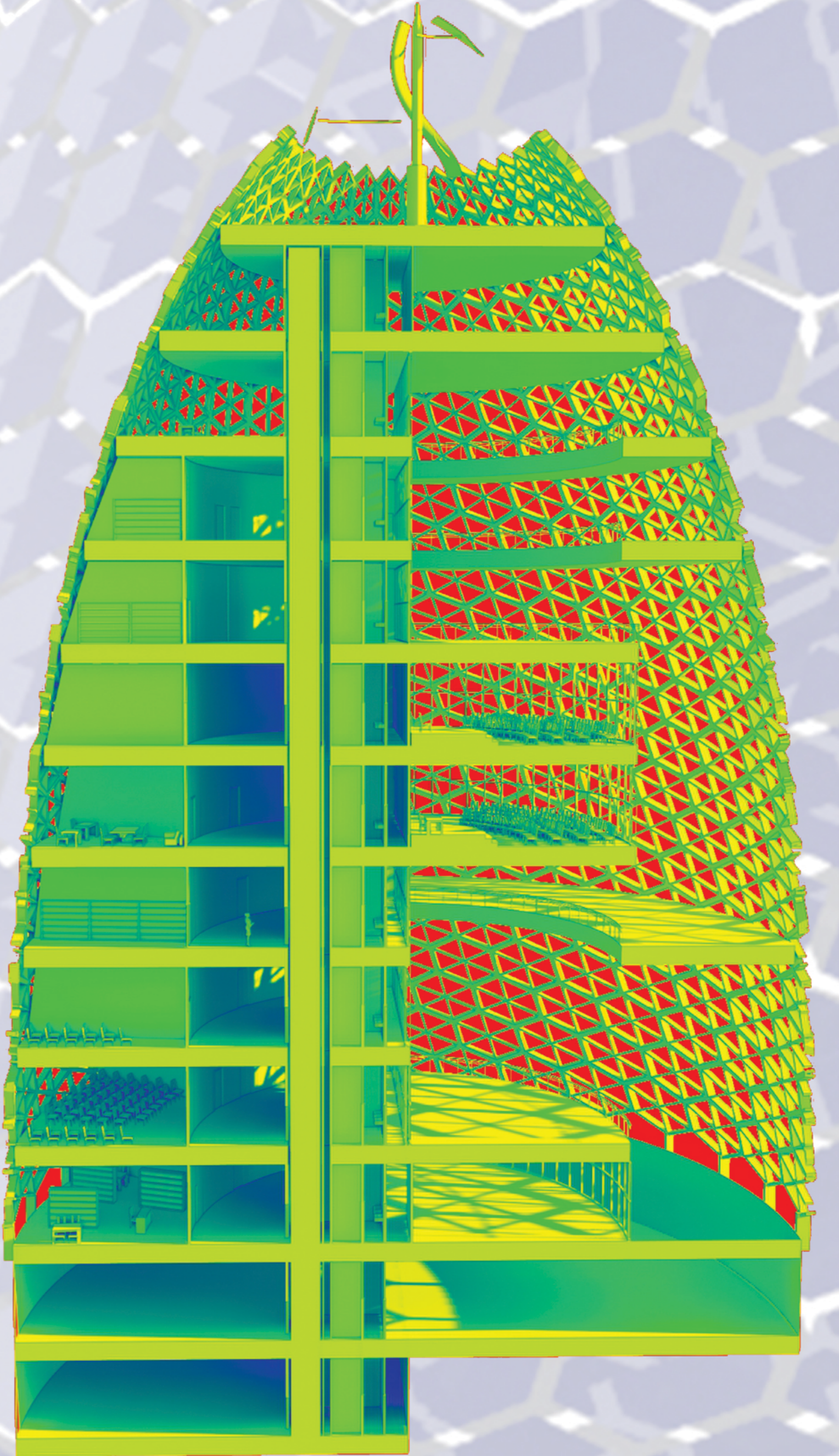
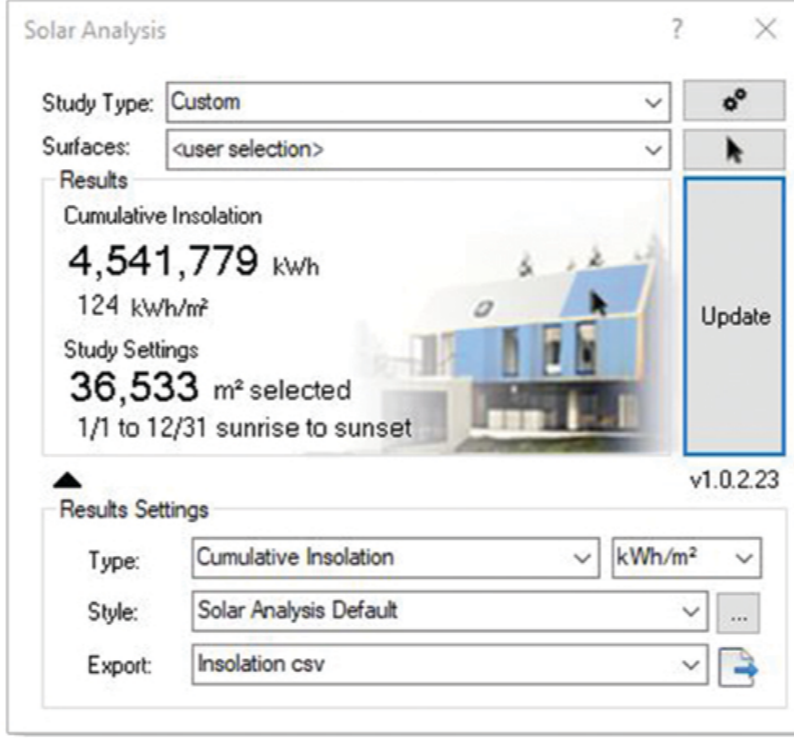

LIGHT ANALYSIS IN REVIT (INSIGHT PLUGIN)

PLAN LIGHT ANALYSIS