

SPHENDONE WALL AS BUILT

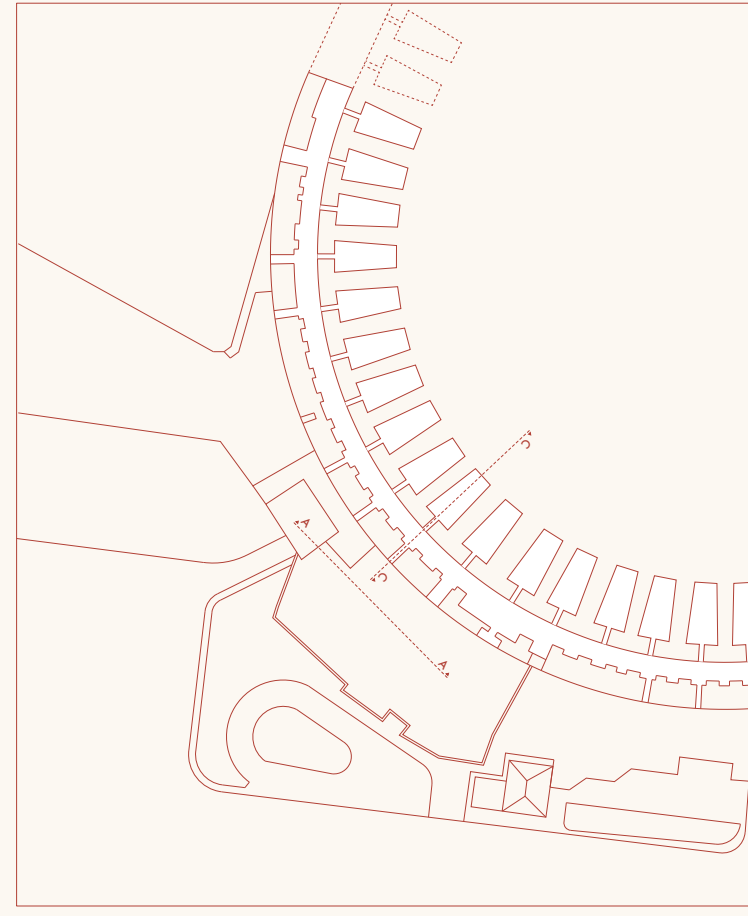

Sphendone wall is the part of the hippodrome which draws the u shape and defines the end of the racecourse. This semicircular space had passages that led to the grandstands under, and the spectators who were sitting to watch the games, shows and races on top. It was turned into a water reservoir in the fifth century to supply city's water need by changing its structure : closing off the arched doors which open to the inner area and coating the inner surfaces.

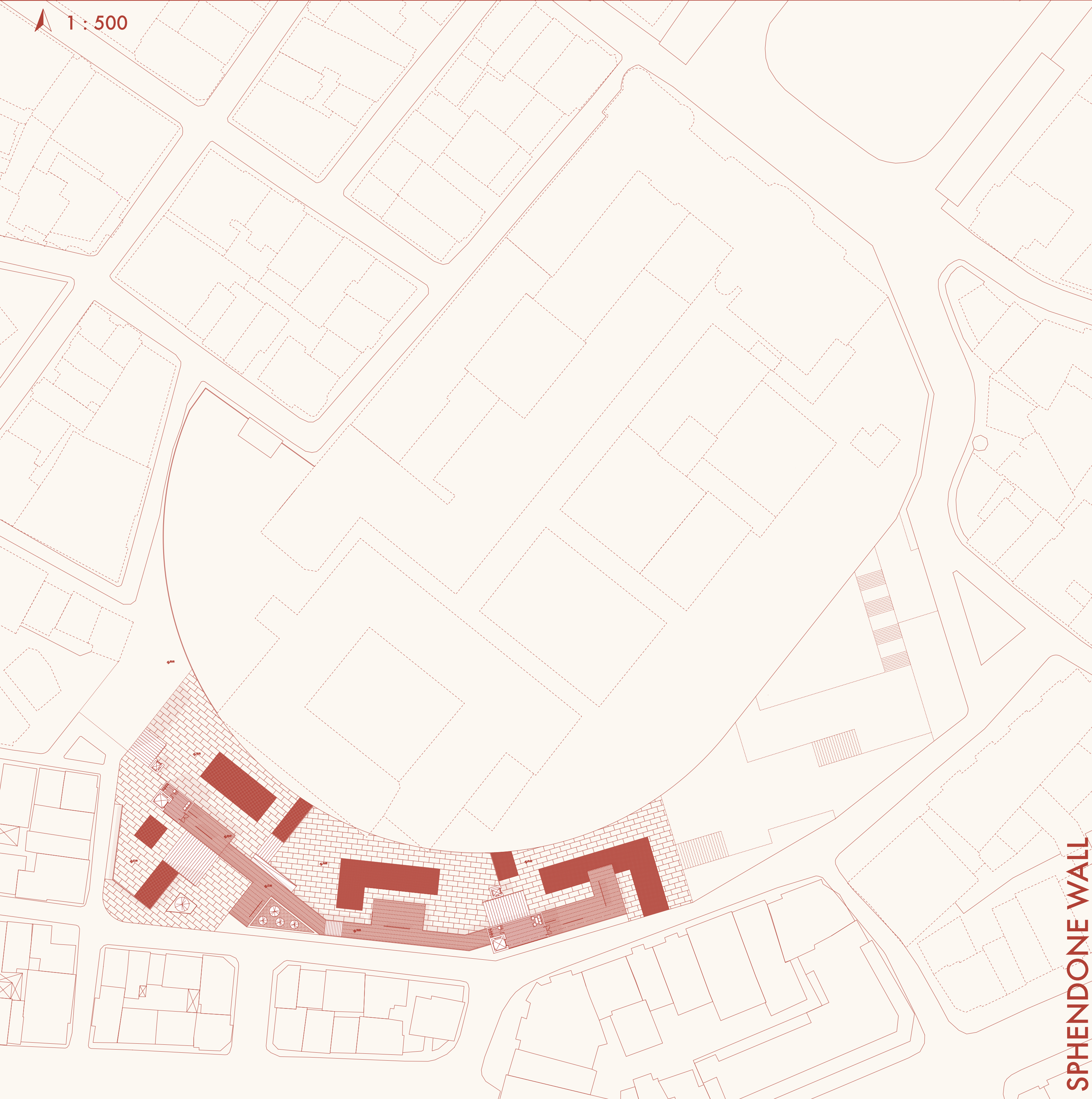
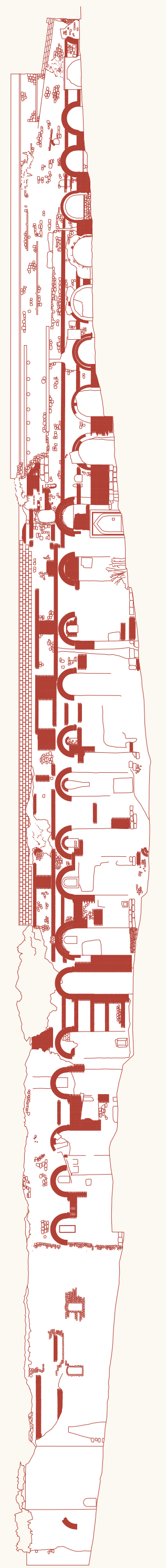
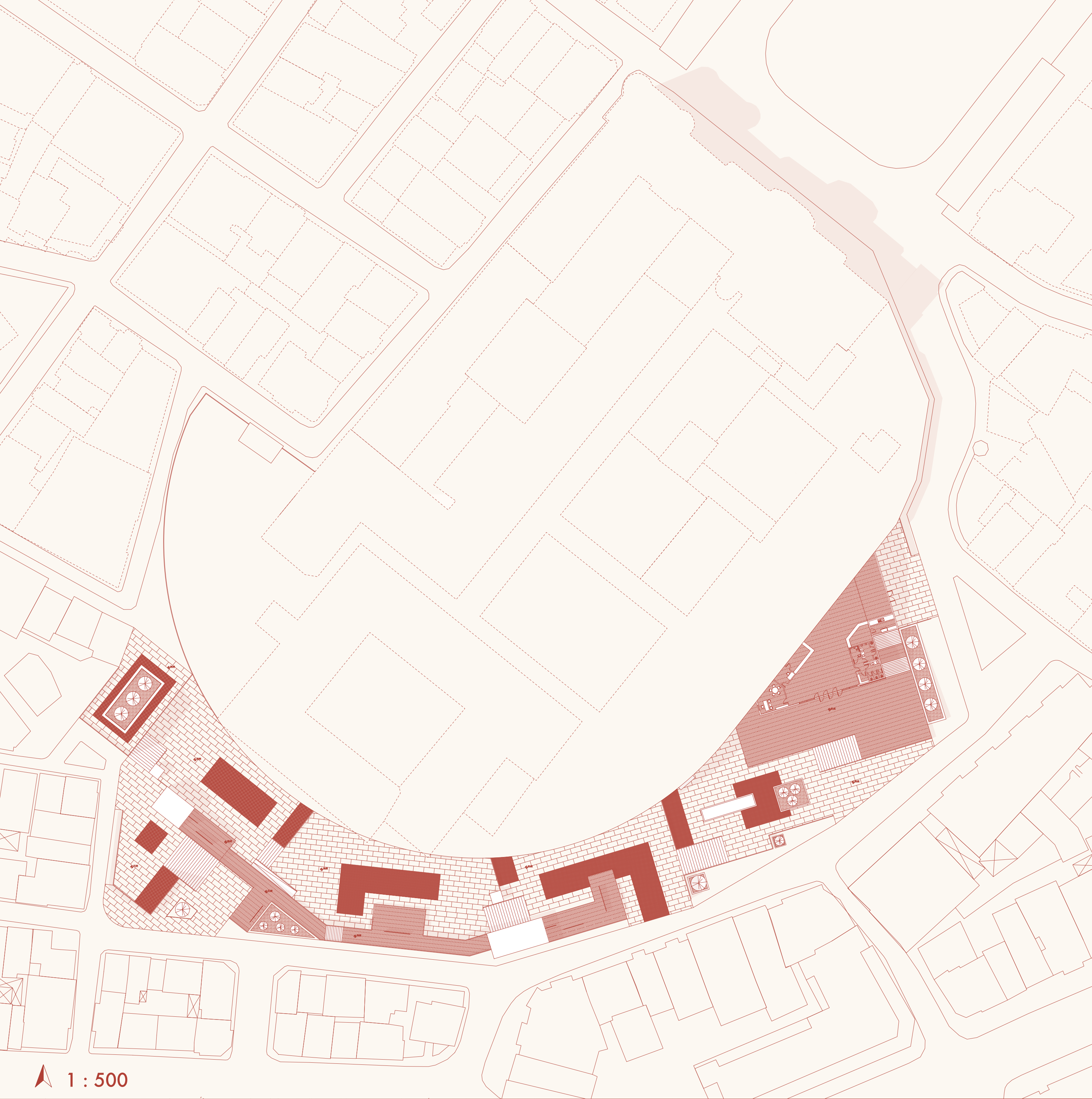

SPHENDONE WALL

Sphendone wall is located at the end of the Sultanahmet Square. The altitude of the terrain descends through the center of the wall. Buildings encircling the wall are mostly hotels or residential buildings.

There is a restaurant, parking lot and a playground placed in front of the wall. There is no place which gives the opportunity to connect with the ancient remain. Usually people who come to Sultanahmet Square leave the square without even noticing the existence of this heritage. On the top of the Sphendone Wall, there is a high school with one part dedicated to a museum and a rectorship building. Except the little part dedicated to the museum, it is a private place where there is no access for citizens even though it has a wonderful panorama of the city.