

## IX. PROJECT

Concept: Becomes a piece of Puzzle

### Block model

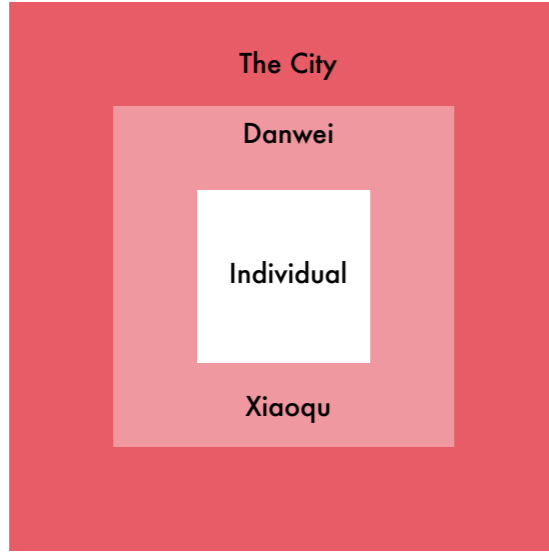

Beijing's managed from the top down, allowing the city to be managed one block at a time, independently of the other. Such a model leaves each "danwei" and "Xiaoqu" unrelated to each other and individual feeling disconnected to the Danwei or Xiaoqu.

### Puzzle model

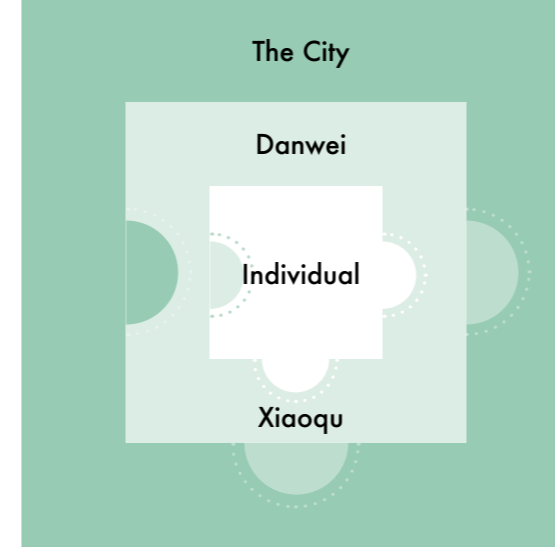

In the concept of jigsaw puzzle, "danwei" and "Xiaoqu" are not separate blocks, these are interrelated like a jigsaw puzzle. public spaces are used to connect the users, new function could active the potential of public spaces

### Public Spaces as Interlock

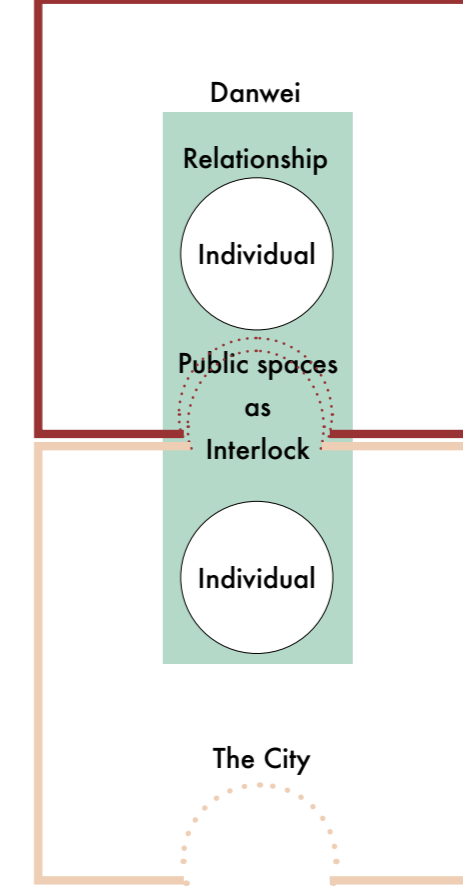

## Concept: Interlock and Mosaic

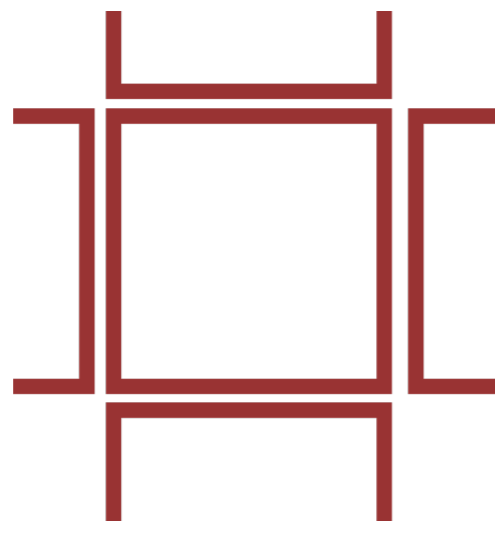

Block

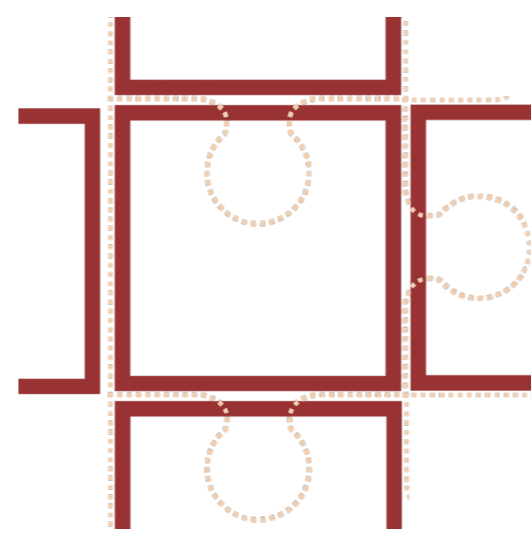

Puzzle

whatever Danwei or Xiaoqu, these blocks isolate with each other, and people live inside almost no contact with neighbourhoods. it's all cause by the gated community with walls and gates. puzzle gave me inspiration to give a new possibility to Danwei or Xiaoqu, which like each puzzle has interlock with other puzzles, this could create connection between each blocks, make community lively and transforming the mode of Danwei to more connection way.

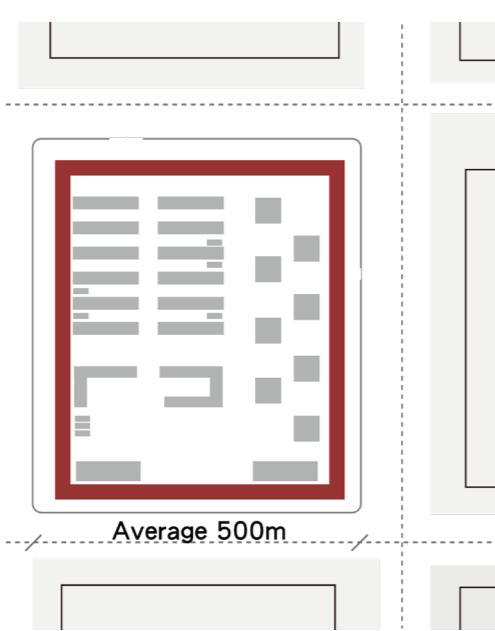

weakness connetion with public streets

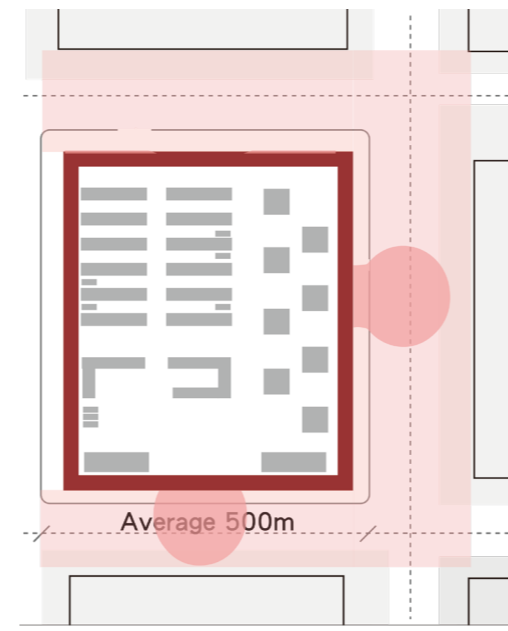

Interlock with public streets

Gated community with walls break connection inside and outside, poor walking experiences on public streets which just could see walls. reduce some walls or create transparency boundaries, could create public space for both residences and pedestrians.

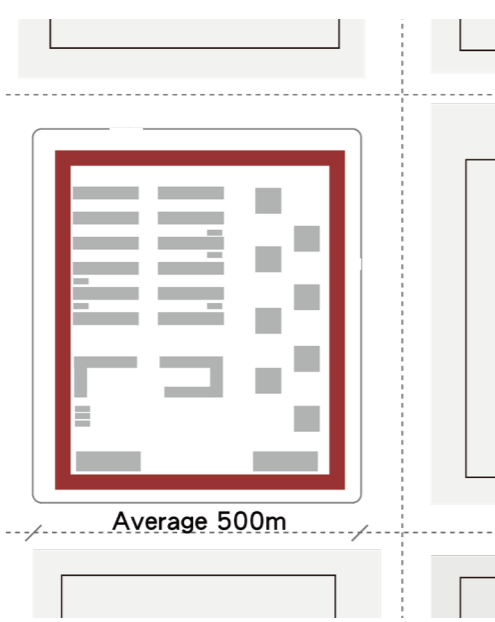

weakness semi-public space

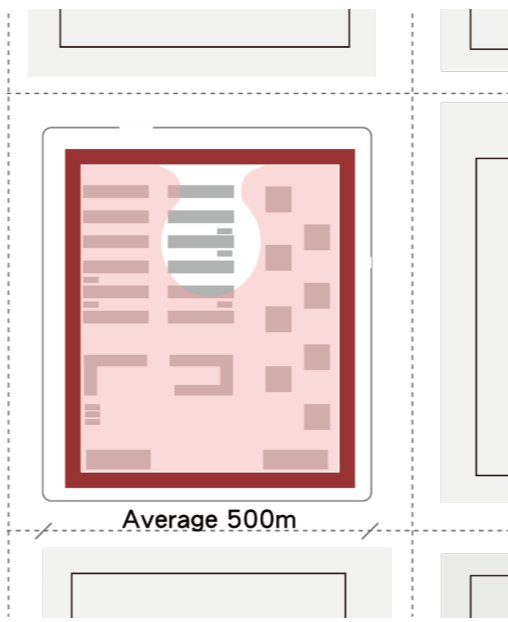

semi-public space mosaice in-between residential housing

Xiaoqu inner semi-public spaces had many problems in order to hard use of these spaces. through landscape strategies could re-organized spaces make it more efficiency and public all residences.

## Concept: Stages of development

