

AUGUST 2021: SURVEY RESULTS

The final drawings are a combined result of a survey that I performed with my colleague Anastasia Cherepenkina back in 2014 during my bachelor degree in Moscow Architectural Institute and an additional trip that I took to the city of Kamy during summer in 2021, where I took additional photos and made sketches to register any new signs of decay. The overall state of the ruin remained the same, but I had to take notice of the growth of trees and other uncontrolled vegetation.

I chose the hand drawing to represent the current state of the building for a number of reasons. For once, I did not have access to a professional camera or other means to perform photogrammetric survey. So in order to understand the structure and character of the building I used the data acquired during the manual survey in 2014 and used numerous photos to locate and emphasize important details and types of damage.

While this method of representation lacks the precision of a photogrammetric survey, it gives an opportunity to closely observe every detail of the structure before achieving a complete picture.

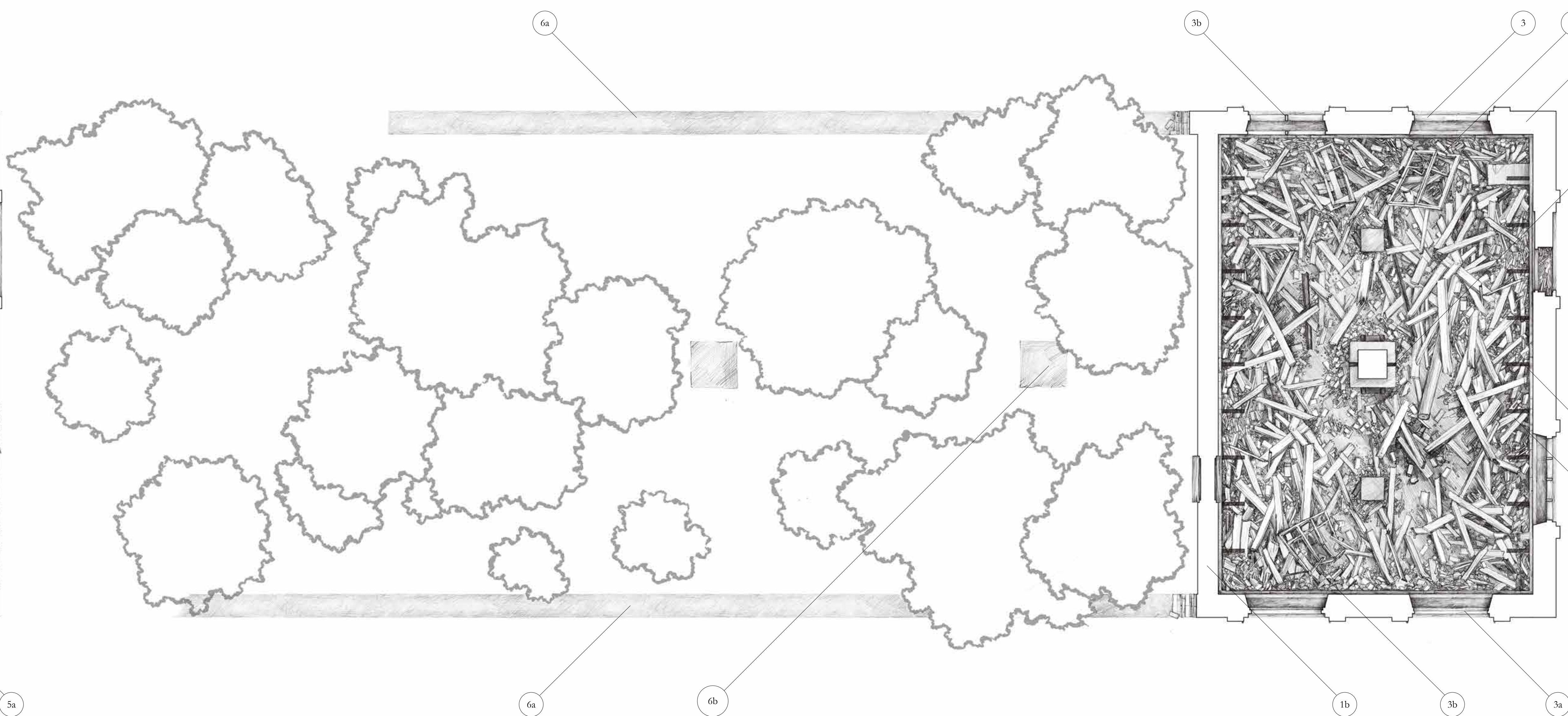
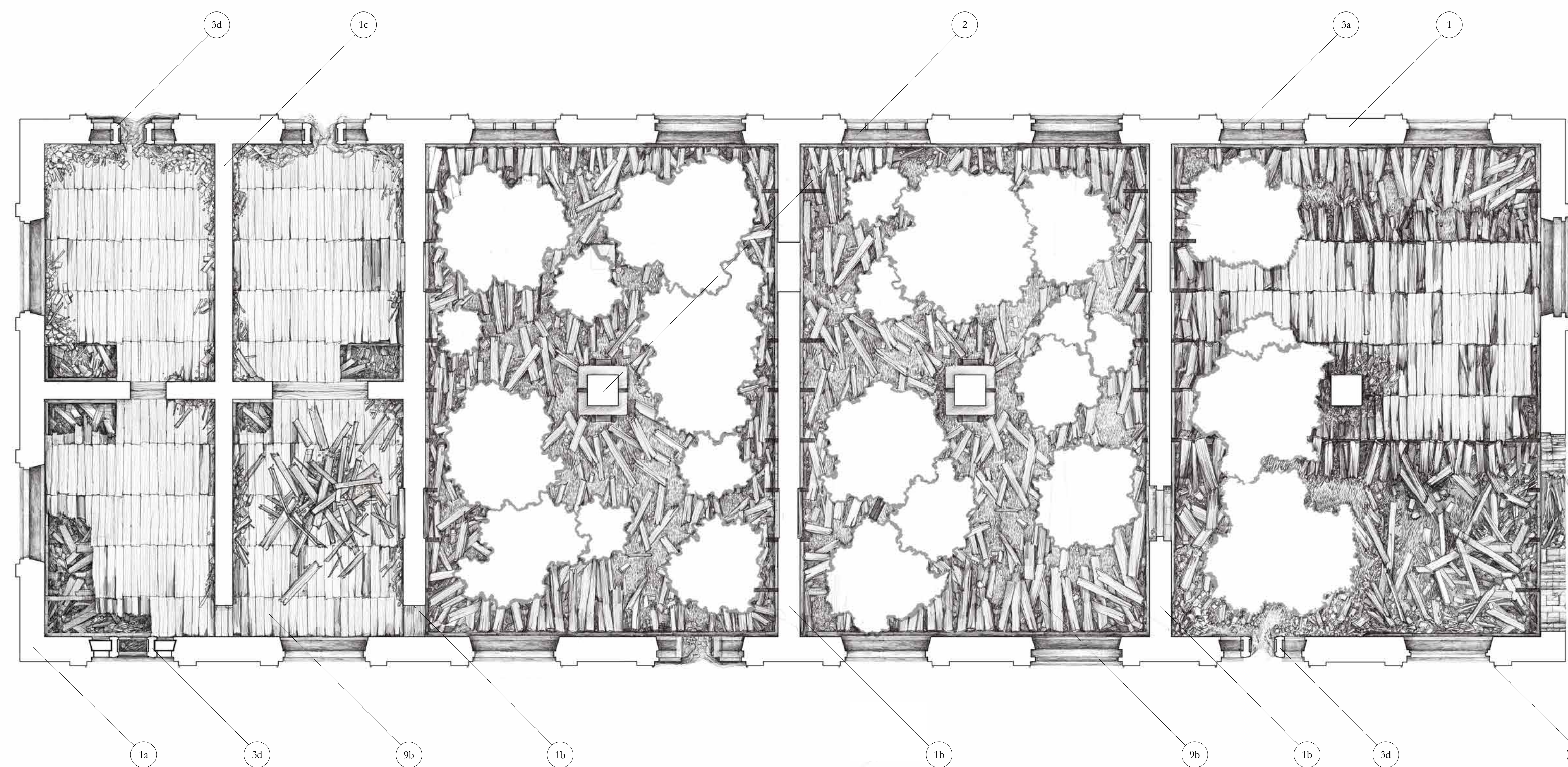

- ELEMENTS OF THE BUILDING**
- | VERTICAL ELEMENTS | HORIZONTAL ELEMENTS |
|-------------------------------------|--------------------------------|
| 1/ Wall | 6/ Foundation |
| 1a/ External loadbearing wall | 6a/ Strip foundation |
| 1b/ Internal loadbearing wall | 6b/ Pillar foundation |
| 1c/ Partition | 7/ Pedestal |
| 1d/ Lime stone strengthening | 8/ Perimeter path |
| 2/ Pillar | 9/ Basement floor |
| 3/ Carpentry framework | 9a/ Structural double-T beams |
| 3a/ Ground floor window | 9b/ Wooden floor covering |
| 3b/ First floor window | 10/ Inserted floor |
| 3c/ Skilight window | 10a/ Structural double-T beams |
| 3d/ Door | 10b/ Wooden floor covering |
| 4/ Pipe drainage system | 11/ Attic floor |
| 5/ Fixtures | 11a/ Structural double-T beams |
| 5a/ Metal door hinges | 11b/ Masonry vaults |
| 5b/ Metal shutter hinges | 12/ Roof |
| 5c/ Inserted wall metal connections | 12a/ Bed timber |
| | 12b/ Rafter |
| | 12c/ Metal sheet covering |

