

RED FRAGMENTS: A new dialogue between interiors and exteriors of Santi Cosma and Damiano former convent

Artist-in-residence at Bevilacqua La Masa Foundation in Giudecca island, Venice

Two Adjacent Grids of The Site

The former Convent of Santi Cosma and Damiano, as we can see from the birdview, represents a unique typological feature comparing to the surroundings. By combining the two adjacent grids together and inserting the grid of the surroundings into the convent, traces of the site can be subtly revealed, which can raise the visitors' awareness of the presence of the external urban space within the convent in a fresh way.

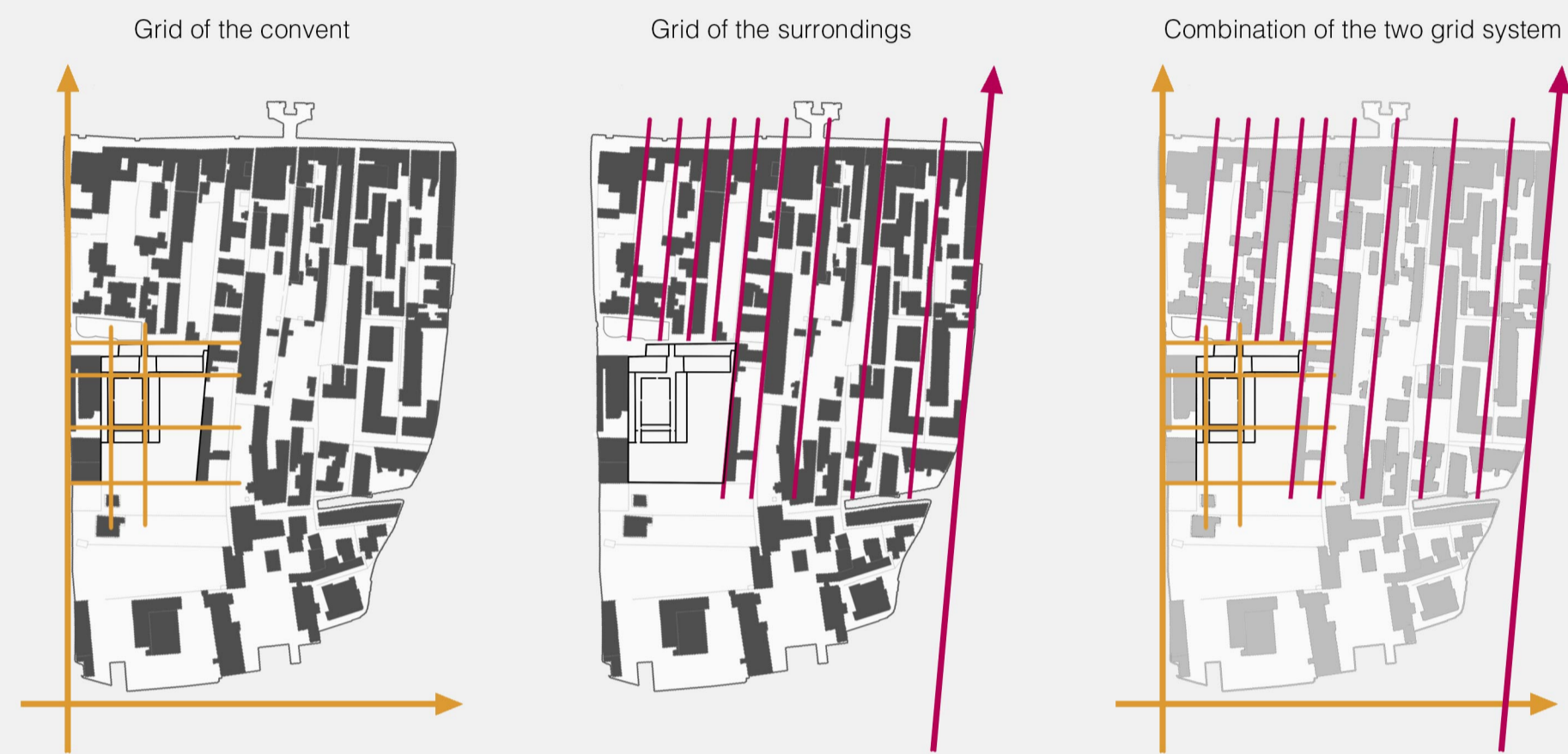

Integration of The Two Grids

1. Compose the two grids on top of one another

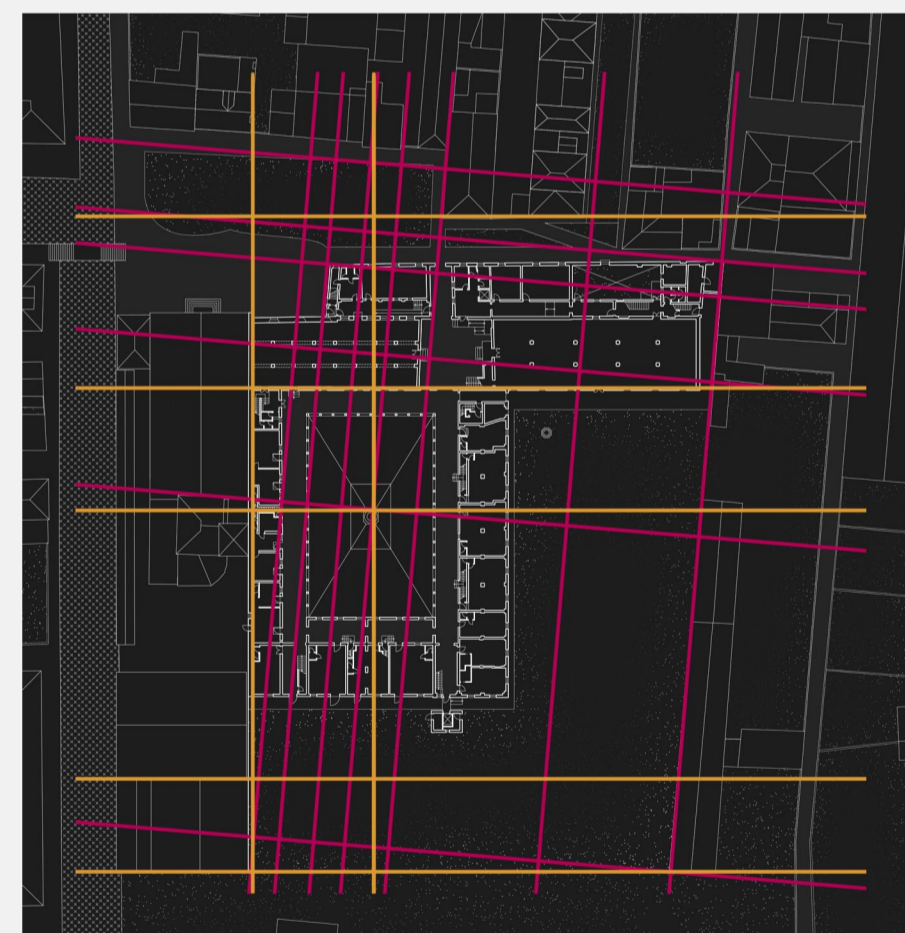

2. Use the grid to define the boundary of the intervention

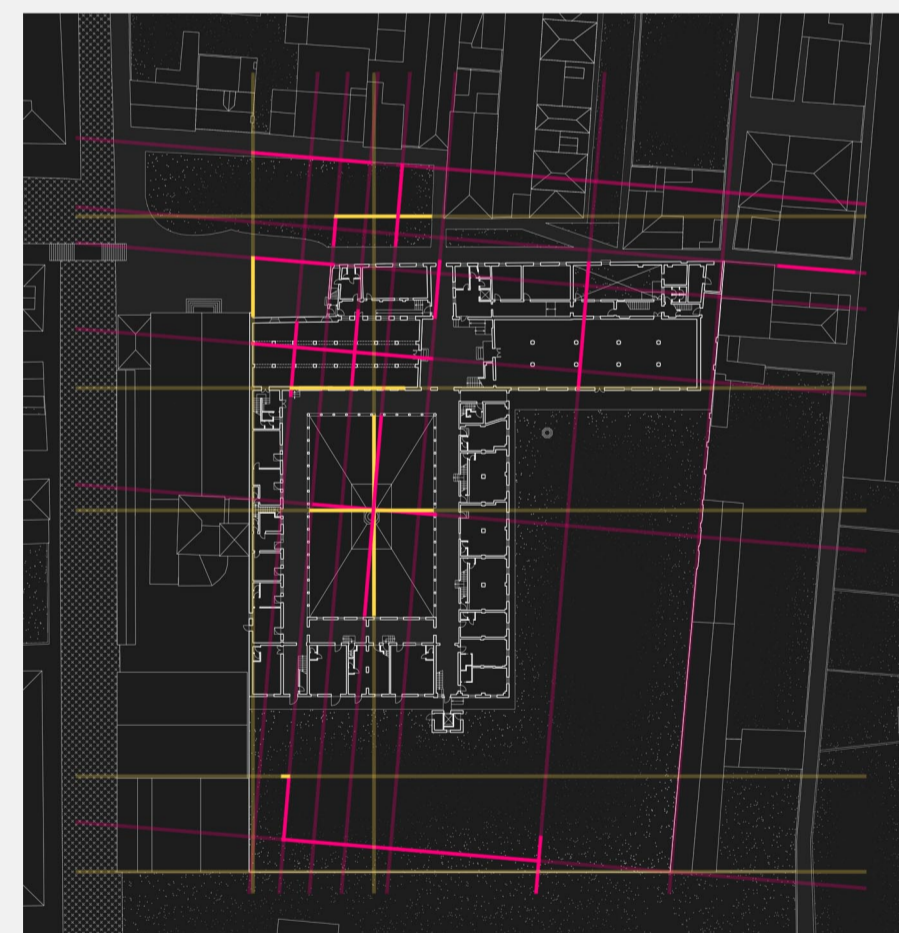

3. Insert the new elements (point, line, plane) to generate event sites, traces, views and other possible connections based on the boundaries

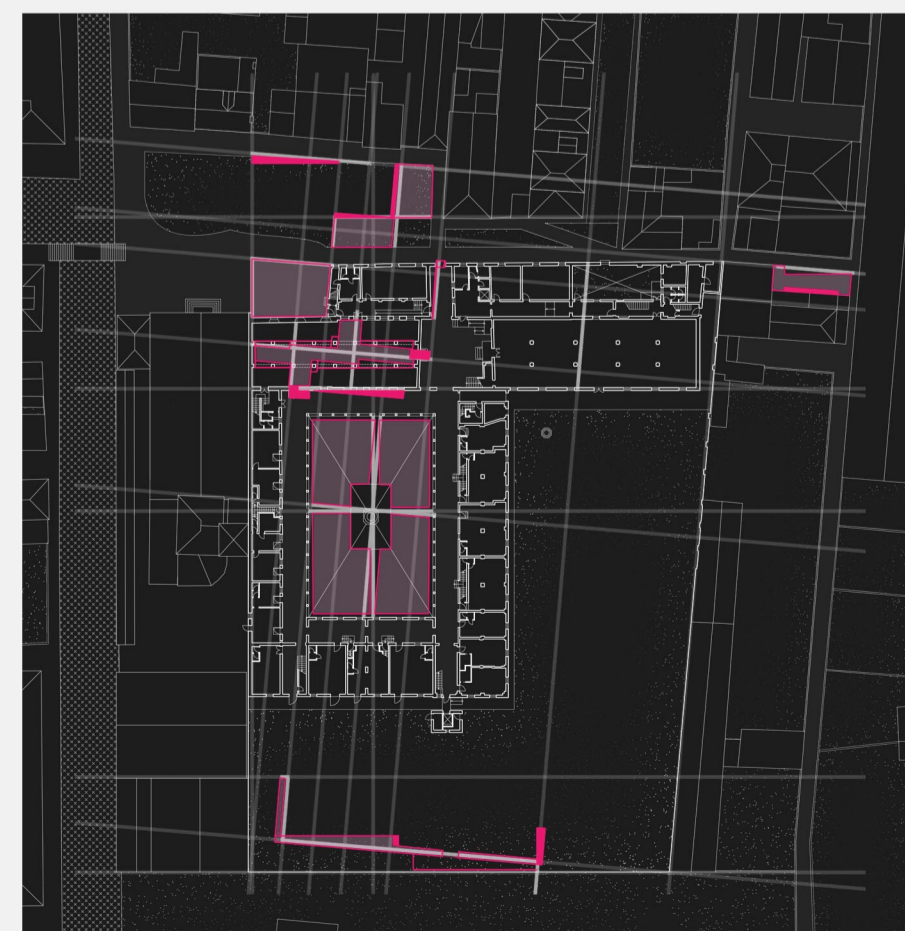

Ground Floor



First Floor

Axonometric View of The Site After Intervention

