

RED FRAGMENTS: A new dialogue between interiors and exteriors of Santi Cosma and Damiano former convent

Artist-in-residence at Bevilacqua La Masa Foundation in Giudecca island, Venice

Surroundings of Convento dei Santi Cosma e Damiano

The former Convent of Saints Cosma and Damiano is located in a quite central position on the island of Giudecca. The urban context of the surroundings where the convent is situated reflects vividly the distinctive morphological features of Giudecca Island, as mentioned earlier. The residential blocks in this area are primarily arranged in rows perpendicular to the Fondamenta, exhibiting a more organized structure in the north and becoming less consistent towards the south. To the north, along the Fondamenta the buildings exhibit a compact linear structure predominantly comprising residential areas, while to the south, there is a scattered, fragile and irregular arrangement of abandoned industrial districts. The built-up areas extend up to the boundaries of the second-to-last layer of Giudecca, culminating in a final strip of land facing the lagoon, which remains vacant and undeveloped. A portion of the green space is still cultivated, serving as the only "natural" terrain along the southern bank.

Location of the convent on Giudecca Island

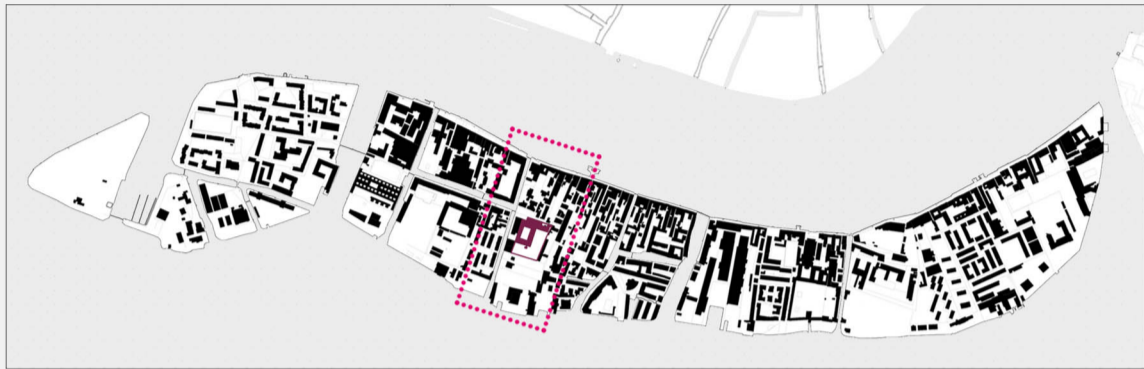

Buildings and enclosure wall system



Legend: Built area (grey), Enclosure wall (red line)

Road system



Legend: Road System (red line)

General Access to Green Spaces

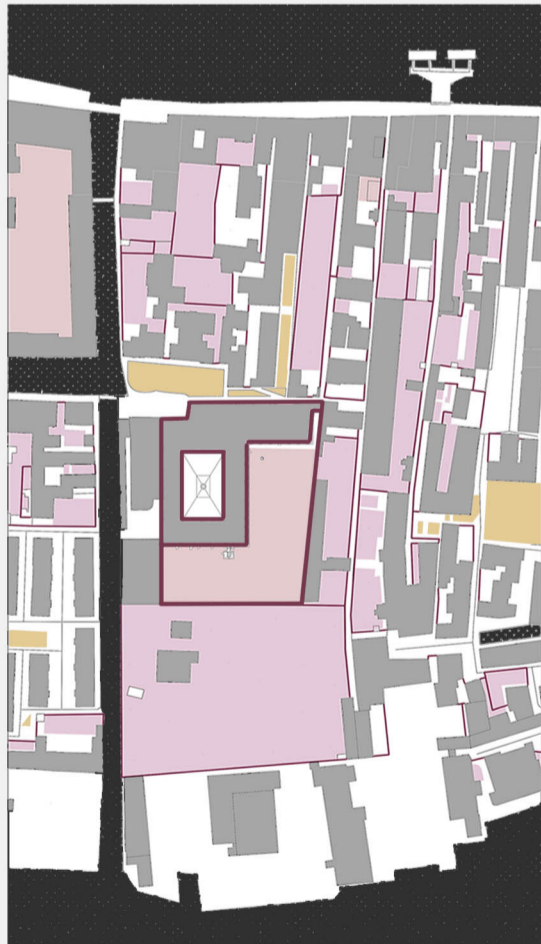

Legend: Full (yellow), Limited (pink), None (light pink)

Building Typologies



Legend: Residential+Commercial (red), Residential (brown), Cultural+Institutional (purple), Religious (blue), Industrial (teal), Others (orange)



Legend: Pattern 1 (cross-hatch), Pattern 2 (diagonal lines), Pattern 3 (grid), Green Space (grey), Road (pink), Wall (red line)

Examples of Three Morphological Patterns

•Pattern 1 : Linear, "Comb-form"

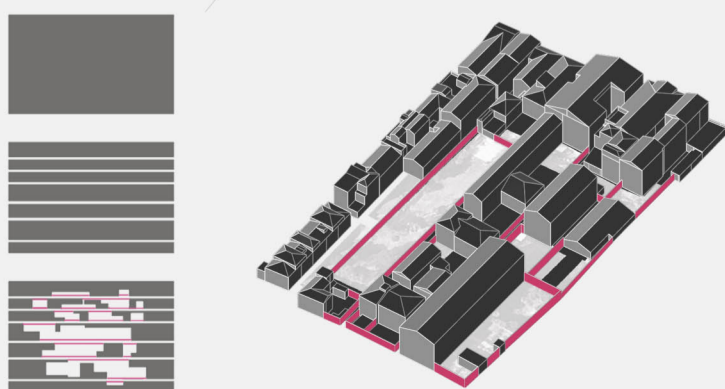

•Pattern 2 : Less dense, green space, enclosed units

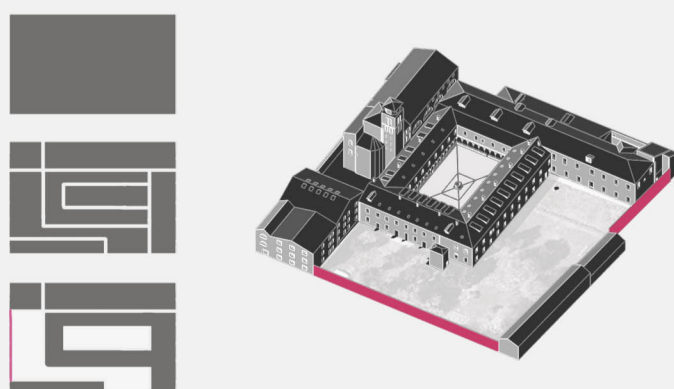

•Pattern 3: Deserted

