

THE TAMARISKS GARDEN

The tree of sand, of salt, of wind, for a cozy garden in the first coastline

The tamarisks develop very easily along the coasts, but thanks to their rusticity, they can also grow in flat and hilly areas. They are however suitable for areas with a mild climate, marine but also desert, by virtue of their ability to retain sand. Of these, the Gallic type is the most suitable for the construction of windbreak barriers or for the consolidation of the dunes that are carried out along sandy coasts. They like sunny exposures, light loose soil, preferably sandy, tolerating even brackish ones. Tamarisk trees resist drought, wind and cold, and they can also live in saline soils.

The tamarisk garden is precisely the first space you come across following the natural flow of the walkway. The flower beds and the pavement guide the traveler along the path that then reaches the terraces overlooking the sea and the pavilion of the dunes and the pools. This is achieved by crossing basic paths, with the intention of defining, through this simple and immediate intersection, a more intimate and intimate place, immersed in the tamarisk trees, the pilot plant of the project.

Time 1
of the project (low vegetation and shelters)

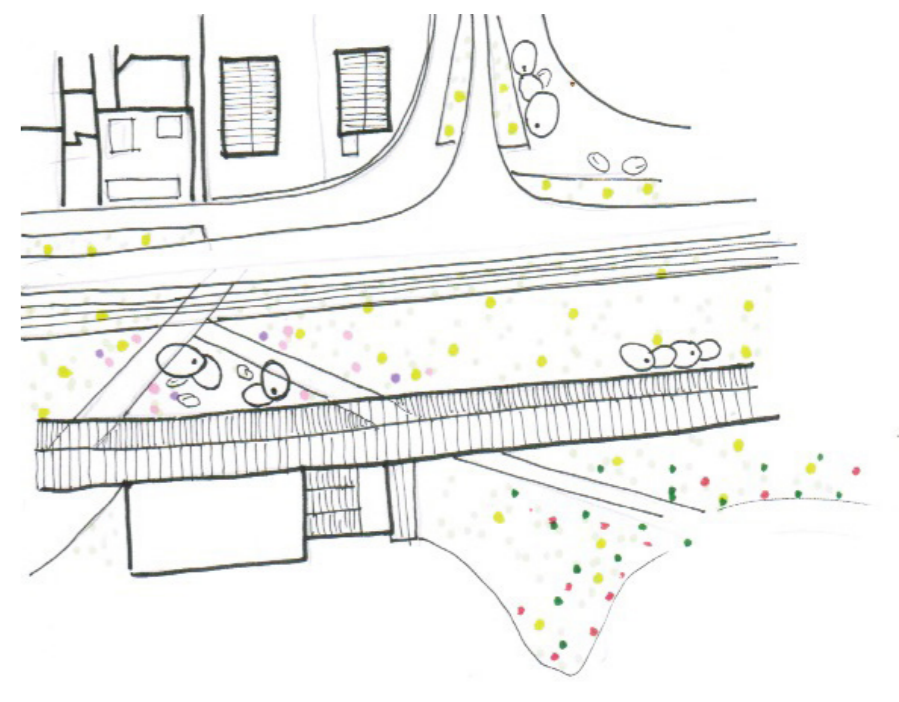

Time 2
of the project (complete vegetation growth)

